

MATERIAL

Glass-fibre reinforced polyamide based (PA) technopolymer, grey-black colour, matte finish.

SCREW-COVERS

Technopolymer in Ergostyle colours, glossy finish; supplied with the handle, press-fit assembly, removable by a screwdriver.

Available also as accessories sold separately (see table ECA.).

Code	Description	Cap for
29830-*	ECA.B0-*	EBP.110
29831-*	ECA.B1-*	EBP.140 EBP.150 EBP.180 EBP.200

* Complete with colour index (C1, ..., C17).

STANDARD EXECUTION

Brass bosses, threaded blind holes.

TECHNICAL DATA

Tensile stress and impact strength: F1, F2, L1 and L2 values reported in the table are the result of breaking tests carried out with the appropriate dynamometric equipment under the test conditions shown in the figure with ambient temperature.

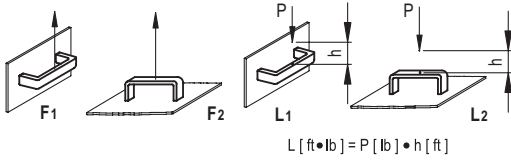

ERGOSTYLE® ELESA Original design

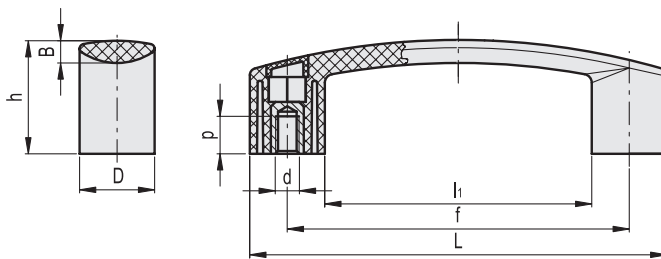

* Complete with colour index, example: 90260121-C2 EBP.110 B-1/4-20-C2

- C1**
RAL7021
- C2**
RAL2004
- C3**
RAL7035
- C4**
RAL1021
- C5**
RAL5024
- C6**
RAL3000
- C17**
RAL6017

INCH

Code	Description	L	f	d2B	D	h	B	li	p	F1 [lbf]	F2 [lbf]	L1 [ft lb]	L2 [ft lb]	⚖️
90260121-*	EBP.110 B-1/4-20-*	4.57	3.68±0.02	1/4-20	0.87	1.38	0.3	2.83	0.47	448	336	6	2	0.1
90260221-*	EBP.140 B-5/16-18-*	5.67	4.61±0.02	5/16-18	1.02	1.54	0.33	3.62	0.51	605	403	7	3	0.14
90260256-*	EBP.150 B-5/16-18-*	6.26	5.2±0.02	5/16-18	1.06	1.65	0.37	4.13	0.51	605	403	8	3	0.18
90260321-*	EBP.180 B-5/16-18-*	7.01	5.91±0.04	5/16-18	1.1	1.77	0.37	4.8	0.51	605	336	9	4	0.22
90260421-*	EBP.200 B-5/16-18-*	8.21	7.05±0.04	5/16-18	1.12	2.01	0.37	5.93	0.51	493	336	12	7	0.24

