

- 1
- 2
- 3
- 4
- 5
- 6
- 7
- 8
- 9
- 10
- 11
- 12
- 13
- 14
- 15
- 16
- 17
- 18
- 19

**MATERIAL**

Transparent polyamide based (PA-T) technopolymer. Avoid contact with alcohol or detergents containing alcohol.

**PACKING RING**

NBR synthetic rubber.

**STANDARD EXECUTIONS**

- **HFTX.**: with matte anodised aluminium star-shaped contrast screen with red central level point.
- **HFTX/SL**: without contrast screen.

**MAXIMUM CONTINUOUS WORKING TEMPERATURE**

100°C.

**FEATURES**

The particular shape of the magnifying lens increases and improves visibility even from side positions.

**TECHNICAL DATA**

The tightening torque indicated in the table guarantees an optimal tightness, keeping the packing ring in the correct position.

**NOTE**

For use with other fluids with special additives, please contact ELESA Sales Department.

**ACCESSORIES ON REQUEST**

Brass nut type GH. (see page 1201) for fitting to reservoirs with wall thickness smaller than 5 mm.



ELESA Original design

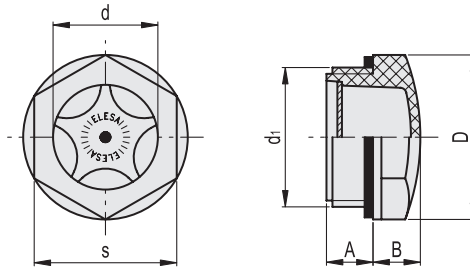

**HFTX.**

Code	Description	d1	A	B	D	d	s	Tightening torque [Nm]	⚖️
13641	HFTX.9-M14x1.5	M14x1.5	10	6	18	9	15	2+3	3
13661	HFTX.11-M16x1.5	M16x1.5	8	7	22	11	19	2+3	3
13675	HFTX.12-M18x1.5	M18x1.5	8.5	8	26	11	22	4+6	6
13681	HFTX.14-M20x1.5	M20x1.5	9.5	8	26	14	22	4+6	5
13695	HFTX.15-M22x1.5	M22x1.5	10.5	9	31.5	14	27	4+6	8
13701	HFTX.18-M25x1.5	M25x1.5	8	9	31.5	18	27	6+8	7
13711	HFTX.19-M27x1.5	M27x1.5	9	9	31.5	20	27	6+8	7
13726	HFTX.21-M26x1.5	M26x1.5	13	9	31.5	18	27	6+8	8
13731	HFTX.22-M30x1.5	M30x1.5	9	10	35	22	30	6+8	8
13751	HFTX.26-M35x1.5	M35x1.5	11	10	40	25	34	8+10	14
13771	HFTX.31-M40x1.5	M40x1.5	11.5	13	47	30	40.5	8+10	23
13651	HFTX.9-1/4	G 1/4	10	6	18	9	15	2+3	3
13671	HFTX.12-3/8	G 3/8	7.5	7	22	11	19	3+5	4
13691	HFTX.15-1/2	G 1/2	10.5	8	26	14	22	4+6	5
13721	HFTX.20-3/4	G 3/4	10.5	9	31.5	20	27	6+8	7
13741	HFTX.24-1	G 1	11	10	40	25	34	8+10	13
13761	HFTX.30-1¼	G1 1/4	11.5	13	47	30	40.5	8+10	23
13781	HFTX.35-1.1/2	G1 1/2	13	13	56	35	48	10+12	30
13791	HFTX.47-2	G2	14	16	67	47	58	10+12	46

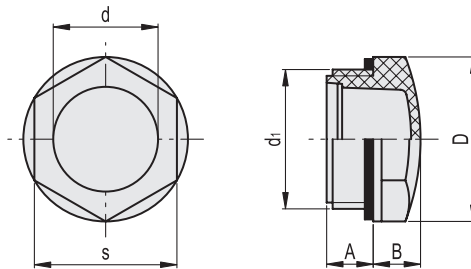

HFTX/SL

Code	Description	d1	A	B	D	d	s	Tightening torque [Nm]	⚖️
13646	HFTX.9/SL-M14x1.5	M14x1.5	10	6	18	9	15	2+3	2
13666	HFTX.11/SL-M16x1.5	M16x1.5	8	7	22	11	19	2+3	3
13678	HFTX.12/SL-M18x1.5	M18x1.5	8.5	8	26	11	22	4+6	5
13686	HFTX.14/SL-M20x1.5	M20x1.5	9.5	8	26	14	22	4+6	5
13698	HFTX.15/SL-M22x1.5	M22x1.5	10.5	9	31.5	14	27	4+6	7
13706	HFTX.18/SL-M25x1.5	M25x1.5	8	9	31.5	18	27	6+8	7
13716	HFTX.19/SL-M27x1.5	M27x1.5	9	9	31.5	20	27	6+8	7
13728	HFTX.21/SL-M26x1.5	M26x1.5	13	9	31.5	18	27	6+8	8
13736	HFTX.22/SL-M30x1.5	M30x1.5	9	10	35	22	30	6+8	8
13756	HFTX.26/SL-M35x1.5	M35x1.5	11	10	40	25	34	8+10	13
13776	HFTX.31/SL-M40x1.5	M40x1.5	11.5	13	47	30	40.5	8+10	22
13656	HFTX.9/SL-1/4	G 1/4	10	6	18	9	15	2+3	2
13676	HFTX.12/SL-3/8	G 3/8	7.5	7	22	11	19	3+5	3
13696	HFTX.15/SL-1/2	G 1/2	10.5	8	26	14	22	4+6	5
13727	HFTX.20/SL-3/4	G 3/4	10.5	9	31.5	20	27	6+8	6
13746	HFTX.24/SL-1	G 1	11	10	40	25	34	8+10	12
13766	HFTX.30/SL-1¼	G1 1/4	11.5	13	47	30	40.5	8+10	22
13786	HFTX.35/SL-1.1/2	G1 1/2	13	13	56	35	48	10+12	29
13796	HFTX.47/SL-2	G2	14	16	67	47	58	10+12	44



Accessories for hydraulic systems