

# Switching element

96-323.837



<https://eao.com/p/96-323.837>

Your product:

---



## 96-323.837

### Switching element

#### ELECTRICAL CHARACTERISTICS

<b>Electric strength:</b>	500 VAC, 50 Hz, 1 minute, as per IEC 60512-2-11 between all terminals and earth
<b>Electrical lifetime:</b>	$\geq 5 \times 100\,000$ cycles of operation at 30 VDC, 100 mA, according to IEC 61058-1
<b>Contact resistance:</b>	New state $\leq 50\text{ m}\Omega$ , as per DIN / IEC 60512-2-2b
<b>Contacts:</b>	1 C
<b>Thermal current I<sub>th</sub>:</b>	100 mA

#### MECHANICAL CHARACTERISTIC

<b>Weight:</b>	0.002 kg
<b>Operating Travel:</b>	Lead distance 1.0 mm $\pm 0.3$ mm, Total distance 1.7 mm $\pm 0.5$ mm
<b>Switching system:</b>	Single-break, self-cleaning, snap-action switching element with tactile feel of operation.
<b>Contact material:</b>	Gold
<b>Operating force:</b>	1.4 N $\pm 0.3$ N
<b>Switching system:</b>	Snap-action switching element
<b>Terminal:</b>	PCB terminal
<b>Mechanical lifetime:</b>	$\geq 5$ Mio. cycles of operation, according to IEC 60512-5-9a

#### AMBIENT CONDITION

<b>IP front protection:</b>	IP67, according to IEC 60529
<b>Shock resistance:</b>	≥30 g for 11 ms, according to IEC 60512-4-3 (Single impacts, semi-sinusoidal)
<b>Operating temperature:</b>	- 25 °C ... + 85 °C
<b>Storage temperature:</b>	- 40 °C ... + 85 °C
<b>Vibration resistance:</b>	10 g at 10 Hz...2000 Hz, amplitude 0.75 mm (Sinusoidal), according to DIN EN 60512-4-4

**OTHER**

<b>Short Description:</b>	Switching element, Snap-action switching element, 42 V @ A, Gold, 1 C, PCB terminal
<b>Housing material:</b>	Plastic
<b>Component layouts:</b>	

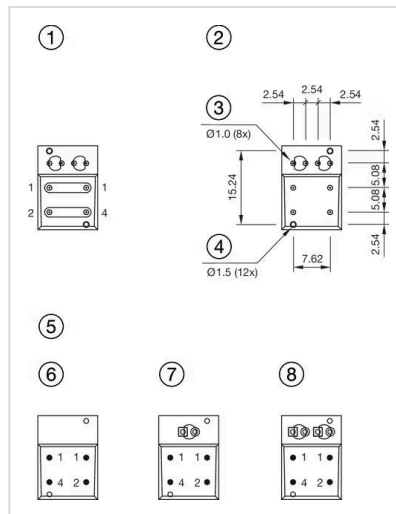

**Dimension drawings:**

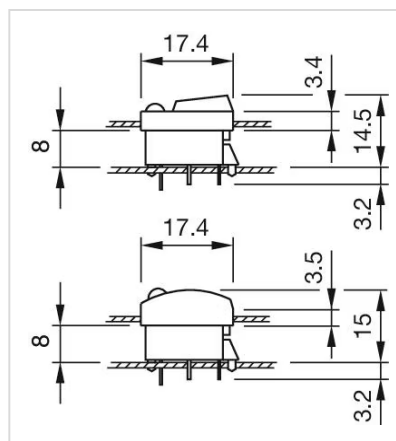

**Mounting cut-outs:**

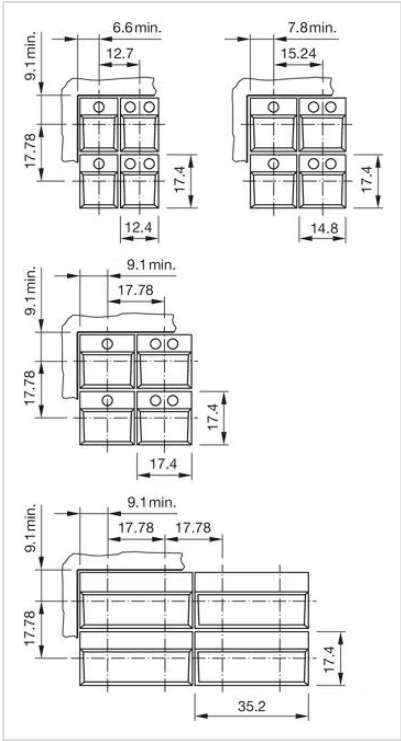

**Wiring diagrams:**

