

Illuminated pushbutton Ø 22 mm silver contact

82-6152.1113.B002



<https://eao.com/p/82-6152.1113.B002>

Your product:



82-6152.1113.B002
Illuminated pushbutton Ø
22 mm silver contact

FRONT

Front bezel material: Stainless steel

MOUNTING

Mounting cut-out: Ø 22 mm

OPERATING-/INDICATION PART

Illumination colour: Red

Lens illumination: illuminative

Lens shape: flush

Lens colour: Silver

Shape of illumination: Ring

Lens material: Stainless steel

Lens optics: opaque

ELECTRICAL CHARACTERISTICS

Rated Operational Voltage U_e: 250 VAC

Operating voltage: 12 V AC/DC

Rated insulation voltage U_i: 250 V

Switching voltage and switching current:

| | |
|--|---------------------|
| according to IEC 60947-5-1 (Silver contacts) | |
| Service categorie AC-15 | |
| Voltage | Current |
| 24 VAC | 1 A |
| 35 VAC | 1 A (M12 version) |
| 110 VAC | 1 A |
| 220 VAC | 0.5 A |
| Switch rating DC service categorie DC-13 (Silver contacts) | |
| Voltage | Current |
| 24 VDC | 0.7 A |
| 35 VDC | 0.5 A (M12 version) |
| 110 VDC | 0.2 A |
| 220 VDC | 0.1 A |

| | |
|---------------------------------------|---------|
| according to UL 508 (Silver contacts) | |
| cosφ 0,75 ... 0,8 | |
| Voltage | Current |
| 120 VAC | 5 A |
| 240 VAC | 3 A |
| 24 VAC | 1 A |

| | |
|--|--|
| Pollution degree: | 2, according to EN IEC 60947-1 |
| Thermal current I_{th}: | 5 A |
| Electrical lifetime: | 50 000 cycles of operation |
| Electric strength: | 1500 VAC, 50 Hz 1 minute between life terminals and ground |
| Contacts: | 1 C |

MECHANICAL CHARACTERISTIC

| | |
|-----------------------------|---------------------------------------|
| Operating Travel: | ca. 3 mm |
| Terminal: | Screw terminal |
| Contact material: | Silver |
| Weight: | 0.018 kg |
| Switching system: | Snap-action switching element |
| Mechanical lifetime: | 1 Mio. cycles of operation |
| Operating force: | 4 N ... 7 N |
| Switching action: | Momentary |
| Tightening torque: | 0.5 ... 0.6 Nm, Screw terminal 0.1 Nm |

AMBIENT CONDITION

| | |
|-------------------------------|--|
| Vibration resistance: | 10 ... 500 Hz, amplitude 1.5 mm p-p according to IEC 60068-2-6 |
| Shock resistance: | Max. 500 m / s ² as per IEC 60068-2-27 |
| Operating temperature: | - 30 °C ... + 70 °C |
| Storage temperature: | |

- 40 °C ... + 80 °C

Climate resistance:

Damp heat, 21 days according to IEC 60512-11

CERTIFICATE

Conformities:

CE, 2011 / 65 / EC (RoHS), 2014 / 35 / EU (LVD)

Approbations:

CB, CCC, C UL, UL

OTHER

Short Description:

Illuminated pushbutton Ø 22 mm silver contact, Momentary, 12 V AC/DC, 1 C, Screw terminal, Stainless steel, Red, Standby, Silver

Symbol:

Standby

Kind of illumination:

Single-LED

Wiring diagrams:

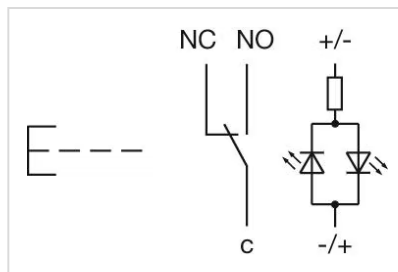

Component layouts:

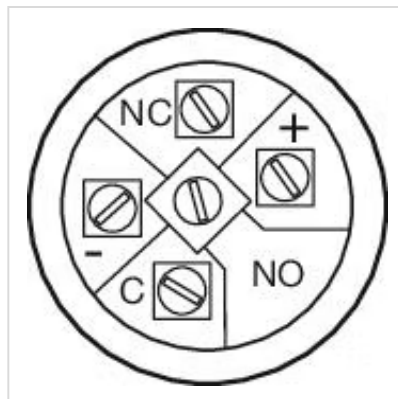

Mounting cut-outs:

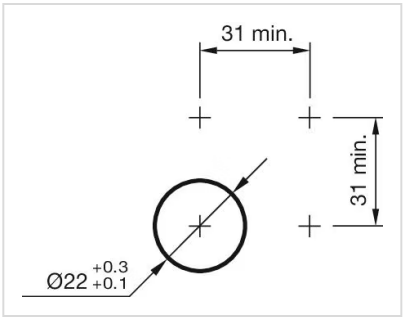

Dimension drawings:

