

Illuminated pushbutton Ø 16 mm silver contact

82-4151.1124



<https://eao.com/p/82-4151.1124>

Your product:



82-4151.1124

Illuminated pushbutton Ø 16 mm silver contact

FRONT

Front bezel material: Stainless steel

MOUNTING

Mounting cut-out: Ø 16 mm

OPERATING-/INDICATION PART

Lens shape: flush

Shape of illumination: Ring

Lens optics: opaque

Lens illumination: illuminative

Lens colour: Silver

Lens material: Stainless steel

Illumination colour: Blue

ELECTRICAL CHARACTERISTICS

Contacts: 1 C

Rated insulation voltage U_i : 250 V

Operating voltage: 24 V AC/DC

Electric strength: 1500 VAC, 50 Hz 1 minute between life terminals and ground

Pollution degree: 2, according to EN IEC 60947-1

Thermal current I_{th} : 5 A

Rated Operational Voltage U_e : 250 VAC

Switching voltage and switching current:

according to IEC 60947-5-1 (Silver contacts)	
Service categorie AC-15	
Voltage	Current
24 VAC	1 A
35 VAC	1 A (M12 versio
110 VAC	1 A
220 VAC	0.5 A
Switch rating DC service categorie DC-13 (Silver contacts)	
Voltage	Current
24 VDC	0.7 A
35 VDC	0.5 A (M12 vers
110 VDC	0.2 A
220 VDC	0.1 A

according to UL 508 (Silver contacts)	
$\cos\phi$ 0,75 ... 0,8	
Voltage	Current
120 VAC	5 A
240 VAC	3 A
24 VAC	1 A

Electrical lifetime: 50 000 cycles of operation

MECHANICAL CHARACTERISTIC

Switching action:	Momentary
Tightening torque:	0.5 ... 0.6 Nm
Terminal:	Soldering terminal, 2.8 x 0.5 mm
Weight:	0.018 kg
Operating Travel:	ca. 3 mm
Mechanical lifetime:	1 Mio. cycles of operation
Operating force:	4 N ... 7 N
Contact material:	Silver
Switching system:	Snap-action switching element

AMBIENT CONDITION

Shock resistance:	Max. 500 m / s ² as per IEC 60068-2-27
Climate resistance:	Damp heat, 21 days according to IEC 60512-11
Operating temperature:	- 30 °C ... + 70 °C
Vibration resistance:	10 ... 500 Hz, amplitude 1.5 mm p-p according to IEC 60068-2-6
Storage temperature:	- 40 °C ... + 80 °C

CERTIFICATE

Conformities: CE, 2011 / 65 / EC (RoHS), 2014 / 35 / EU (LVD)

Approbations: CB, CCC, C UL, UL

OTHER

Short Description: Illuminated pushbutton Ø 16 mm silver contact, Momentary, 24 V AC/DC, 1 C, Soldering terminal, 2.8 x 0.5 mm, Stainless steel, Blue, Silver

Kind of illumination: Single-LED

Dimension drawings:

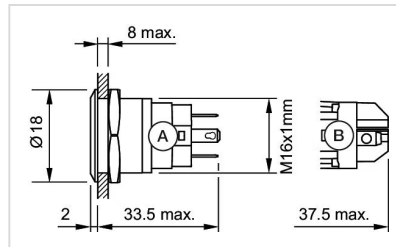

Component layouts:

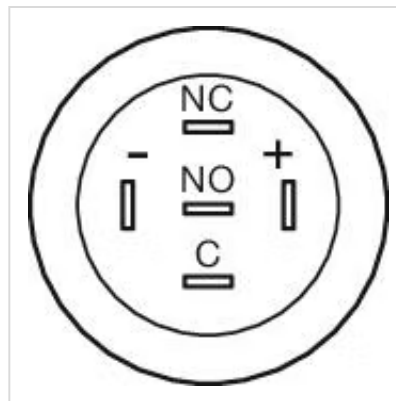

Wiring diagrams:

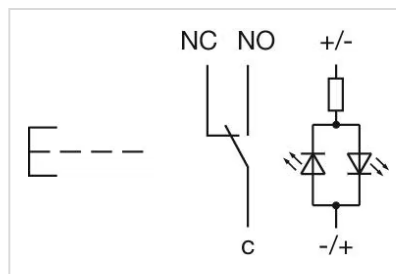

Mounting cut-outs:

