

Illuminated pushbutton Ø 22 mm silver contact

82-6152.1133.B002



<https://eao.com/p/82-6152.1133.B002>

Your product:



82-6152.1133.B002 Illuminated pushbutton Ø 22 mm silver contact

FRONT

Front bezel material: Stainless steel

MOUNTING

Mounting cut-out: Ø 22 mm

OPERATING-/INDICATION PART

Lens shape: flush

Lens material: Stainless steel

Illumination colour: Green

Shape of illumination: Ring

Lens illumination: illuminative

Lens optics: opaque

Lens colour: Silver

ELECTRICAL CHARACTERISTICS

Pollution degree: 2, according to EN IEC 60947-1

Switching voltage and switching current:

according to IEC 60947-5-1 (Silver contacts)	
Service categorie AC-15	
Voltage	Current
24 VAC	1 A
35 VAC	1 A (M12 versio
110 VAC	1 A
220 VAC	0.5 A
Switch rating DC service categorie DC-13 (Silver contacts)	
Voltage	Current
24 VDC	0.7 A
35 VDC	0.5 A (M12 vers
110 VDC	0.2 A
220 VDC	0.1 A

according to UL 508 (Silver contacts)

cosφ 0,75 ... 0,8

Voltage

120 VAC

240 VAC

24 VAC

Current

5 A

3 A

1 A

Thermal current Ith:	5 A
Operating voltage:	12 V AC/DC
Contacts:	1 C
Rated insulation voltage Ui:	250 V
Rated Operational Voltage Ue:	250 VAC
Electric strength:	1500 VAC, 50 Hz 1 minute between life terminals and ground
Electrical lifetime:	50 000 cycles of operation

MECHANICAL CHARACTERISTIC

Mechanical lifetime:	1 Mio. cycles of operation
Switching system:	Snap-action switching element
Switching action:	Momentary
Operating force:	4 N ... 7 N
Terminal:	Screw terminal
Tightening torque:	0.5 ... 0.6 Nm, Screw terminal 0.1 Nm
Weight:	0.018 kg
Operating Travel:	ca. 3 mm
Contact material:	Silver

AMBIENT CONDITION

Climate resistance:	Damp heat, 21 days according to IEC 60512-11
Operating temperature:	- 30 °C ... + 70 °C
Vibration resistance:	10 ... 500 Hz, amplitude 1.5 mm p-p according to IEC 60068-2-6
Shock resistance:	Max. 500 m / s ² as per IEC 60068-2-27
Storage temperature:	- 40 °C ... + 80 °C

CERTIFICATE

Approbations:	CB, CCC, C UL, UL
----------------------	-------------------

Conformities:

CE, 2011 / 65 / EC (RoHS), 2014 / 35 / EU (LVD)

OTHER

Symbol:

Standby

Kind of illumination:

Single-LED

Short Description:

Illuminated pushbutton Ø 22 mm silver contact, Momentary, 12 V AC/DC, 1 C, Screw terminal, Stainless steel, Green, Standby, Silver

Dimension drawings:

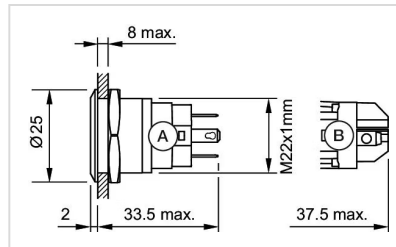

Component layouts:

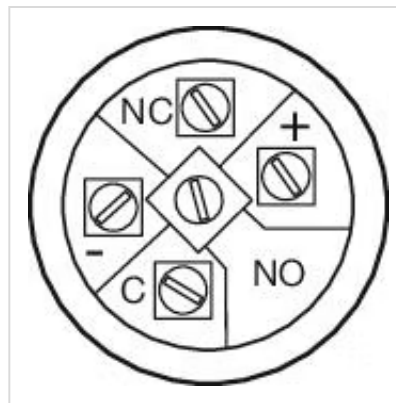

Wiring diagrams:

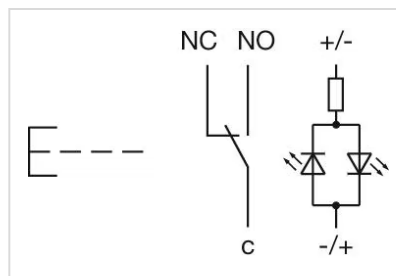

Mounting cut-outs:

