

# Actuator

51-  
259.025



<https://eao.com/p/51-259.025>

Your product:

---



## 51-259.025 Actuator

### FRONT

**Front dimension:** Ø 24,5 mm

### MOUNTING

**Design:** raised

### OPERATING-/INDICATION PART

**Lens optics:** opaque

**Lens material:** Plastic

**Lens colour:** Red

**Lens shape:** mushroom-head

**Lens illumination:** non illuminative

### ELECTRICAL CHARACTERISTICS

**Switching voltage and switching current:** 250 VAC, 5 A (ohmic)  
24 VDC, 2 A (inductive, L:R = 30 ms)

**Contacts:** 2 NC / 2 NO

### MECHANICAL CHARACTERISTIC

**Switching action:** Maintained

**Switching system:** Self-cleaning, double-break snap action switching system, 1 normally closed and 1 normally open contact per element.

**Mechanical lifetime:** 100 000 cycles of operation

**Contact material:** Gold

<b>Tightening torque:</b>	Fixing nut max. 0.5 Nm
<b>Terminal:</b>	Soldering terminal
<b>Weight:</b>	0.011 kg
<b>Switching system:</b>	Snap-action switching element
<b>Operating force:</b>	18 ... 21 N (depending on the switching element)

### AMBIENT CONDITION

<b>Operating temperature:</b>	- 25 °C ... + 55 °C
<b>Storage temperature:</b>	- 40 °C ... + 85 °C
<b>IP front protection:</b>	IP65, according to DIN EN 60529

### CERTIFICATE

<b>Conformities:</b>	CE, UKCA, 2006 / 42 / EC (MD), 2011 / 65 / EC (RoHS)
<b>Approbations:</b>	CB (IEC 61058-1), CSA, ENEC (EN 61058-1), UL

### OTHER

<b>Housing colour:</b>	Black
<b>Hints:</b>	Marking arrows
<b>Short Description:</b>	Actuator, Ø 24,5 mm, mushroom-head, non illuminative, Red, Plastic, opaque, 2 NC / 2 NO, Maintained, Soldering terminal, IP65, according to DIN EN 60529
<b>Wiring diagrams:</b>	

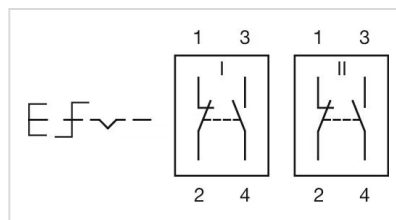

### Dimension drawings:

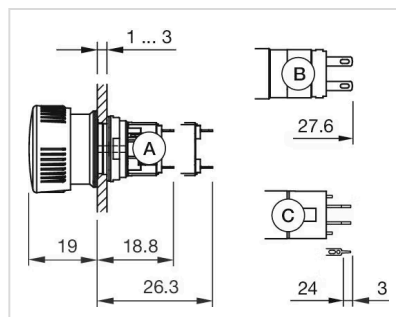

**Mounting cut-outs:**

