

# Lamp block

704.950.1



<https://eao.com/p/704.950.1>

Your product:

---



## 704.950.1 Lamp block

### ELECTRICAL CHARACTERISTICS

**Standards:** The switches comply with the "Standards for low-voltage switching devices" DIN EN 60947-1/DIN EN 60947-5-1

### MECHANICAL CHARACTERISTIC

**Terminal:** Plug-in terminal, 6.3 x 0.8 mm

**Weight:** 0.012 kg

**Wire cross section:** Plug-in terminal 1 x 6.3 mm x 0.8 mm or 2 x 2.8 mm x 0.8 mm  
For switches with plug-in terminals it is necessary to provide insulation sleeves and to maintain a spacing of 65 mm between rows (mounting cut-outs).

**Switching positions:** 2 positions

### AMBIENT CONDITION

**Storage temperature:** - 40 °C ... + 85 °C

**Shock resistance:** Max. 300 m/s<sup>2</sup>, pulse width 11 ms (sinusoidal EN IEC 60068-2-27)

**Vibration resistance:** Max. 100 m / s<sup>2</sup> from 10 Hz ... 500 Hz, (sinusoidal EN IEC 60068-2-6)

**Climate resistance:** Relative humidity, max. 95%, non-condensing

**Operating temperature:** - 40 °C ... + 55 °C

**IP Protection:** IP00

### OTHER

**Housing material:** Plastic

**Short Description:** Lamp block, Plastic, Plug-in terminal, 6.3 x 0.8 mm

**Hints:** When using the lamp block, the application guidelines must be observed.

**Dimension drawings:**

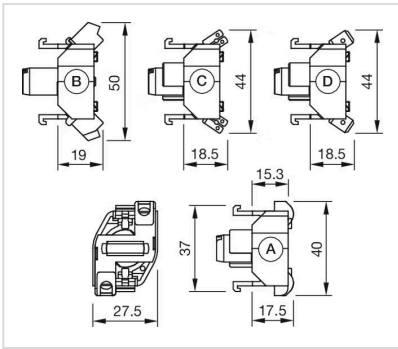

**Wiring diagrams:**

