

# Illuminated pushbutton Ø 22 mm silver contact

82-6151.2113.B002



<https://eao.com/p/82-6151.2113.B002>

Your product:

---



82-6151.2113.B002  
Illuminated pushbutton Ø  
22 mm silver contact

#### FRONT

**Front bezel material:** Stainless steel

#### MOUNTING

**Mounting cut-out:** Ø 22 mm

#### OPERATING-/INDICATION PART

**Lens illumination:** illuminative

**Illumination colour:** Red

**Lens colour:** Silver

**Lens shape:** flush

**Lens optics:** opaque

**Lens material:** Stainless steel

**Shape of illumination:** Ring

#### ELECTRICAL CHARACTERISTICS

**Electrical lifetime:** 50 000 cycles of operation

**Contacts:** 1 C

**Switching voltage and switching current:**

according to IEC 60947-5-1 (Silver contacts)

Service categorie AC-15

Voltage

24 VAC

35 VAC

110 VAC

220 VAC

Current

1 A

1 A (M12 version)

1 A

0.5 A

Switch rating DC service categorie DC-13 (Silver contacts)

Voltage

24 VDC

35 VDC

110 VDC

220 VDC

Current

0.7 A

0.5 A (M12 version)

0.2 A

0.1 A

according to UL 508 (Silver contacts)

cos $\phi$  0,75 ... 0,8

Voltage

120 VAC

240 VAC

24 VAC

Current

5 A

3 A

1 A

<b>Electric strength:</b>	1500 VAC, 50 Hz 1 minute between life terminals and ground
<b>Rated insulation voltage Ui:</b>	250 V
<b>Thermal current Ith:</b>	5 A
<b>Pollution degree:</b>	2, according to EN IEC 60947-1
<b>Operating voltage:</b>	12 V AC/DC
<b>Rated Operational Voltage Ue:</b>	250 VAC

### MECHANICAL CHARACTERISTIC

<b>Mechanical lifetime:</b>	500 000 cycles of operation
<b>Tightening torque:</b>	0.5 ... 0.6 Nm
<b>Switching system:</b>	Snap-action switching element
<b>Weight:</b>	0.018 kg
<b>Terminal:</b>	Soldering terminal, 2.8 x 0.5 mm
<b>Contact material:</b>	Silver
<b>Operating force:</b>	4 N ... 7 N
<b>Switching action:</b>	Maintained
<b>Operating Travel:</b>	ca. 3 mm

### AMBIENT CONDITION

<b>Climate resistance:</b>	Damp heat, 21 days according to IEC 60512-11
<b>Storage temperature:</b>	- 40 °C ... + 80 °C
<b>Operating temperature:</b>	

- 30 °C ... + 70 °C

**Vibration resistance:** 10 ... 500 Hz, amplitude 1.5 mm p-p according to IEC 60068-2-6

**Shock resistance:** Max. 500 m / s<sup>2</sup> as per IEC 60068-2-27

### CERTIFICATE

**Conformities:** CE, 2011 / 65 / EC (RoHS), 2014 / 35 / EU (LVD)

**Approbations:** CB, CCC, C UL, UL

### OTHER

**Kind of illumination:** Single-LED

**Symbol:** Standby

**Short Description:** Illuminated pushbutton Ø 22 mm silver contact, Maintained, 12 V AC/DC, 1 C, Soldering terminal, 2.8 x 0.5 mm, Stainless steel, Red, Standby, Silver

**Component layouts:**

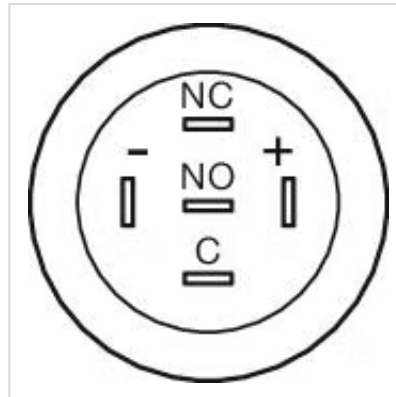

**Wiring diagrams:**

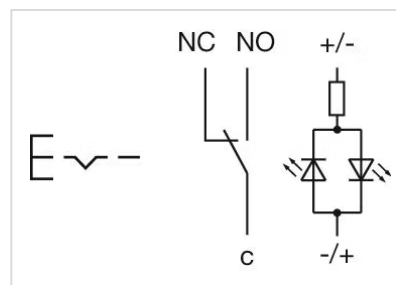

**Mounting cut-outs:**

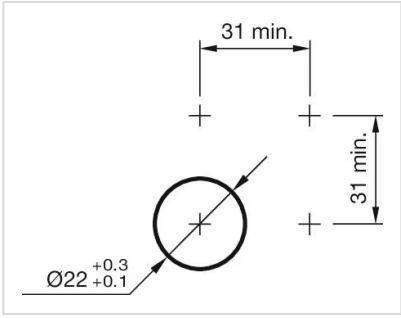

**Dimension drawings:**

