

Illuminated pushbutton Ø 19 mm silver contact

82-5151.1124



<https://eao.com/p/82-5151.1124>

Your product:



82-5151.1124

Illuminated pushbutton Ø 19 mm silver contact

FRONT

Front bezel material: Stainless steel

MOUNTING

Mounting cut-out: Ø 19 mm

OPERATING-/INDICATION PART

Lens colour: Silver

Lens material: Stainless steel

Lens shape: flush

Illumination colour: Blue

Shape of illumination: Ring

Lens illumination: illuminative

Lens optics: opaque

ELECTRICAL CHARACTERISTICS

Thermal current I_{th}: 5 A

Switching voltage and switching current:

according to IEC 60947-5-1 (Silver contacts)	
Service categorie AC-15	
Voltage	Current
24 VAC	1 A
35 VAC	1 A (M12 versio
110 VAC	1 A
220 VAC	0.5 A
Switch rating DC service categorie DC-13 (Silver contacts)	
Voltage	Current
24 VDC	0.7 A
35 VDC	0.5 A (M12 vers
110 VDC	0.2 A
220 VDC	0.1 A

according to UL 508 (Silver contacts)

$\cos\phi$ 0,75 ... 0,8

Voltage

120 VAC

240 VAC

24 VAC

Current

5 A

3 A

1 A

Rated Operational Voltage U_e:	250 VAC
Pollution degree:	2, according to EN IEC 60947-1
Electrical lifetime:	50 000 cycles of operation
Contacts:	1 C
Rated insulation voltage U_i:	250 V
Operating voltage:	24 V DC
Electric strength:	1500 VAC, 50 Hz 1 minute between life terminals and ground

MECHANICAL CHARACTERISTIC

Switching action:	Momentary
Weight:	0.018 kg
Tightening torque:	0.5 ... 0.6 Nm
Terminal:	Soldering terminal, 2.8 x 0.5 mm
Operating Travel:	ca. 3 mm
Operating force:	4 N ... 7 N
Contact material:	Silver
Mechanical lifetime:	1 Mio. cycles of operation
Switching system:	Snap-action switching element

AMBIENT CONDITION

Storage temperature:	- 40 °C ... + 80 °C
Shock resistance:	Max. 500 m / s ² as per IEC 60068-2-27
Operating temperature:	- 30 °C ... + 70 °C
Climate resistance:	Damp heat, 21 days according to IEC 60512-11
Vibration resistance:	10 ... 500 Hz, amplitude 1.5 mm p-p according to IEC 60068-2-6

CERTIFICATE

Conformities:	CE, 2011 / 65 / EC (RoHS), 2014 / 35 / EU (LVD)
----------------------	---

Approbations:

CB, CCC, C UL, UL

OTHER

Kind of illumination:

Single-LED

Short Description:

Illuminated pushbutton \varnothing 19 mm silver contact, Momentary, 24 V DC, 1 C, Soldering terminal, 2.8 x 0.5 mm, Stainless steel, Blue, Silver

Mounting cut-outs:

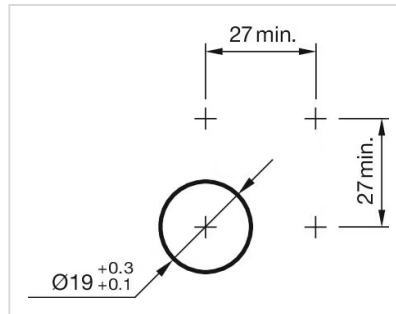

Component layouts:

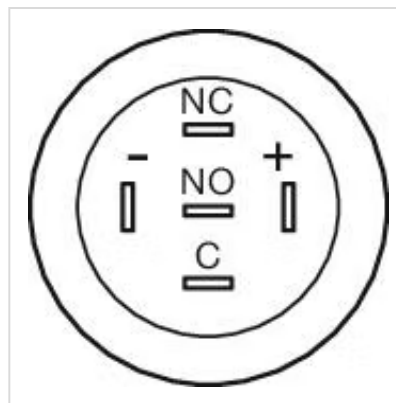

Wiring diagrams:

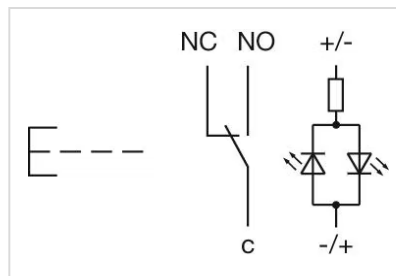

Dimension drawings:

