

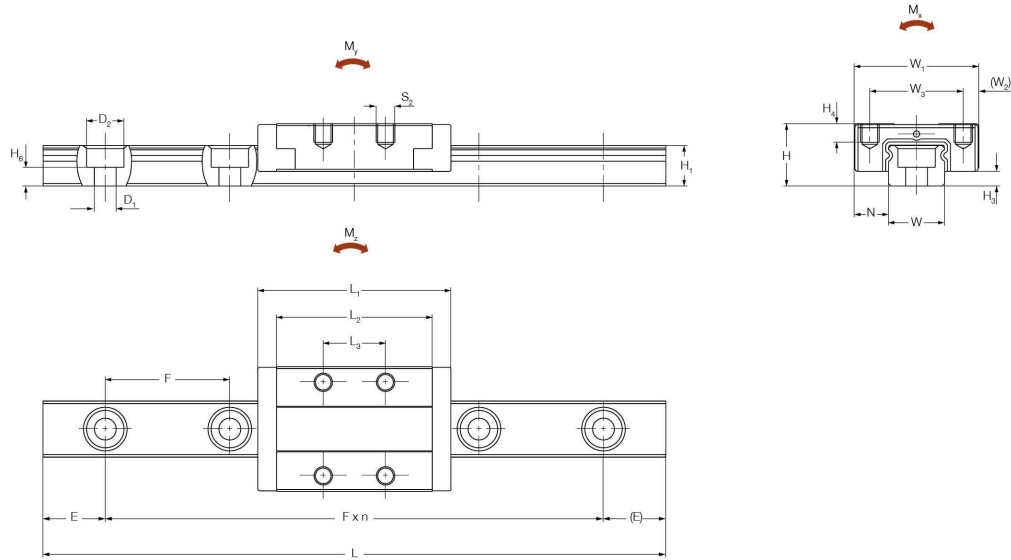

## LLSHC 9 TA T0 P5 ZRC

Standard carriage in standard length, shielded with light clearance



$W_1$ (mm)	20	$W_3$ (mm)	15
$H$ (mm)	10	$S_2$ (-)	M3
$N$ (mm)	5.5	$H_4$ (mm)	3
$H_3$ (mm)	2.35	$H_{ct}$ (mm)	5.1
$W$ (mm)	9	Weight (kg)	0.021
$H_1$ (mm)	6.5	$v_{max}$ (m/sec)	5
$H_6$ (mm)	3	$a_{max}$ (m/sec <sup>2</sup> )	140
$F$ (mm)	20	$C$ (N)	1700
$D_1$ (mm)	3.5	$C_0$ (N)	2800
$D_2$ (mm)	6	$M_{xc}$ (Nm)	7.1
$E_{min}$ (mm)	5	$M_{xc0}$ (Nm)	11.5
$E_{max}$ (mm)	15	$M_{yc}$ (Nm)	4.6
$L_{max}$ (mm)	2000	$M_{yc0}$ (Nm)	7.5
$L_1$ (mm)	31	$M_{zc}$ (Nm)	4.6
$L_2$ (mm)	25	$M_{zc0}$ (Nm)	7.5
$L_3$ (mm)	10		