

# Header - MC 1,5/16-G-3,5-RN - 1731811

Please be informed that the data shown in this PDF Document is generated from our Online Catalog. Please find the complete data in the user's documentation. Our General Terms of Use for Downloads are valid (<http://phoenixcontact.com/download>)

PCB headers, nominal current: 8 A, rated voltage (III/2): 160 V, number of positions: 16, pitch: 3.5 mm, color: green, contact surface: Tin, mounting: Wave soldering



The figure shows a 10-position version of the product

## Why buy this product

- Well-known mounting principle allows worldwide use
- Intuitive locking mechanism prevents accidental disconnection

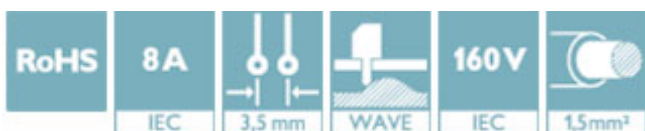

## Key Commercial Data

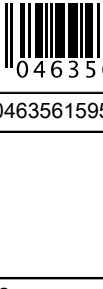
|              |                                                                                                        |
|--------------|--------------------------------------------------------------------------------------------------------|
| Packing unit | 50 STK                                                                                                 |
| GTIN         | <br>4 046356 159524 |
| GTIN         | 4046356159524                                                                                          |

## Technical data

### Dimensions

|                          |           |
|--------------------------|-----------|
| Length [ l ]             | 9.2 mm    |
| Pitch                    | 3.5 mm    |
| Dimension a              | 52.5 mm   |
| Width [ w ]              | 59.6 mm   |
| Constructional height    | 7.25 mm   |
| Height [ h ]             | 10.65 mm  |
| Length of the solder pin | 3.4 mm    |
| Pin dimensions           | 0,8 x 0,8 |
| Hole diameter            | 1.2 mm    |

### General

|                           |                 |
|---------------------------|-----------------|
| Range of articles         | MC 1,5/...-G-RN |
| Insulating material group | IIIa            |

# Header - MC 1,5/16-G-3,5-RN - 1731811

## Technical data

### General

|                                        |        |
|----------------------------------------|--------|
| Rated surge voltage (III/3)            | 2.5 kV |
| Rated surge voltage (III/2)            | 2.5 kV |
| Rated surge voltage (II/2)             | 2.5 kV |
| Rated voltage (III/3)                  | 160 V  |
| Rated voltage (III/2)                  | 160 V  |
| Rated voltage (II/2)                   | 250 V  |
| Connection in acc. with standard       | EN-VDE |
| Nominal current $I_N$                  | 8 A    |
| Maximum load current                   | 8 A    |
| Insulating material                    | PBT    |
| Flammability rating according to UL 94 | V0     |
| Color                                  | green  |
| Number of positions                    | 16     |

### Standards and Regulations

|                                        |        |
|----------------------------------------|--------|
| Connection in acc. with standard       | EN-VDE |
|                                        | CUL    |
| Flammability rating according to UL 94 | V0     |

### Environmental Product Compliance

|            |                                                         |
|------------|---------------------------------------------------------|
| China RoHS | Environmentally friendly use period: unlimited = EFUP-e |
|            | No hazardous substances above threshold values          |

## Drawings

Drilling diagram

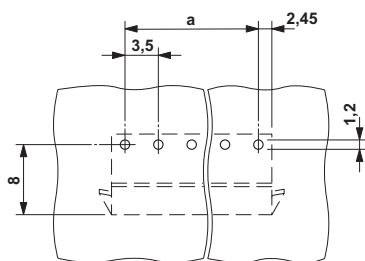

Dimensional drawing

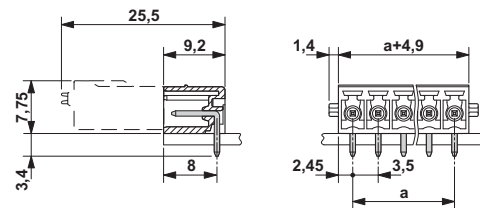

## Approvals

### Approvals

### Approvals

VDE Gutachten mit Fertigungsüberwachung / cULus Recognized / IECCE CB Scheme / EAC

# Header - MC 1,5/16-G-3,5-RN - 1731811

## Approvals

Ex Approvals

### Approval details

|                                            |       |                                                                                                                                                                                                                |          |
|--------------------------------------------|-------|----------------------------------------------------------------------------------------------------------------------------------------------------------------------------------------------------------------|----------|
| VDE Gutachten mit<br>Fertigungsüberwachung |       | <a href="http://www2.vde.com/de/Institut/Online-Service/VDE-gepruefteProdukte/Seiten/Online-Suche.aspx">http://www2.vde.com/de/Institut/Online-Service/<br/>VDE-gepruefteProdukte/Seiten/Online-Suche.aspx</a> | 40011723 |
|                                            |       |                                                                                                                                                                                                                |          |
| Nominal current IN                         | 8 A   |                                                                                                                                                                                                                |          |
| Nominal voltage UN                         | 160 V |                                                                                                                                                                                                                |          |

|                    |       |                                                                                                                                                       |                 |
|--------------------|-------|-------------------------------------------------------------------------------------------------------------------------------------------------------|-----------------|
| cULus Recognized   |       | <a href="http://database.ul.com/cgi-bin/XYV/template/LISEXT/1FRAME/index.htm">http://database.ul.com/cgi-bin/XYV/template/LISEXT/1FRAME/index.htm</a> | E60425-20110128 |
|                    | B     | D                                                                                                                                                     |                 |
| Nominal current IN | 8 A   | 8 A                                                                                                                                                   |                 |
| Nominal voltage UN | 300 V | 300 V                                                                                                                                                 |                 |

|                    |       |                                                           |                |
|--------------------|-------|-----------------------------------------------------------|----------------|
| IECEE CB Scheme    |       | <a href="http://www.iecee.org/">http://www.iecee.org/</a> | DE1-59621-B1B2 |
|                    |       |                                                           |                |
| Nominal current IN | 8 A   |                                                           |                |
| Nominal voltage UN | 160 V |                                                           |                |

|     |  |         |
|-----|--|---------|
| EAC |  | B.01742 |
|-----|--|---------|

Phoenix Contact 2018 © - all rights reserved  
<http://www.phoenixcontact.com>

PHOENIX CONTACT GmbH & Co. KG  
 Flachsmarktstr. 8  
 32825 Blomberg  
 Germany  
 Tel. +49 5235 300  
 Fax +49 5235 3 41200  
<http://www.phoenixcontact.com>