

SCREW-COVER, TYPE 4X

INDUSTRY STANDARDS

UL 50, 50E Listed; Type 3, 3R, 4, 4X, 12; File No. E27525; cUL Listed per CSA C22.2 No. 40 and No. 94.2; Type 3, 3R, 4, 4X, 12

IEC 60529, IP66

APPLICATION

Use this enclosure in commercial and industrial applications that require a junction box or pull box in a corrosive environment.

FEATURES

- Seams continuously welded and ground smooth
- Oil-resistant gasket and adhesive
- Captivated stainless steel cover screw threaded into sealed walls
- No holes or knockouts

SPECIFICATIONS

- Type 304 stainless steel covers and bodies
- 10 to 16 gauge stainless steel

FINISH

No. 2B finish

ACCESSORIES

Handle - STSCHDL

Mounting Bracket Kits - LMFKSS for enclosure sizes from 6x6 through 12x12; CMFKSS for enclosure sizes from 16x12 through 48x48

BULLETIN: A90S4

Standard Product

Catalog Number	AxBxC in.	AxBxC mm	No. of Cover Screws	Cover Gauge	Body Gauge	F (in.)	F (mm)	G (in.)	G (mm)	J (in.)	J (mm)
ASE6X6X4SSNK	6.00 x 6.00 x 4.00	152 x 152 x 102	4	16	16	1.27	32	.36	9	.25	6
ASE6X6X6SSNK	6.00 x 6.00 x 6.00	152 x 152 x 152	4	16	16	1.27	32	.36	9	.25	6
ASE8X6X4SSNK	8.00 x 6.00 x 4.00	203 x 153 x 102	4	16	16	1.27	32	.36	9	.25	6
ASE8X8X4SSNK	8.00 x 8.00 x 4.00	203 x 203 x 102	4	16	16	1.27	32	.36	9	.25	6
ASE8X8X6SSNK	8.00 x 8.00 x 6.00	203 x 203 x 152	4	14	16	1.27	32	.36	9	.25	6
ASE10X8X4SSNK	10.00 x 8.00 x 4.00	254 x 203 x 102	4	14	14	1.27	32	.36	9	.25	6
ASE10X8X6SSNK	10.00 x 8.00 x 6.00	254 x 203 x 152	4	14	14	1.27	32	.36	9	.25	6
ASE10X10X4SSNK	10.00 x 10.00 x 4.00	254 x 254 x 102	4	12	14	1.27	32	.36	9	.25	6
ASE10X10X6SSNK	10.00 x 10.00 x 6.00	254 x 254 x 152	4	12	14	1.27	32	.36	9	.25	6
ASE12X8X4SSNK	12.00 x 8.00 x 4.00	305 x 203 x 102	4	12	14	1.27	32	.36	9	.25	6
ASE12X10X4SSNK	12.00 x 10.00 x 4.00	305 x 254 x 102	4	12	14	1.27	32	.36	9	.25	6
ASE12X12X4SSNK	12.00 x 12.00 x 4.00	305 x 305 x 102	8	12	14	1.27	32	.36	9	.25	6
ASE12X12X6SSNK	12.00 x 12.00 x 6.00	305 x 305 x 152	8	12	14	1.27	32	.36	9	.25	6
ASE12X12X8SSNK	12.00 x 12.00 x 8.00	305 x 305 x 203	8	12	14	1.27	32	.36	9	.25	6
ASE16X12X4SSNK	16.00 x 12.00 x 4.00	406 x 305 x 102	8	12	14	.75	19	.75	19	.50	13
ASE16X16X6SSNK	16.00 x 16.00 x 6.00	406 x 406 x 152	8	14	14	.75	19	.75	19	.50	13
ASE18X12X4SSNK	18.00 x 12.00 x 4.00	457 x 305 x 102	8	12	14	.75	19	.75	19	.50	13
ASE18X12X6SSNK	18.00 x 12.00 x 6.00	457 x 305 x 152	8	12	14	.75	19	.75	19	.50	13
ASE18X18X4SSNK	18.00 x 18.00 x 4.00	457 x 457 x 102	8	14	14	.75	19	.75	19	.50	13
ASE18X18X6SSNK	18.00 x 18.00 x 6.00	457 x 457 x 152	8	14	14	.75	19	.75	19	.50	13
ASE18X18X8SSNK	18.00 x 18.00 x 8.00	457 x 457 x 203	8	14	14	.75	19	.75	19	.50	13
ASE24X24X6SSNK	24.00 x 24.00 x 6.00	610 x 610 x 152	10	12	14	.75	19	.75	19	.50	13
ASE24X24X8SSNK	24.00 x 24.00 x 8.00	610 x 610 x 203	10	12	14	.75	19	.75	19	.50	13
ASE24X24X10SSNK	24.00 x 24.00 x 10.00	610 x 610 x 254	10	12	14	.75	19	.75	19	.50	13
ASE24X24X12SSNK	24.00 x 24.00 x 12.00	610 x 610 x 305	10	12	14	.75	19	.75	19	.50	13
ASE30X30X6SSNK	30.00 x 30.00 x 6.00	762 x 762 x 152	12	14	14	.75	19	.75	19	.50	13
ASE30X30X8SSNK	30.00 x 30.00 x 8.00	762 x 762 x 203	12	14	14	.75	19	.75	19	.50	13
ASE30X30X10SSNK	30.00 x 30.00 x 10.00	762 x 762 x 254	12	14	14	.75	19	.75	19	.50	13
ASE30X30X12SSNK	30.00 x 30.00 x 12.00	762 x 762 x 305	12	14	14	.75	19	.75	19	.50	13
ASE36X36X6SSNK	36.00 x 36.00 x 6.00	914 x 914 x 152	16	14	14	.75	19	.75	19	.50	13
ASE36X36X8SSNK	36.00 x 36.00 x 8.00	914 x 914 x 203	16	14	14	.75	19	.75	19	.50	13
ASE36X36X12SSNK	36.00 x 36.00 x 12.00	914 x 914 x 305	16	14	14	.75	19	.75	19	.50	13
ASE48X48X12SSNK	48.00 x 48.00 x 12.00	1219 x 1219 x 305	20	10	14	.75	19	.75	19	.50	13

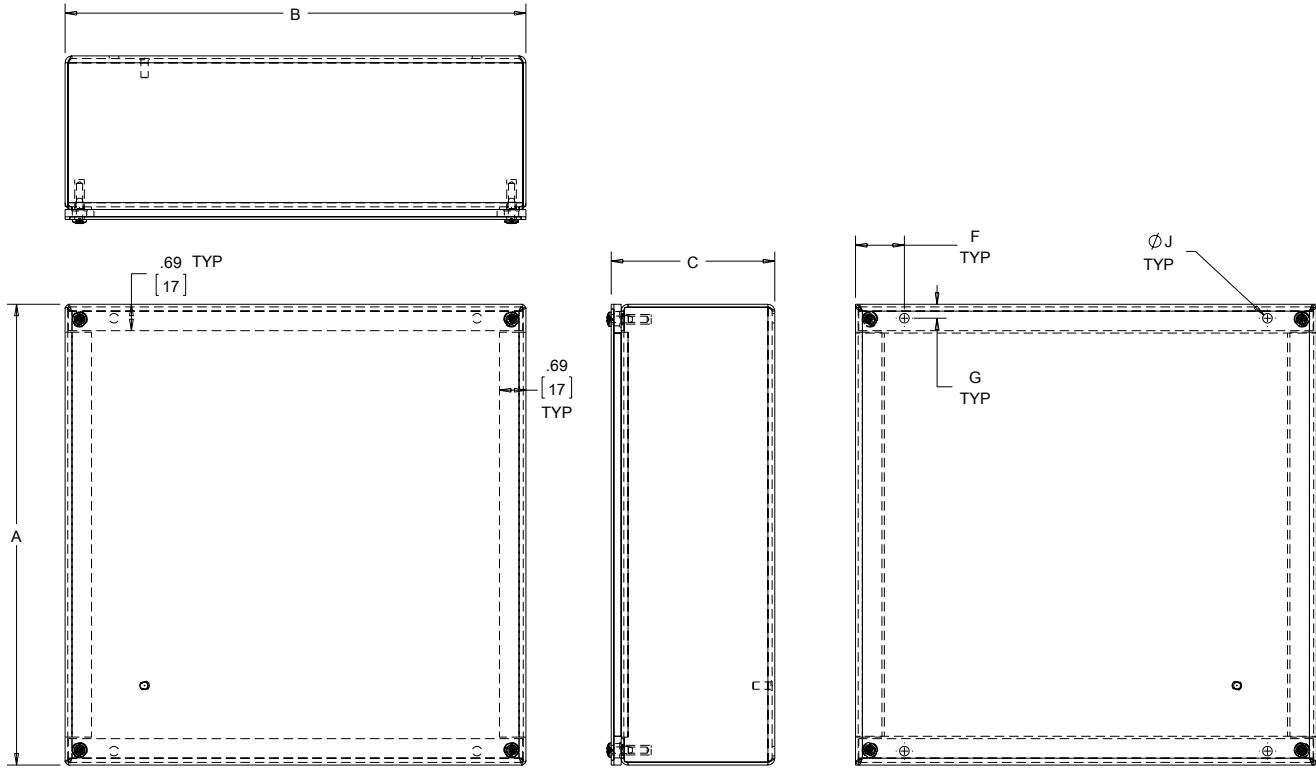

89133129

HANDLE KIT

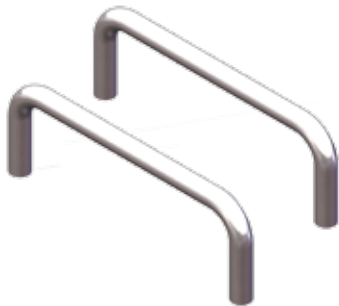

Handles are stainless steel for mounting on enclosure sides. Kit includes two handles and all mounting hardware.

BULLETIN: F24

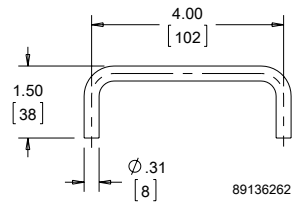

Standard Product

Catalog Number	Description
STSCHDL	Stainless steel handles

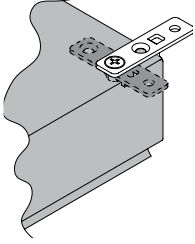
MOUNTING BRACKET KIT

Kit is field-installable on all solid-back-body enclosures. Hardware included. Four brackets per kit.

BULLETIN: A54SY, A54Y

Catalog Number	Description
LMFK	Plated steel mounting-bracket kit
LMFKSS	Type 316L stainless steel mounting-bracket kit

Use of LMFKSS recommended to maintain Type 4X rating.

MOUNTING BRACKET KIT

Type 304 stainless steel brackets are field-installable. Brackets maintain Type 4X rating. All hardware is included. Four brackets per kit.

Top brackets must be mounted to the sides of enclosure.

BULLETIN: A80

Catalog Number	Description
CMFKSS	Type 304 stainless steel mounting bracket kit

Notes