

Test Plugs 4 mm System



Type

LAS 30 / LAS 30 Au

4mm spring loaded plug, nickel/ gold plated contact spring, solder terminal up 1.5mm².

Pin diameter

4 mm (0.157")

PART NO. / Housing color

- | Nickel Plated | Gold Plated |
|---------------|-------------|
| ● 972518100 | ● 972518700 |
| ● 972518101 | ● 972518701 |
| ● 972518102 | ● 972518702 |
| ● 972518103 | ● 972518703 |
| ● 972518104 | ● 972518704 |



BUELA 20 K

4mm multi spring plug, flexible, insulated sleeve with 4mm cross hole, nickel plated brass, screw terminal max. 1.5mm².

4 mm (0.157")

- 930726100
- 930726101
- 930726102
- 930726103
- 930726104
- 930726107

Technical Data

Contact Type: spring loaded pin
 Connection Type: solder terminal max. 1.5mm²
 Voltage Rating: 30 VAC / 60 VDC
 Measurement Category (IEC61010): CAT I
 Current Rating*: 32A
 Contact Resistance: 3 mOhm

Material Specifications

Plug: nickel plated brass; gold plated brass
 Contact Spring: nickel pl. copper-beryllium; gold pl. copper-beryllium
 Housing: PVC-P

Environmental Conditions

Temperature range: -25 °C to +70°C (-13 to 158°F)

Flamability Rating

Housing: -

Contact Type: spring loaded pin
 Connection Type: screw terminal max. 1.5mm²
 Voltage Rating: 30 VAC / 60 VDC
 Measurement Category: CAT I
 Current Rating: 16A
 Contact Resistance: 3 mOhm

Plug: nickel plated brass
 Contact Spring: -
 Housing: PVC-P

Temperature range: -25 °C to +70°C (-13 to 158°F)

Housing: -

Drawing

Measurements are shown in millimeters.
 Multiply by 0.03937 to convert to inches.

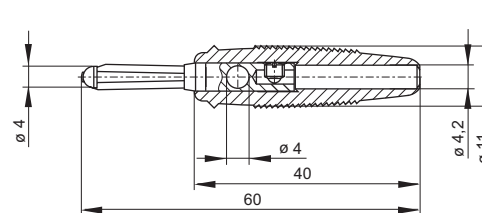
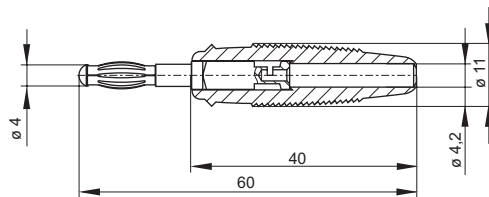

* Please consider derating graph on page 80.