

## BFO D25-LA-ED-EAK-250-0,5 BFO00C5

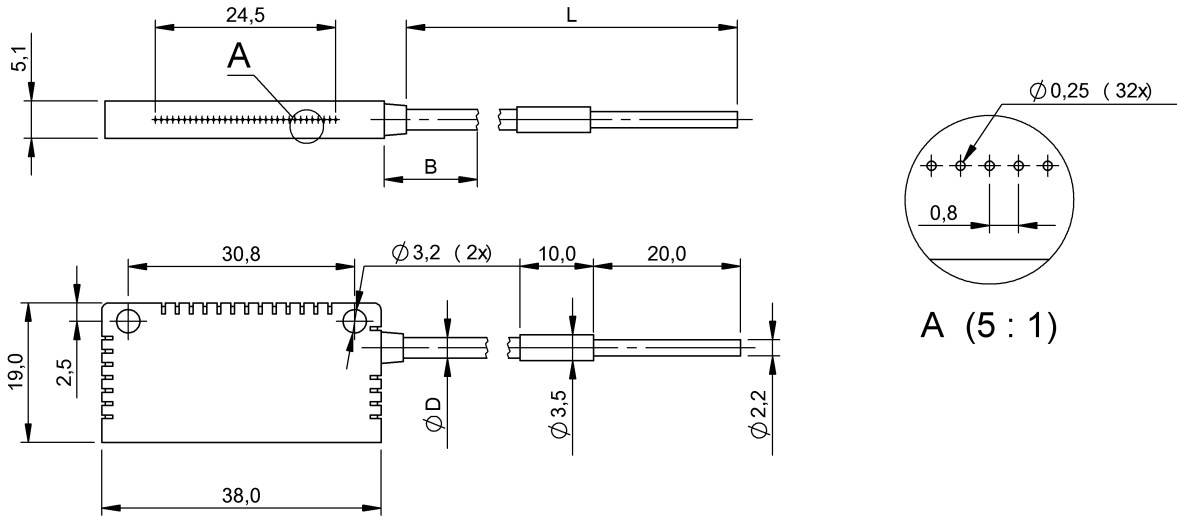

### Electrical connection

|                  |                            |
|------------------|----------------------------|
| Cable diameter D | 2.80 mm                    |
| Cable length     | 0.5 m                      |
| Connection       | Ø 2.2 mm                   |
| Connection type  | Adapter sleeve, 0.50 m, PE |

### Electrical data

|                        |                 |
|------------------------|-----------------|
| Active surface, fibers | Ø 0.25 mm (32x) |
|------------------------|-----------------|

### Environmental conditions

|                                     |                            |
|-------------------------------------|----------------------------|
| Ambient temperature                 | -55...70 °C                |
| Ambient temperature connection area | Acc. to fiber optic sensor |
| Protection type IEC 60529           | IP65                       |

### General data

|                     |                           |
|---------------------|---------------------------|
| Basic standard      | IEC 60947-5-2             |
| Reference base unit | BFB 75K-001-..            |
| Version             | 0.25x24.8, 90°-light grid |

### Material

|                                   |      |
|-----------------------------------|------|
| Active surface, fiber arrangement | Row  |
| Fiber type material               | PMMA |
| Housing material                  | ABS  |

|                 |    |
|-----------------|----|
| Material jacket | PE |
|-----------------|----|

### Mechanical data

|                              |                                |
|------------------------------|--------------------------------|
| Cable, bending radius min.   | 60 mm                          |
| Dimension                    | 5.1 x 38 x 19 mm               |
| Fastening detail             | Screw M3                       |
| Fiber optic cable, structure | Fiber bundle in plastic jacket |
| Tensile load max. at 20 °C   | 6 N (max. 3s)                  |

### Optical data

|                                |                     |
|--------------------------------|---------------------|
| Principle of optical operation | Through-beam sensor |
|--------------------------------|---------------------|

### Range/Distance

|                                 |        |
|---------------------------------|--------|
| Effective operating distance Sr | 550 mm |
| Range                           | 550 mm |
| Rated operating distance Sn     | 550 mm |

### Remarks

The scope of delivery includes one set of fiber optics for the transmitter and one for the receiver.  
Route fiber optic cable so that no excessive tensile, compression or torsional forces are permitted. Observe permissible bending radiuses. Installation may affect the switching distance.  
Actuation object (target): gray card, 200 x 200, lateral approach

BFO D25-LA-ED-EAK-250-0,5  
BFO00C5

## Symbols for Optoelectronic Sensors

