

BCC A314-A324-30-304-VX44W6-300
BCC0EEJ

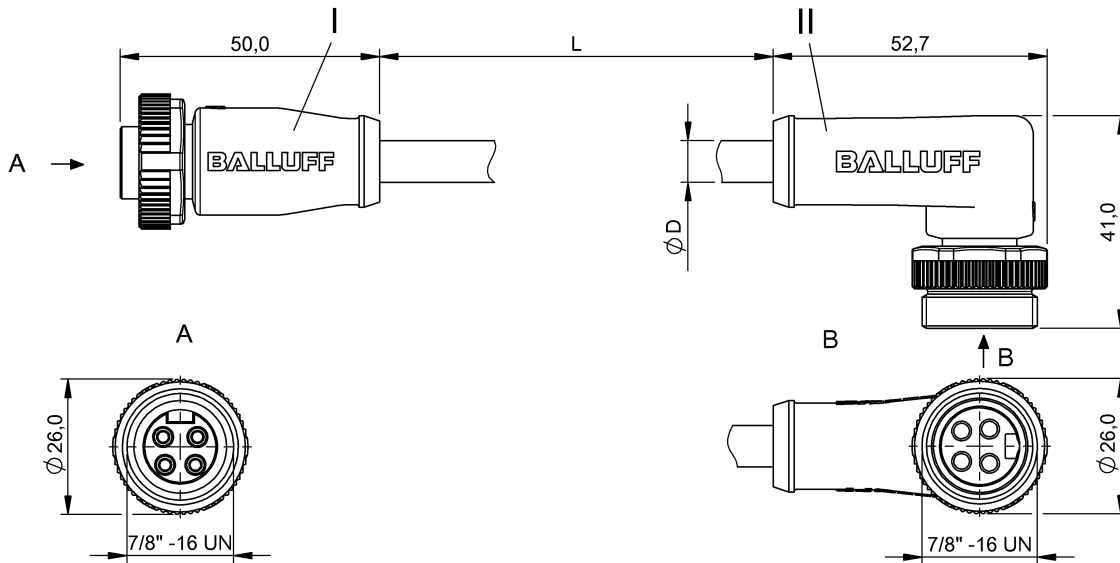

4MT5
(CJV CABLE ASSEMBLY)

Electrical connection

Cable	PVC yellow, 30.00 m
Cable diameter D	10.67 mm \pm 0.25 mm
Conductor cross-section	AWG 16
Number of conductors	4
Number of pins	4/4
System	Molded/Molded

Electrical data

Cable rated voltage AC max.	600.0 V
Cable rated voltage DC max.	600.0 V
Rated current (40 °C)	9.0 A

Environmental conditions

Cable temperature, fixed routing	-40...105 °C
Protection type IEC 60529	IP68 /IP68

General data

Application	Operating voltage
Approval/Conformity	cULus LISTED

Material

Material contact carrier	PUR/PUR
Material contacts	Brass/Brass
Material cover nut	Die-cast zinc/Die-cast zinc
Material grip	TPU/TPU

Mechanical data

Tightening torque pigtail	1.5 Nm/1.5 Nm
---------------------------	---------------

Remarks

Enclosure rating per IEC 60529, only in screwed state with the associated mating piece.
Bulk cable: PVC UL listed, 16/4 ST00W/MaleOOW CSA 105°C 600 V

Connector view

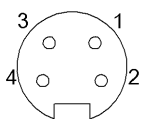

I

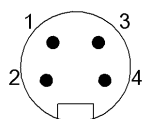

II

BCC A314-A324-30-304-VX44W6-300
BCC0EEJ

Wiring Diagram

