

MALE END VIEW

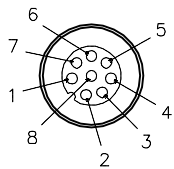

SPECIFICATIONS

CONTACT MATERIAL/PLATING	BRASS/GOLD
HOUSING MATERIAL/COLOR	NYLON/BLACK
COUPLING NUT MATERIAL/FINISH	STAINLESS STEEL/PASSIVATED
RATED CURRENT [A]	2.0 A
RATED VOLTAGE [V]	60 VAC/75 VDC
WIRE SIZE RATING [AWG]	18 AWG MAX
CABLE DIAMETER RANGE	6-8mm
TEMPERATURE RATING	-40°C to +85°C (-40°F to +185°F)
PROTECTION CLASS	IP67
TERMINATION TYPE	SCREW TERMINALS

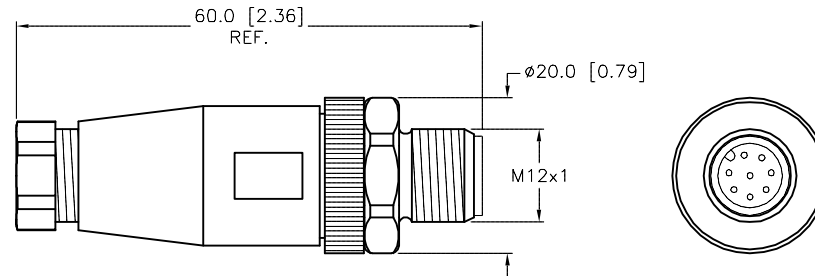

SOURCE DRAWING - FOR REFERENCE ONLY

RELATED DOCUMENTS		3RD ANGLE PROJECTION	THIS DRAWING IS CONFIDENTIAL AND THE PROPERTY OF TURCK INC. USE OF THIS DOCUMENT WITHOUT WRITTEN PERMISSION IS PROHIBITED.	 3000 CAMPUS DRIVE MINNEAPOLIS, MN 55441 1-800-544-7769 (763) 553-7300 (763) 553-0708 fax turck.com			
1.				DRFT	CK	DATE	04/13/11
2.		ALL DIMENSIONS DISPLAYED ON THIS DRAWING ARE FOR REFERENCE ONLY	APVD		SCALE	1=1.0	
3.			CONTACT TURCK FOR MORE INFORMATION	UNIT OF MEASUREMENT		IDENTIFICATION NO.	
4.		MILLIMETER [ INCH ]				U2-18721	
MATERIAL	SEE SPECIFICATIONS	DO NOT SCALE THIS DRAWING		FILE: U2-18721		SHEET 1 OF 1	
FINISH	SEE SPECIFICATIONS						

B	UPDATE SPECIFICATIONS	RDS	04/04/14	45380
REV	DESCRIPTION	BY	DATE	ECO NO.