

## C49 T4C-00-PB-050M BPI002K

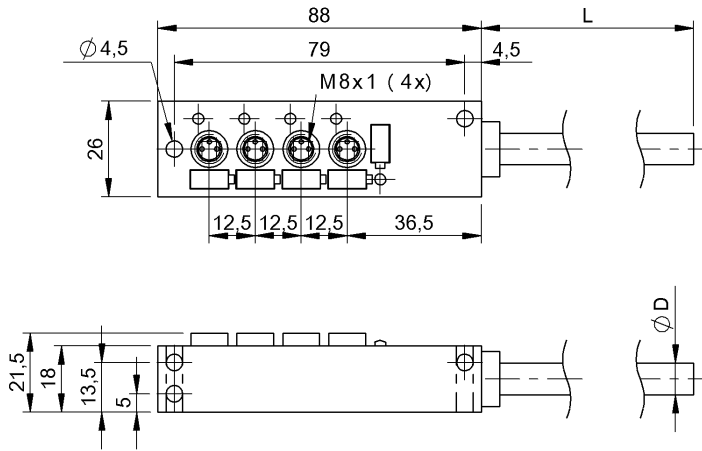

### Electrical connection

Bending radius min., fixed cable	10 x D
Conductor cross-section	0.34 mm <sup>2</sup> + 0.75 mm <sup>2</sup>
Number of conductors	6

### Electrical data

Operating voltage $U_b$	10...30 VDC
Output current max.	2 A

Total current max. 6 A

### Material

Housing material PBT

### Mechanical data

Dimension 88 x 21.5 x 26 mm  
Fastening detail M4 (2x)

### Connector view

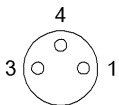

PIN 1: +24V PIN 3: 0V PIN 4: Input/Output 1

C49 T4C-00-PB-050M  
BPI002K

## Wiring Diagram

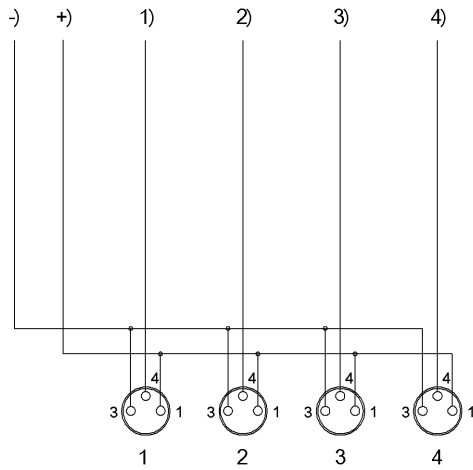

-) blue 0.75 mm<sup>2</sup>+) brown 0.75 mm<sup>2</sup>1) white2) green3) yellow4) gray