

BFO D22-XA-UB-EAK-20-02
BFO0005

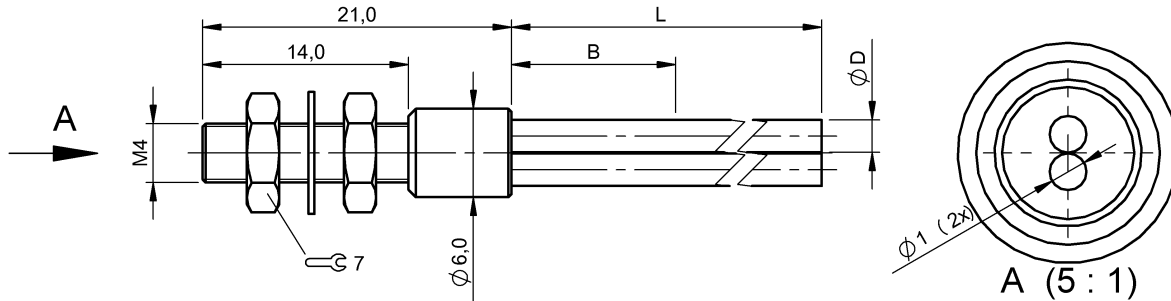

Electrical connection

Cable diameter D	2.20 mm
Cable length	2 m
Cable, note	can be trimmed
Connection type	Cable, 2.00 m, PE

Electrical data

Active surface, fibers	Ø 1.0 mm (2x)
------------------------	---------------

Environmental conditions

Ambient temperature	-55...70 °C
Ambient temperature connection area	Acc. to fiber optic sensor
Protection type IEC 60529	IP65

General data

Basic standard	IEC 60947-5-2
Reference base unit	BFB 75K-001-...
Version	M4, standard

Material

Active surface, fiber arrangement	Adjacent to one another
Fiber type material	PMMA
Housing material	Stainless steel (1.4305)
Material jacket	PE

Mechanical data

Cable, bending radius min.	25 mm
Dimension	Ø 6 x 22 mm
Fastening detail	Nut M4
Fiber optic cable, structure	Single fiber in plastic jacket
Tensile load max. at 20 °C	6 N (max. 3s)

Optical data

Principle of optical operation	Retroreflective sensor
--------------------------------	------------------------

Range/Distance

Effective operating distance Sr	150 mm
Range	150 mm
Rated operating distance Sn	150 mm

Remarks

The cutting tool is included in the scope of delivery order other accessories separately.
Cut cable to length: use suitable cutting tool. Make a single cut, vertical to cable axis. The cut quality can affect the switching distance.
Reference object (target): gray card, 200 x 200, 90 % remission, axial approach.
Route fiber optic cable so that no excessive tensile, compression or torsional forces are permitted. Observe permissible bending radiuses. Installation may affect the switching distance.

BFO D22-XA-UB-EAK-20-02
BFO0005

Symbols for Optoelectronic Sensors

