

Professionally approved products. Datasheet

New 5.0mm Screwless 10A 8 Way

RS Stock 874-5499



Dimensions: (mm)

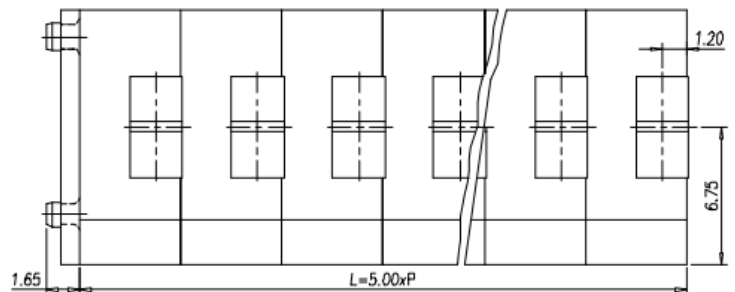
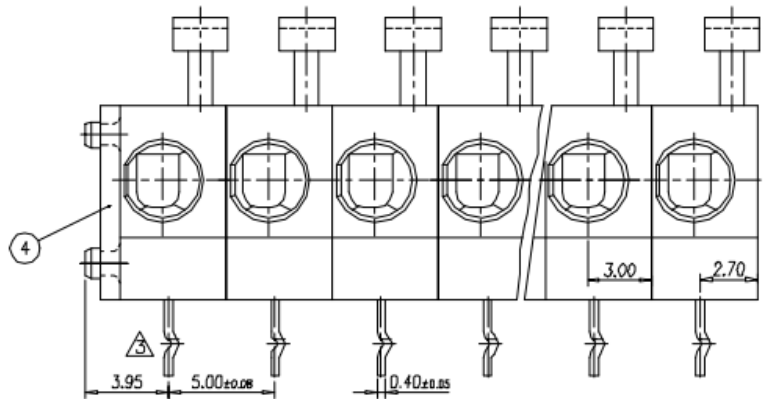
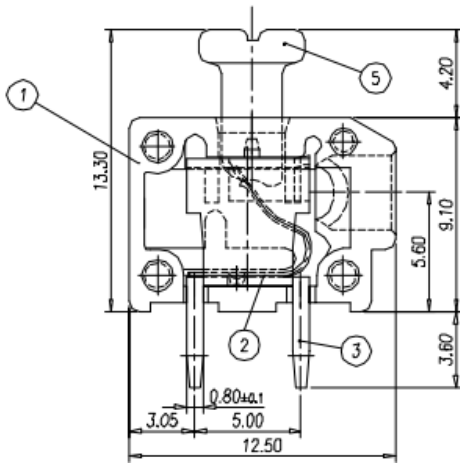

Professionally approved products.

Datasheet

Specifications

- Rated Voltage: 300V 10A (IEC 250V 10A)
- Pitch: 5.00mm
- Insulation Resistance: $\geq 500\Omega\text{M}$ or more at DC500V
- Temperature Range: $-40^{\circ}\text{C} \sim +105^{\circ}\text{C}$
- Suitable Electric Wire: 20~14AWG (IEC 1.5mm²)

Materials

- Housing: PA66
- Clamp: Steel
- Solder Pin: Copper
- End Cover: PA66 (VO)
- Lever: POM

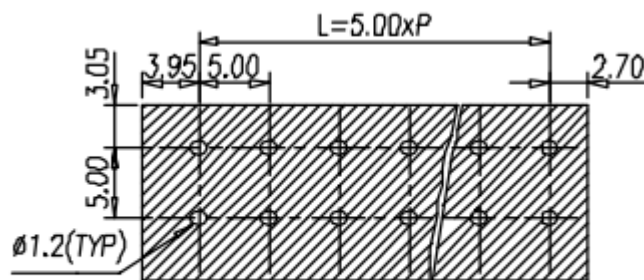

P.C.B. LAYOUT(REF)