

SECTION A-A

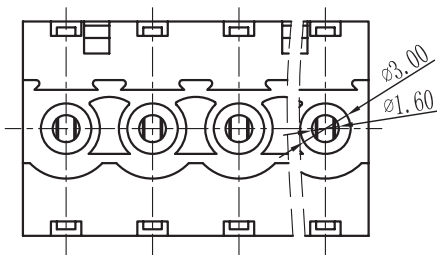

TOLERANCES EXCEPT AS NOTED

variable range	linear dimension				fillet	chamfer	∠ short angle sid			≡	—	□	//	⊥		
	to 6	over 6 to 30	over 30 to 120	over 120 to 480	all to 6	over 6 to 10	over 10 to 50	over 50 to 120	all to 5	over 5 to 30	over 30 to 120	over 120 to 200	to 0.5	to 0.12		
tolerance	±0.1	±0.2	±0.3	±0.5	±0.2	±0.5	±1	1°	30'	20'	10'	0.5	0.025	0.06	0.12	0.4

Electrical

Standard: UL IEC
 Rated voltage: 300V 320V
 Rated current: 15A 20A
 Contact resistance: 20mΩ
 Wire range: 28-14AWG 2.5mm²
 Withstanding voltage: AC2000V/1Min
 Insulation resistance: 500MΩ/DC500V

Mechanical

Temp. Range: -40° C~+105° C
 Torque: 0.5Nm(4.51b`in)
 Strip length: 7-8mm

Dimensions

Pitch: 5.0mm, 5.08mm, 7.62mm
 Poles: 02P-24P

Material

Housing: PA66, UL94V-0
 Screws: M3, steel Zinc plated
 Clamp: Brass, Ni plated
 wire guard: Phosphor bronze, Ni plated

UNITS	mm	SIZE	A4	SCALE	FIRST ANGLE PROJECTION	
					NAME	20.910M/XX-E 21.910M/XX-E 21.961M/XX-E