

REV	DESCRIPTION	DATE
-----	-------------	------

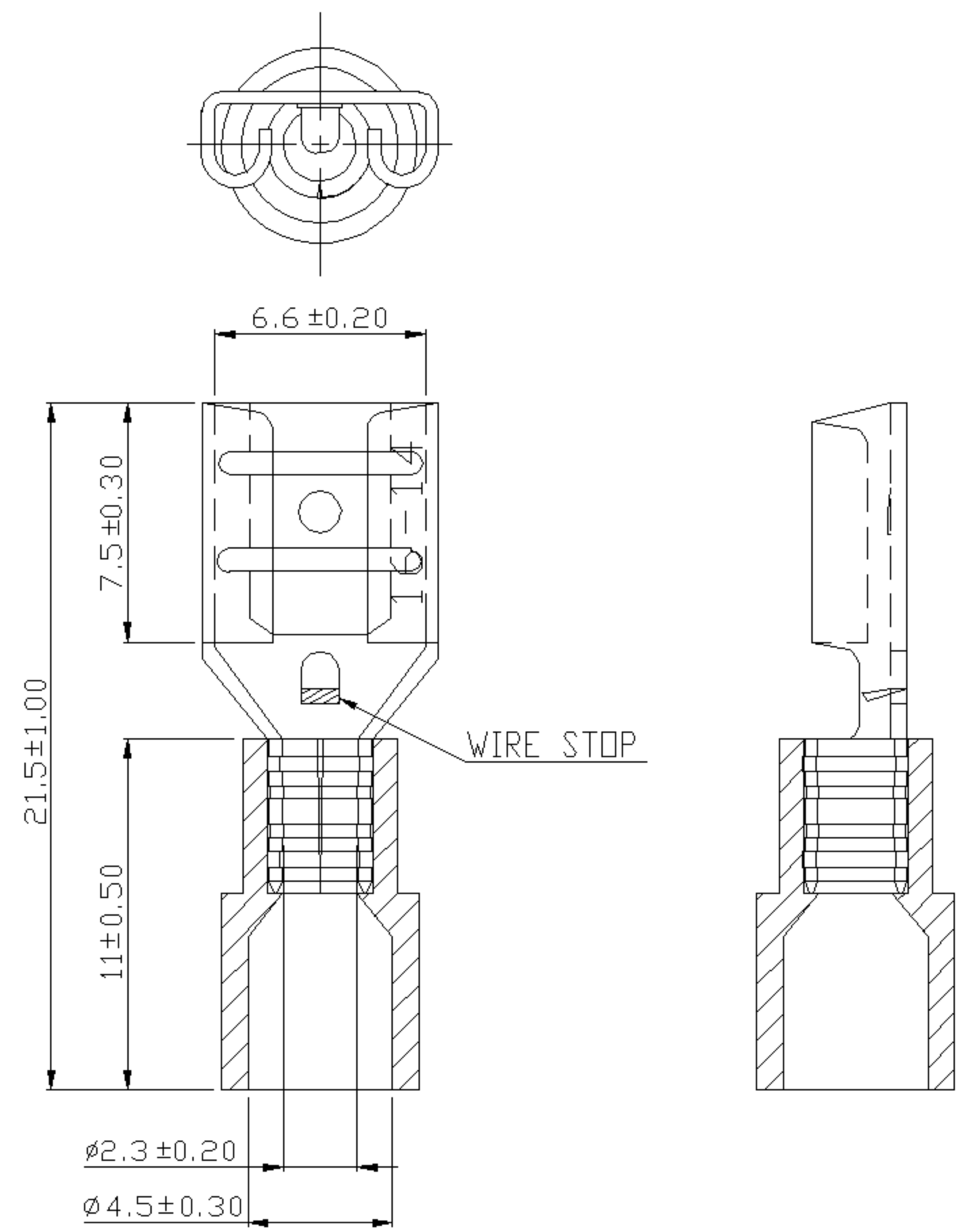

- NOTE:
1. MAXIMUM ELECTRIC CURRENT :

A.W.G.	16	14	
AMP.	10	15	
 2. MAXIMUM ELECTRICAL RATING : 125°C 300 VOLTS MAX.
 3. INSULATION MATERIAL : PC
 4. INSULATION COLOR : BLUE
 5. TERMINAL MATERIAL : BRASS
 6. WIRE RANGE : 16-14 A.W.G.(1.5-2.5 mm²)
 7. TERMINALS SURFACE TREATMENT : TIN PLATED
 8. THICKNESS : 0.40 mm
 9. NEMA TAB : 0.032*0.250 (0.8 * 6.35)

Tolerance Unless Otherwise Specified		
0 > 6 mm	± 0.20	ANGLE
6 > 18 mm	± 0.30	0° ° REF ±
18 > 30 mm	± 0.40	° ° ±
30 > 75 mm	± 0.50	° ° ±

NAME	PC-INSULATED FEMALE DISCONNECTORS			UNIT	mm	
PART NO.	FDNI2-250@	MATERIAL	-----	APPROVE	張馨尹	
NUMBER	KA-95844-C	SCALE	SHEET	PAGE	CHECKED	楊駿考
DATE	2006/07/20	4/1	1-0	20F2	DRAWN	張馨尹