

Professionally approved products.

Datasheet

Multimode Simplex Beige Adaptor

RS Stock number 536-7594



Dimensions: (mm)

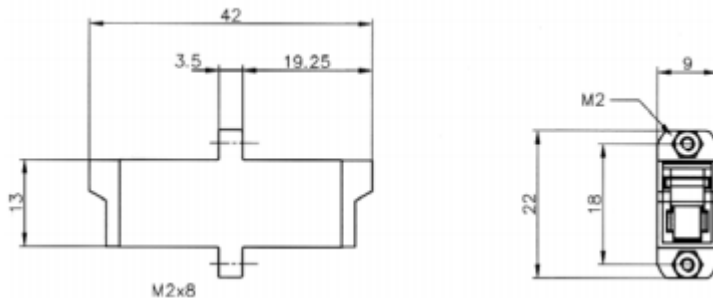

Description

An optical fibre adaptor or uniter is used to mate two connectors together, usually mounted in a distribution wall box. In most cases it is the critical part of the system that aligns the ferrule part of the connectors keeping the fibres in perfect alignment.

Generally there are two types of alignment sleeve within an adaptor, phosphor bronze for multi-mode or zirconia (ceramic) for single mode.

The E2000 connector and adaptor have set the standard for optical fibre interconnect. With a shutter on both the connector and adaptor to prevent laser eye damage the E2000 offers features no other connector can match. The E2000 also has a latched lever mechanism to prevent accidental disconnection.