

För icke direkt toleranssatta mått gäller toleransklass
General tolerances if not otherwise stated

NOM DIM MM		TOL CLASS		
From	To	A	B	C
(1)	6	±0.05	±0.1	±0.2
(6)	30	±0.1	±0.2	±0.5
(30)	100	±0.15	±0.3	±0.8
(100)	300	±0.2	±0.5	±1.2
(300)	1000	±0.3	±0.8	±2

Hål / Holes H13

Skarpa kanter brutna där ej annat anges.
No sharp edges unless otherwise specified.

Övriga generella toleranser enligt ritning 4100-4644.
Additional general tolerances in accordance with drawing 4100-4644.

Rev	Change order	Change: A = Added W = Was D = Deleted	Date	Sign
1	1016546000	4101-2382 ÄNDRAD/CHANGED 4101-2383 ÄNDRAD/CHANGED A 4100-0213	030602	TGW

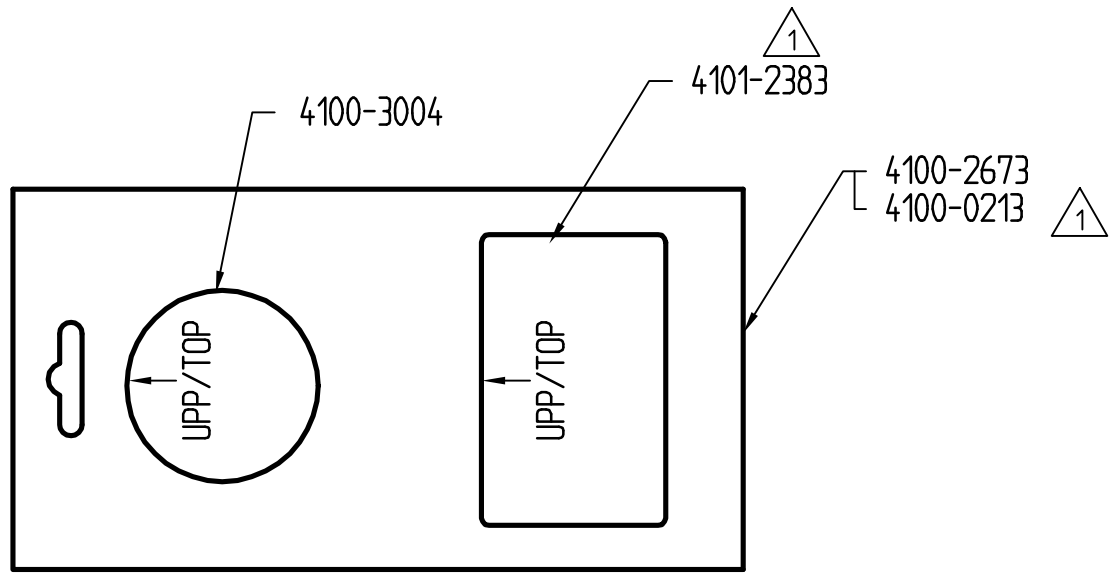
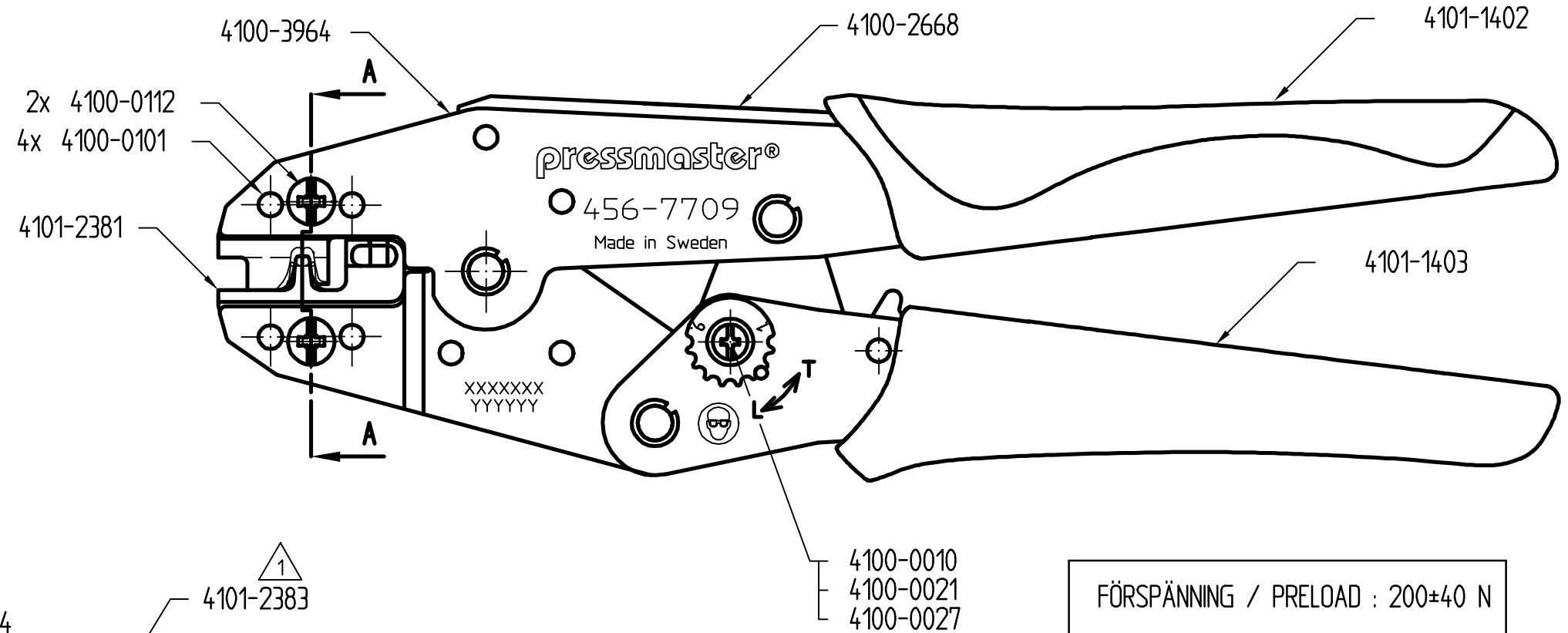
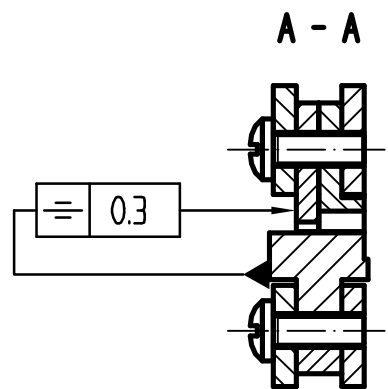
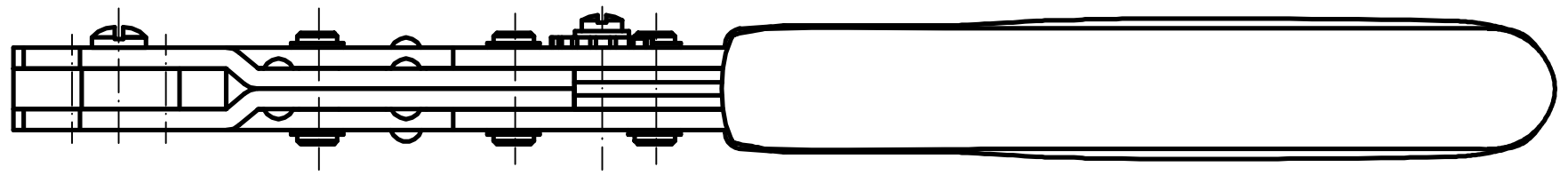

LASERMÄRKT ENLIGT RITNING: 4101-2382
LASERMARKED ACCORDING TO DRAWING: 4101-2382

Denna ritning är Pressmaster AB:s egendom. Skyddad av gällande lag.
This drawing is the property of Pressmaster AB. Protected in accordance with prevailing law.

Material		Behandling/Treatment			Status PreLutc.	
Konstr./Design TGW	Ritad/Drawn TGW	Datum/Date 02-11-18	Skala/Scale 1:1	Kontr./Checked	Godk./Approved	Ämne/Blank
pressmaster®				Vikt/Weight, gram		Art grp 012
Benämning/Denomination KRIMPTÅNG RS Flag Terminals				Ritn nr./Drawing no 43002882		REV 001
REG NR FM13687				CRIMPING TOOL 456-7709		