

**Material**

High impact resistant thermoplastic

**Standard colour**

Black

**Finish**

Matt

**Shaft type**

Complete with clip to fit D-Shaft

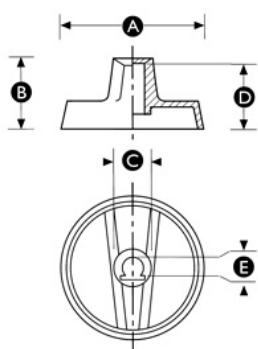

| Part No. | A  | B  | C  | D  | E   | Shaft type | Bore size (mm) |
|----------|----|----|----|----|-----|------------|----------------|
| 2670875  | 40 | 20 | 11 | 18 | 4.6 | D-Shaft    | 6              |