

## Professionally approved products. Datasheet

### Concave 2-part spring probe

RS Stock number [261-5171](#)

Dimensions: (mm)

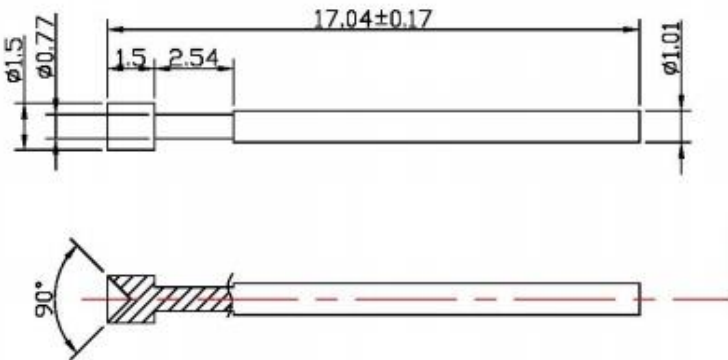

### Specifications

- Plunger: BeCu Rh Plated
- Spring: SuS304 Not Plated
- Barrel: Brass Au Plated
  - (min center) : 1.9mm [0.0748]
  - (full stroke): 3.35mm [0.1319]
  - 2.45mm [0.10]
- Full Stroke Spring Force: + 20% 128g [4.52oz]
- 2/3 Stroke Spring Force: + 20% 90g [3.18oz]
- Current Rating: 3A
- Contact Resistance: 30m Ω
- Recommended Hole Size: Acrylic – 1.35mm [0.0531]  
 Bakelite – 1.40mm [0.0551]  
 Fiber Reinforced Plastic – 1.40mm [0.551]