

s.100/s.101

3-way hot forged 1/4"-2"
brass ball valves



Features and Specifications:

- * **3-way T** (s.100) or **L** (s.101) design allows complete range of flow handling applications,
- * **Hot forged** sand blasted nickel plated brass body and caps,
- * Copper alloy brass according to **EN 12165** and **EN 12164** specifications,
- * **Extra port** for lowest pressure drop,
- * **Teflon®** (Dupont registered trademark) seats,
- * **UNI 8858** cycle and torque tests performed,
- * **Four seats** design limits mixture among various fluids in the system,
- * Chrome plated brass ball for **longer life**,
- * **No metal-to-metal** moving parts,
- * Two Viton O-rings at the stem for **maximum safety**,
- * **ISO 228** Female threads,
- * 25 bar (Kg/cm²) non-shock cold working **pressure**,
- * -10°C +120°C **temperature** (Warning: freezing of the fluid in the installation may severely damage the valve).

s.100 3-way T port

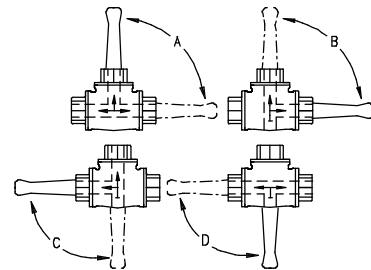

s.101 3-way L port

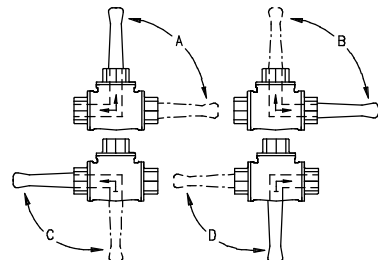

The product described in this document meets the requirements of PED Directive 97/23 and according to art.3 par.3, it does not require CE marking;

it cannot be used with dangerous gases in sizes larger than 25mm;

it cannot be used with non-dangerous gases in sizes larger than 40mm.



Fax+39 030 2629498
 Phone+39 030 212441
<http://www.rubvalves.com>
 email: sales@rubvalves.com

RUBINETTERIE UTENSILERIE BONOMI SRL

VIA PADANA SUPERIORE, 27/29 - FRAZ. CILIVERGHE, 25080 MAZZANO (BS) - ITALY

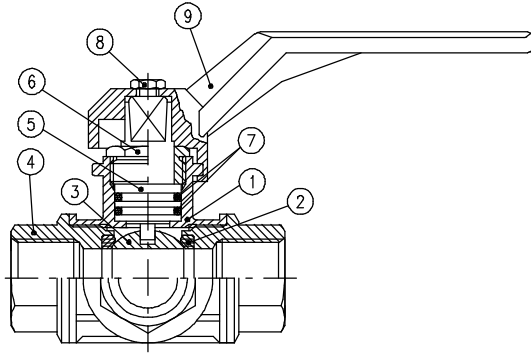

PART DESCRIPTION		Material	Q.ty
1	Nickel plated body	CW617N	1
2	Seat	Ptfe	4
3	Chrome plated ball	CW617N	1
4	Nickel plated end cap	CW617N	3
5	Nickel plated stem O-Ring design	CW614N	1
6	Nickel plated nut	CW614N	1
7	O-Ring	Viton	2
8	Screw	Steel	1
9	Red handle	Aluminium	1

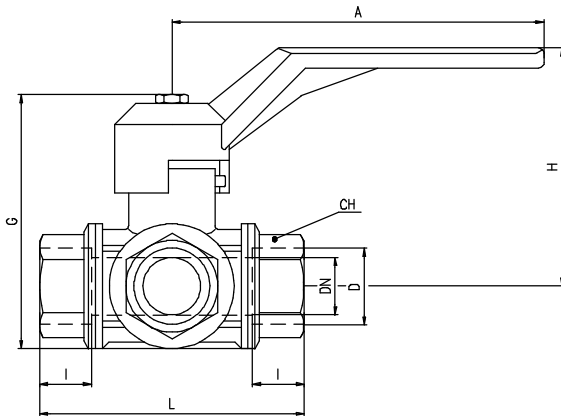

Code	100B00	100C00	100D00	100E00	100F00	100G00	100H00	100I00
	101B00	101C00	101D00	101E00	101F00	101G00	101H00	101I00
D (inch)	1/4	3/8	1/2	3/4	1	1 1/4	1 1/2	2
DN (mm)	10	12	14	18	23	29	36	45
I (mm)	19	19	19	23	25	27	31	36
L (mm)	77	77	77	92	104	118	138	162
G (mm)	75	75	75	91	105	115	128	165
A (mm)	125	125	125	145	170	170	170	260
H (mm)	65	65	65	83	96	102	109	139
CH (mm)	22	22	22	27	34	50	57	70

Pressure -Temperature chart

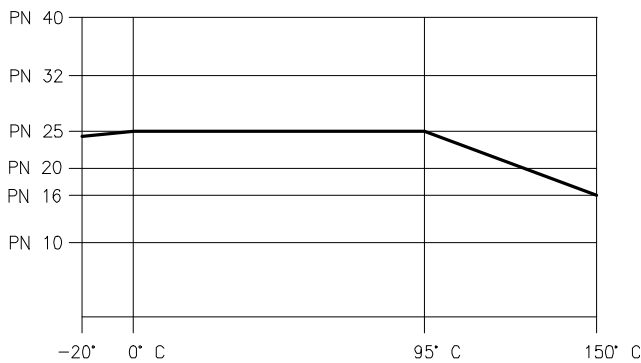

Pressure drop chart

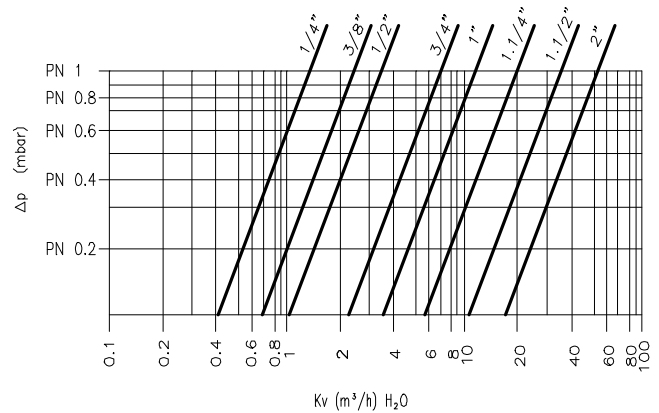

Ask for additional information on the whole range of **RuB** valves
 and consult with your supplier for special applications.

