

ENCLOSURE FOR COMMAND DEVICES, 22MM, ROUND, ENCLOSURE MATERIAL PLASTIC, ENCLOSURE TOP PART YELLOW, 1 COMMAND POINT PLASTIC, WITH PROTECTIVE COLLAR, A=EM. STOP MUSH. PUSHB. RED, 40MM, ROTATE TO UNLATCH, 1NC, SCREW TERMINAL, BASE MOUNTING,



Figure similar

product brand name	SIRIUS ACT
Product designation	Commanding and signaling devices
Design of the product	Enclosure
Manufacturer article number	<ul style="list-style-type: none"> • of supplied contact module at the command point A 1 3SU1400-2AA10-1CA0 • of the supplied holder at the command point A 3SU1500-0AA10-0AA0 • of the supplied actuator at the command point A 3SU1000-1HB20-0AA0 • of supplied empty enclosure 3SU1801-0AA00-0AC2

Enclosure:	
Design of the housing	with protective collar
Shape of the enclosure front	Square
Material of the enclosure	plastic
Number of command points	1
Product component	
<ul style="list-style-type: none"> • EMERGENCY STOP device • protective collar 	No
Color	No

<ul style="list-style-type: none"> • of top part of the enclosure 	yellow
Delivery state	
<ul style="list-style-type: none"> • as a kit 	No
<ul style="list-style-type: none"> • pre-wired on strip terminal 	No
Mounting type of the enclosure	Vertical

Actuator:

Product feature	
<ul style="list-style-type: none"> • lockout 	No
Product expansion optional Light source	No
Color	
<ul style="list-style-type: none"> • of the actuating element 	Red
Material of the actuating element	plastic
Shape of the actuating element	round
Number of contact modules	1

Front ring:

Product component front ring	No
Design of the front ring	Standard

Holder:

Material of the holder	Plastic
-------------------------------	---------

Display:

Number of LED modules	0
------------------------------	---

General technical data:

Product function	
<ul style="list-style-type: none"> • positive opening 	Yes
<ul style="list-style-type: none"> • EMERGENCY OFF function 	Yes
<ul style="list-style-type: none"> • EMERGENCY STOP function 	Yes
Protection class IP	IP66, IP67, IP69(IP69K)
Shock resistance	
<ul style="list-style-type: none"> • acc. to IEC 60068-2-27 	Sinusoidal half-wave 50 g / 11 ms
<ul style="list-style-type: none"> • for railway applications acc. to DIN EN 61373 	Category 1, Class B
Vibration resistance	
<ul style="list-style-type: none"> • acc. to IEC 60068-2-6 	10 ... 500 Hz: 5g
<ul style="list-style-type: none"> • for railway applications acc. to DIN EN 61373 	Category 1, Class B
Equipment marking	
<ul style="list-style-type: none"> • acc. to DIN EN 61346-2 	S
<ul style="list-style-type: none"> • acc. to DIN EN 81346-2 	S
Design of the fuse link for short-circuit protection of the auxiliary switch with type of assignment 1 required	gG / Dz 10 A, quick-acting / Dz 10 A
Continuous current of the C characteristic MCB	10 A

Auxiliary circuit:	
Design of the contact of the auxiliary contacts	Silver alloy
Number of NC contacts	1
<ul style="list-style-type: none"> • for auxiliary contacts 	
Number of NO contacts	0
<ul style="list-style-type: none"> • for auxiliary contacts 	
Number of CO contacts	0
<ul style="list-style-type: none"> • for auxiliary contacts 	

Connections/ Terminals:	
Type of electrical connection	Screw-type terminal
<ul style="list-style-type: none"> • of modules and accessories 	
Type of electrical connection on enclosure	Cable routing above and below, both 1 x M20
Tightening torque	0.8 ... 0.9 N·m
<ul style="list-style-type: none"> • with screw-type terminals 	

Interfaces:	
Design of the interface	without
<ul style="list-style-type: none"> • for communication 	

Ambient conditions:	
Ambient temperature	-25 ... +70 °C
<ul style="list-style-type: none"> • during operation 	
<ul style="list-style-type: none"> • during storage 	-40 ... +80 °C
Environmental category during operation acc. to IEC 60721	3K6, 3C3, 3S2, 3M6

Installation/ mounting/ dimensions:	
Mounting type	Floor mounting
<ul style="list-style-type: none"> • of modules and accessories 	
Height	85 mm
Width	85 mm
Depth	112.5 mm
Shape of the installation opening	round

Accessories:	
Number of labels	0
Marking of the name plate for command devices	A = I

Certificates/ approvals:	
Declaration of Conformity	other



[Bestätigungen](#)

Further information

Information- and Downloadcenter (Catalogs, Brochures,...)

<http://www.siemens.com/industrial-controls/catalogs>

Industry Mall (Online ordering system)

<http://www.siemens.com/industrymall>

Cax online generator

<http://support.automation.siemens.com/WW/CAXorder/default.aspx?lang=en&mlfb=3SU18010NA002AC2>

Service&Support (Manuals, Certificates, Characteristics, FAQs,...)

<https://support.industry.siemens.com/cs/ww/en/ps/3SU18010NA002AC2>

Image database (product images, 2D dimension drawings, 3D models, device circuit diagrams, EPLAN macros, ...)

http://www.automation.siemens.com/bilddb/cax_de.aspx?mlfb=3SU18010NA002AC2&lang=en

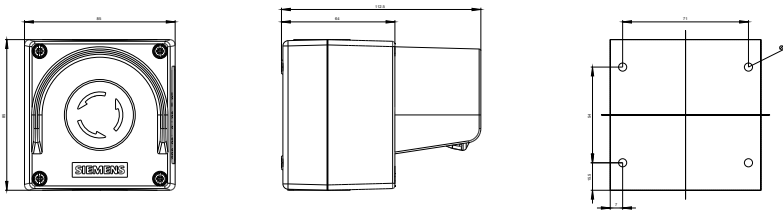

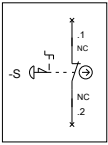

SIEMENS

3SU18.1.NA0_01_4_IEC.DXF

last modified:

25.08.2015