

För icke direkt toleranssatta mått gäller toleransklass

General tolerances if not otherwise stated

NOM DIM MM		TOL CLASS		
From	To	A	B	C
(1)	6	±0.05	±0.1	±0.2
(6)	30	±0.1	±0.2	±0.5
(30)	100	±0.15	±0.3	±0.8
(100)	300	±0.2	±0.5	±1.2
(300)	1000	±0.3	±0.8	±2

Hål / Holes H13

Skarpa kanter brutna där ej annat anges.
No sharp edges unless otherwise specified.

LASERMÄRKNING/LASER MARKING:
 TEXTFONT: GEN-ISO
 Datumkod / Date code "YYYYYY"
 Serienummer / Serial number "XXXXXXX"

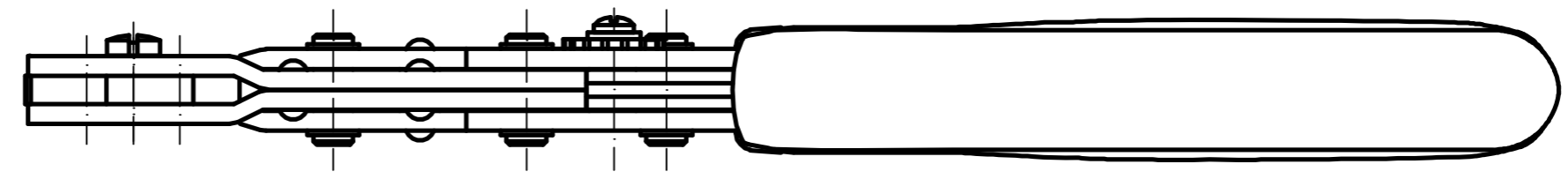

Övriga generella toleranser enligt ritning 4100-4644.
 Additional general tolerances in accordance with drawing 4100-4644.

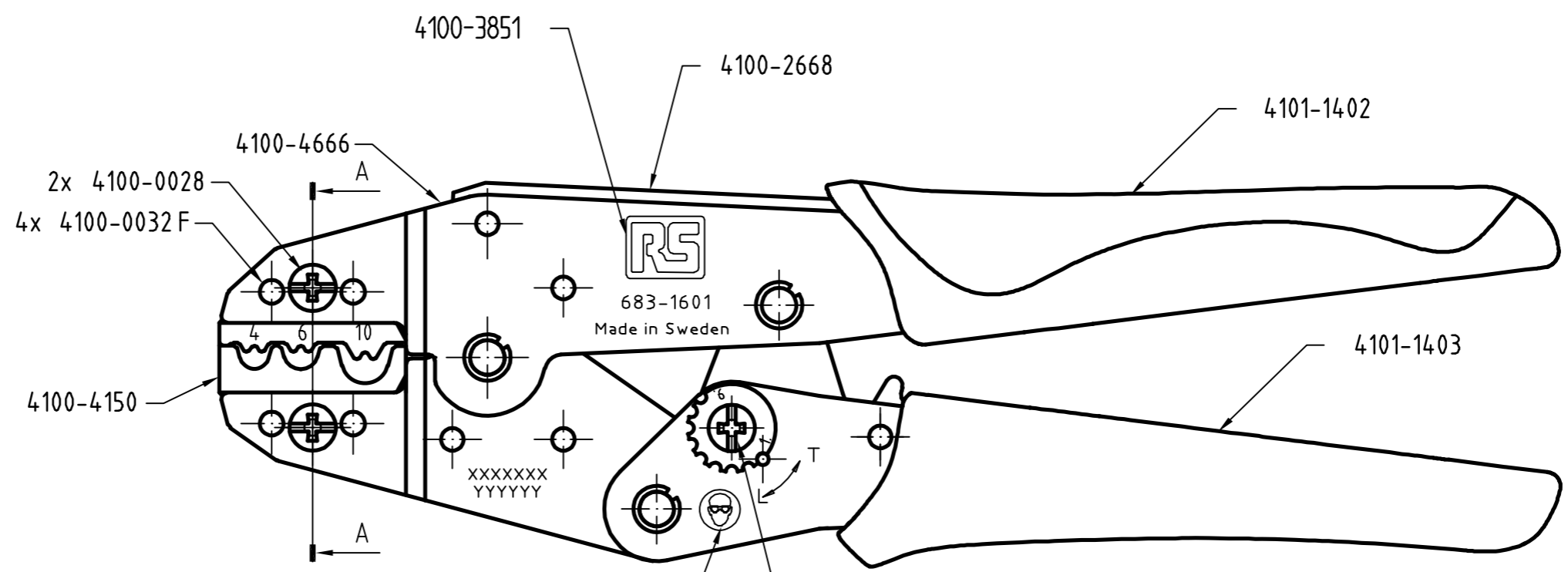
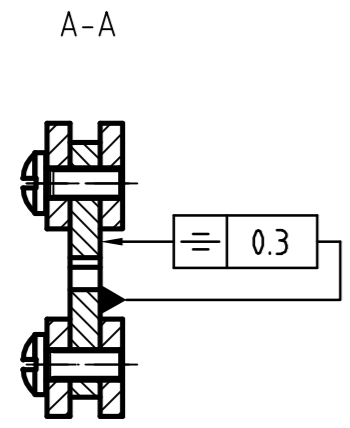

- 4101-2610
- 4101-2614
- 4100-3776
- 4101-6494 C - placering position B

Packas enligt förpackningsritning 4101-2725
 Packed according to drawing 4101-2725

FÖRSPÄNNING / PRELOAD: 200 ± 40 N

Tolkmått / Gauge dimensions (mm)		
URTAG NEST	Gåtolk GO	Stopptolk NO GO
4	∅3.05	∅3.30
6	∅3.03	∅3.28
10	∅3.85	∅4.10

Denna ritning är Pressmaster AB:s egendom. Skyddad av gällande lag.
 This drawing is the property of Pressmaster AB. Protected in accordance with prevailing law.

Material		Behandling/Treatment			Status Work.etc.	
Konstr./Design SE	Ritad/Drawn SE	Datum/Date 2009-05-18	Skala/Scale 1:1	Kontr./Checked	Godk./Approved	Änne/Blank
pressmaster ®			Benämning/Denomination KRIMPVERKTYG 683-1601 CRIMPING TOOL		Vikt/Weight,gram 0.620 g	Art grp 012
ISO 9001 REG NR FM1367			Ritn nr/Drawing no 43003716		REV 000	