

## M12-Receptacle Connectors In Accordance With IEC 61076-2-101

### FWD 5 | FWD 5B



### Male, 5-Pole

Receptacle connector, combined FIXCON/M12 male connector to combined FIXCON/M12 female connector.

– especially designed for use as panel feed through –

### FWD 5 | FWD 5B

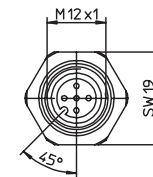
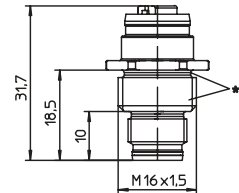
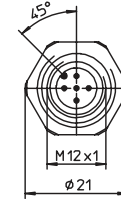

## Pin Assignments

### Face Views / M12

#### Male Connector : 5 poles



#### Female Connector: 5 poles



#### Male Connector: 5 poles B Coding



#### Female Connector: 5 poles B Coding





**M12-Receptacle Connectors In Accordance With IEC 61076-2-101**  
FWD 5 | FWD 5B

**Technical Data**

**Environmental**

Degree of protection	IP 67 / NEMA 6P
Operating temperature range	-25°C (-13°F) / +80°C (+176°F)

**Mechanical**

Housing / Molded body	CuZn, nickel-plated
Insert Male connector	PA 6.6
Insert Female connector	TPU, self-extinguishing
Contact	CuZn, pre-nickel and 0.8 microns gold-plated
O-ring	FKM

**Electrical**

Contact resistance	≤ 5 mΩ
Nominal current at 40°C	4 A
Nominal voltage	60 V
Test voltage	1.5 kV eff. / 60 s
Insulation resistance	> 10 <sup>9</sup> Ω
Pollution degree	3

Part Number	Pins	Characteristics
FWD 5	5	
FWD 5B	5B	