



SERIES 1900 - SMALLEST SINGLE-POLE ROCKER SWITCHES

TO 6 (2) A 250 V AC



PRODUCT FEATURES

- Reliable leaf spring contact system with contact spacing ≥ 3 mm
- Attractive, slim design
- Three sizes
- Low space requirement due to small sizes

ON REQUEST

- Other colors
- Other printing variants
- Cable assembly

Mechanical life endurance	75E3
Operating force	2 - 5 N
Contact resistance (new condition)	< 100 mOhm (1 A 12 V DC)
Insulation resistance (new condition)	> 100 MOhm (500 V DC)
Proof tracking	250 PTI
Protection type	IP 40
Ambient temperature	terminal side -20 °C ... +85 °C actuating side -20 °C ... +55 °C
Flammability	UL 94 V-2
Glow wire test temperature	850 °C
Material actuator housing terminals	PA PA silver plated
Plug force of the terminals	≤ 80 N
Approval marks	
Suitable for appliances of protection class II	



SERIES 1900 - SMALLEST SINGLE-POLE ROCKER SWITCHES

TO 6 (2) A 250 V AC

 single-pole	Actuator color / printing	Housing color	6 (2) A 250 V AC 1E4	4 (1) A 250 V AC 5E4	30 mA 12 V DC 5E4	6 A 125 - 250 V AC 1/8 HP	Terminal type	Terminal description	Contact distance (mm)	Contact material	Miscellaneous	Stock version
	ON / OFF switch (SPST)											
1901.1102		Black	○	○		○		4.8	≳ 3	Ag		○
1901.1103		Black	○	○		○		4.8	≳ 3	Ag		○
1901.1106		White	○	○		○		4.8	≳ 3	Ag	rocker marking silver	
1911.1102		Black	○	○		○		4.8	≳ 3	Ag		○
1911.1104		Black	○	○		○		4.8	≳ 3	Ag		
1921.1101		White	○	○		○		4.8	≳ 3	Ag		
1921.1102		Black	○	○		○		4.8	≳ 3	Ag		○
1901.1152		Black			○			4.8	≳ 3	Au		



Basic type 1901
single-pole

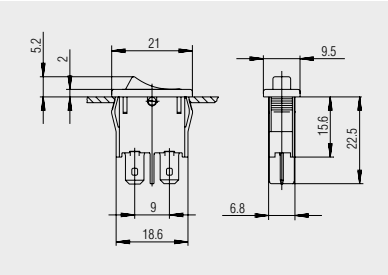

 Quick-connect terminal 4.8 x 0.8

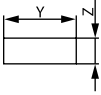

X = Wall thickness

x	y	z
0.75 ... 1.25	19.2 ^{-0.1}	6.8 ^{+0.1}
1.25 ... 2	19.4 ^{-0.1}	6.8 ^{+0.1}
2 ... 3	19.8 ^{-0.1}	6.8 ^{+0.1}

ROCKERSWITCHES
 PUSHBUTTON SWITCHES
 TOGGLE SWITCHES
 SLIDE SWITCHES
 ROTARY SWITCHES
 FOOT SWITCHES
 TACT AND KEY SWITCHES
 SMP-ACTION SWITCHES
 MICRO-SIGNAL SWITCHES
 SENSORS
 ECO
 PUSH N' DRIVE



SERIES 1900 - SMALLEST SINGLE-POLE ROCKER SWITCHES

TO 6 (2) A 250 V AC

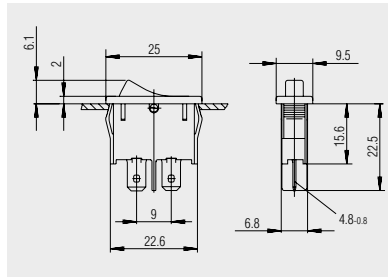

Basic type 1911
single-pole

 Quick-connect terminal 4.8 x 0.8

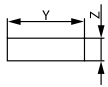

X = Wall thickness

x	y	z
0.75 ... 1.25	23.2 ^{-0.1}	6.8 ^{+0.1}
1.25 ... 2	23.4 ^{-0.1}	6.8 ^{+0.1}
2 ... 3	23.8 ^{-0.1}	6.8 ^{+0.1}

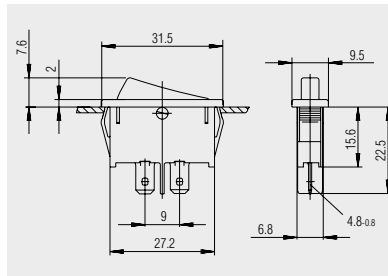

Basic type 1921
single-pole

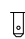
 Quick-connect terminal 4.8 x 0.8

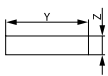

X = Wall thickness

x	y	z
0.75 ... 1.25	30 ^{-0.1}	6.8 ^{+0.1}
1.25 ... 2	30.2 ^{-0.1}	6.8 ^{+0.1}
2 ... 3	30.6 ^{-0.1}	6.8 ^{+0.1}