



SERIES 1820 - SINGLE AND DOUBLE-POLE TOGGLE SWITCHES

TO 6 (4) A 250 V AC





PRODUCT FEATURES

- 100 million times proven switching principle
- Long life endurance with 50 000 mechanical switching cycles
- Excellent actuating characteristic
- Fastening with nut M12

ON REQUEST

- Other colors
- Other switching functions
- Other terminal variants
- Cable assembly

Mechanical life endurance	5E4
Contact resistance (new condition)	< 100 mOhm (1 A 12 V DC)
Insulation resistance (new condition)	> 100 MOhm (500 V DC)
Proof tracking	250 PTI
Protection type	IP 40
Ambient temperature	terminal side -20 °C ... +100 °C actuating side -20 °C ... +55 °C
Flammability	UL 94 V-2
Glow wire test temperature	850 °C
Material actuator housing terminals	PA PA glass fiber-reinforced / PA silver plated
Plug force of the terminals	≤ 80 N
Approval marks	 /  / 
Suitable for appliances of protection class II	



SERIES 1820 - SINGLE AND DOUBLE-POLE TOGGLE SWITCHES

TO 6 (4) A 250 V AC

 single-pole	Actuator color / printing	Housing color	6 (4) A 250 V AC 5E4	6 (2) A 250 V AC 1E4	6 A 250 V AC 1/2 HP	6 A 125 V AC 1/4 HP	Terminal type	Terminal description	Contact distance (mm)	Contact material	Miscellaneous	Stock version
	ON / OFF switch (SPST)											
1821.1101			<input type="radio"/>	<input type="radio"/>	<input type="radio"/>	<input type="radio"/>		4.8	≥ 3	Ag		<input type="radio"/>
1821.6101			<input type="radio"/>	<input type="radio"/>	<input type="radio"/>	<input type="radio"/>			≥ 3	Ag		<input type="radio"/>
Changeover switch (SPDT)												
1823.1101			<input type="radio"/>	<input type="radio"/>	<input type="radio"/>	<input type="radio"/>		4.8	≥ 3	Ag		<input type="radio"/>
1823.6101			<input type="radio"/>	<input type="radio"/>	<input type="radio"/>	<input type="radio"/>			≥ 3	Ag		<input type="radio"/>
Changeover switch with OFF position in the center (SPDT - Center OFF)												
1828.1101			<input type="radio"/>	<input type="radio"/>	<input type="radio"/>	<input type="radio"/>		4.8	< 3	Ag		<input type="radio"/>
1828.1201			<input type="radio"/>	<input type="radio"/>	<input type="radio"/>	<input type="radio"/>		4.8	< 3	Ag	momentary function one side	<input type="radio"/>
1828.1301			<input type="radio"/>	<input type="radio"/>	<input type="radio"/>	<input type="radio"/>		4.8	< 3	Ag	momentary function both sides	<input type="radio"/>

 double-pole	Actuator color / printing	Housing color	6 (4) A 250 V AC 5E4	6 (2) A 250 V AC 1E4	6 A 250 V AC 1/2 HP	6 A 125 V AC 1/4 HP	Terminal type	Terminal description	Contact distance (mm)	Contact material	Miscellaneous	Stock version
	ON / OFF switch (DPST)											
1822.1101			<input type="radio"/>	<input type="radio"/>	<input type="radio"/>	<input type="radio"/>		4.8	≥ 3	Ag		<input type="radio"/>
Changeover switch (DPDT)												
1824.1101			<input type="radio"/>	<input type="radio"/>	<input type="radio"/>	<input type="radio"/>		4.8	≥ 3	Ag		<input type="radio"/>
Changeover switch with OFF position in the center (DPDT - Center OFF)												
1829.1101			<input type="radio"/>	<input type="radio"/>	<input type="radio"/>	<input type="radio"/>		4.8	< 3	Ag		<input type="radio"/>
1829.1301			<input type="radio"/>	<input type="radio"/>	<input type="radio"/>	<input type="radio"/>		4.8	< 3	Ag	momentary function both sides	<input type="radio"/>

ROCKERSWITCHES

PUSHBUTTON SWITCHES

TOGGLE SWITCHES

SLIDE SWITCHES

ROTARY SWITCHES

FOOT SWITCHES

TACT AND KEY SWITCHES

SNAP-ACTION SWITCHES

MICRO-SIGNAL SWITCHES

SENSORS

ECO

PUSH'N'DRIVE



SERIES 1820 - SINGLE AND DOUBLE-POLE TOGGLE SWITCHES

TO 6 (4) A 250 V AC



Basic types 1821, 1823 and 1828
single-pole

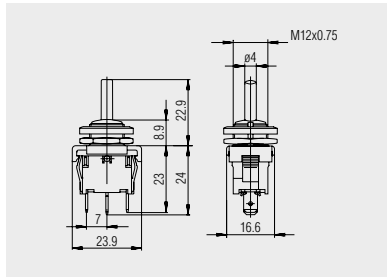

Quick-connect terminal 4.8 x 0.8
basic type 1828

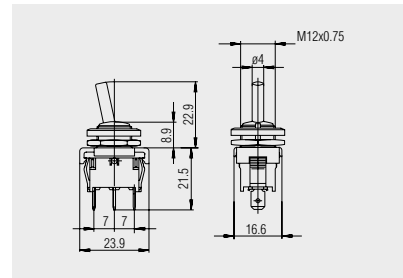

Quick-connect terminal 4.8 x 0.8
basic types 1821 and 1823

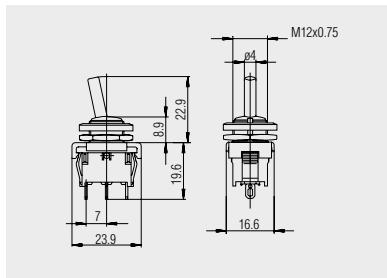

Solder terminal
1821.6101 and 1823.6101



Basic types 1822, 1824 and 1829
double-pole

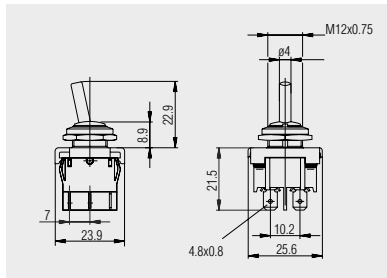

Quick-connect terminal 4.8 x 0.8
basic type 1822 and 1824

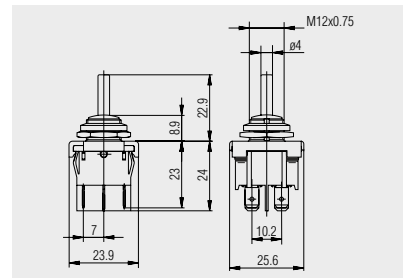

Quick-connect terminal 4.8 x 0.8
basic type 1829



Identification plate
240.001.011

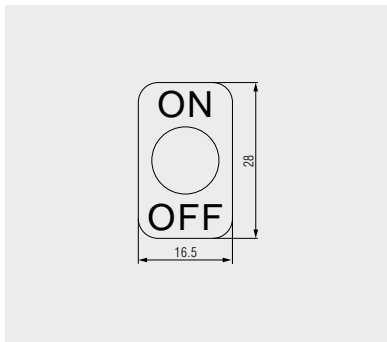

Aluminum identification plate to
plugging on and with black inscription
"ON" and "OFF"

ROCKER SWITCHES
PUSHBUTTON SWITCHES
TOGGLE SWITCHES
SLIDE SWITCHES
ROTARY SWITCHES
FOOT SWITCHES
TACT AND KEY SWITCHES
SNAP-ACTION SWITCHES
MICRO-SIGNAL SWITCHES
SENSORS
ECO
PUSH 'N' DRIVE



SERIES 1820 - SINGLE AND DOUBLE-POLE TOGGLE SWITCHES

TO 6 (4) A 250 V AC



Identification plate
240.002.011

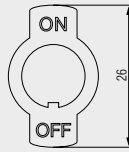

Identification plate made of CuZn nickel-plated for plugging on as well as with twist protection and stamped inscription "ON" and "OFF"



Protection cap
343.001.013 - green
343.001.023 - black
343.001.033 - red

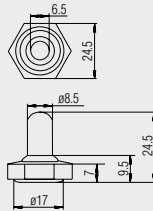

Neopren®-cap for screwing on (M12 x 0.75) to levers of the series 1820 for dust and water protection of the actuator side



Lever receptacle
203.105.011 - black
203.105.021 - white
203.105.031 - red
203.105.041 - green

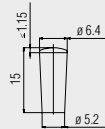

Lever receptacle in various colors for the plastic levers of the 1820 series for customer assembly. Serves as a design element and for distinguishing and marking.

VERTRAULICH-CONFIDENTIAL

© Alle Rechte bei Marquardt, auch fuer den Fall von Schutzrechtsanmeldungen. Jede Veruegungsbefugnis, wie Kopier- und Weitergaberecht, bei uns.
 © This document is the exclusive property of Marquardt. Without our consent, it may not be reproduced or given to third parties.

Muttern lose beigelegt
 nuts loose added

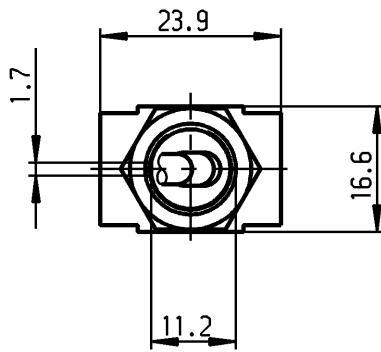
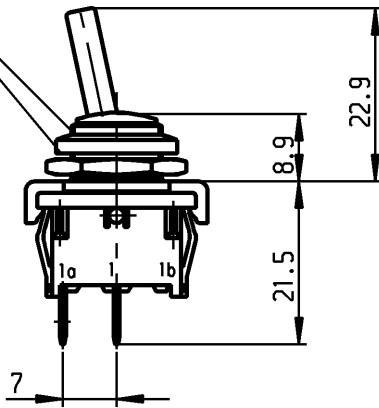

M12x0.75



schwarz
black

schwarz
black

Flachstecker oehnl.
 plug-in sim.
 DIN 46 244-A4.8-0.8

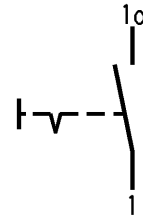

**Aufschrift
 Marking**



1821.

6(4)/250~5E4 T100/55



6A 125-250V AC

1/4HP 125V AC

1/2HP 250V AC

R30

Ausschalter 1-polig

Für Gerate der Klasse II geeignet

SPST

suitable for appliances of class II

Herstellort /-jahr/-woche nach DIN EN 60062

date of manufacture: place/year/week acc. to DIN EN 60062

Diese Unterlage ist geistiges Eigentum der Firma Marquardt. Schutzvermerk nach DIN 34 beachten. Copyright reserved.

Für Form und Lage FOR SHAPE AND LOC. Für Winkel FOR ANGLE ± 2°		ALLgemeintoleranzen UNTOLERANCED DIMENSIONS		Pause COPY		Blatt SHEET 01 Original DIN A4 Maßstab SCALE 1:1		Typ K Zeichn./DRAWING NO. 1821.1101 Index	
PROJECTION		Abmasse und Nennmassbereiche Angaben in mm ALL DIMENSIONS ARE IN MILLIMETRES		Laengen LENGTH Radien RADII		0 10 20 30 mm		Gerateschalter appliance switch	
c 56042 21.01.08 vor		g		CAD Medusa Z		gez./DRAWN BY 15.11.00B.Zim		MARQUARDT Marquardt, D-78604 Riethem-Weilheim	
b 29868 15.11.00 B.Zim		f		gez./DRAWN BY		gepr./CHECKED BY		Ersatz für/REPLACEMENT OF Zchnng.qL.Nr.v.06.11.81	
a 16915 11.10.85 Hs		e		d 64505 22.04.10 Mut		Ersatz für/REPLACEMENT OF Zchnng.qL.Nr.v.06.11.81		Ersatz für/REPLACEMENT OF Zchnng.qL.Nr.v.06.11.81	
Ausg. ISSUE		Änderung REVISION		gez. DRAWN BY		Ausg. ISSUE		Änderung REVISION	