



**Model Number**

NJ2-8GM40-E2-V1

**Features**

- 2 mm not embeddable

**Connection**

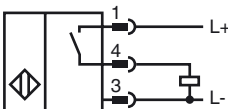

**Pinout**

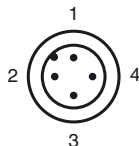

Wire colors in accordance with EN 60947-5-2

1	BN	(brown)
2	WH	(white)
3	BU	(blue)
4	BK	(black)

**Accessories**

- BF 8**  
Mounting flange, 8 mm
- V1-G**  
4-pin, M12 female field-attachable connector
- V1-W-2M-PUR**  
Cable socket, M12, 4-pin, PUR cable
- V1-G-2M-PUR**  
Cable socket, M12, 4-pin, PUR cable
- V1-W**  
4-pin, M12 female field-attachable connector

**Dimensions**

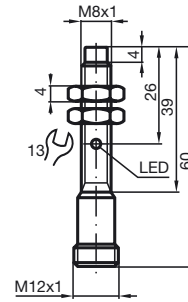

**Technical Data**

**General specifications**

Switching element function	PNP	NO
Rated operating distance	$s_n$	2 mm
Installation	not embeddable	
Output polarity	DC	
Assured operating distance	$s_a$	0 ... 1.62 mm
Reduction factor $r_{Al}$	0.4	
Reduction factor $r_{Cu}$	0.35	
Reduction factor $r_{304}$	0.7	

**Nominal ratings**

Operating voltage	$U_B$	10 ... 60 V
Switching frequency	$f$	0 ... 400 Hz
Hysteresis	$H$	typ. 5%
Reverse polarity protected	reverse polarity protected	
Short-circuit protection	pulsing	
Voltage drop	$U_d$	$\leq 3$ V
Operating current	$I_L$	0 ... 100 mA
Off-state current	$I_r$	$\leq 10$ $\mu$ A
No-load supply current	$I_0$	$\leq 15$ mA
Indication of the switching state	LED, yellow	

**Ambient conditions**

Ambient temperature	-25 ... 70 °C (-13 ... 158 °F)
---------------------	--------------------------------

**Mechanical specifications**

Connection type	Device connector M12 x 1, 4-pin
Housing material	Stainless steel 1.4305 / AISI 303
Sensing face	PBT
Protection degree	IP67

**Compliance with standards and directives**

Standard conformity	
Standards	EN 60947-5-2:2007 IEC 60947-5-2:2007

**Approvals and certificates**

UL approval	cULus Listed, General Purpose
CSA approval	cCSAus Listed, General Purpose
CCC approval	Certified by China Compulsory Certification (CCC)

Release date: 2010-11-16 11:11 Date of issue: 2012-02-03 021030\_eng.xml