

## BOW A-1216-NS-C-S49 BOW0029

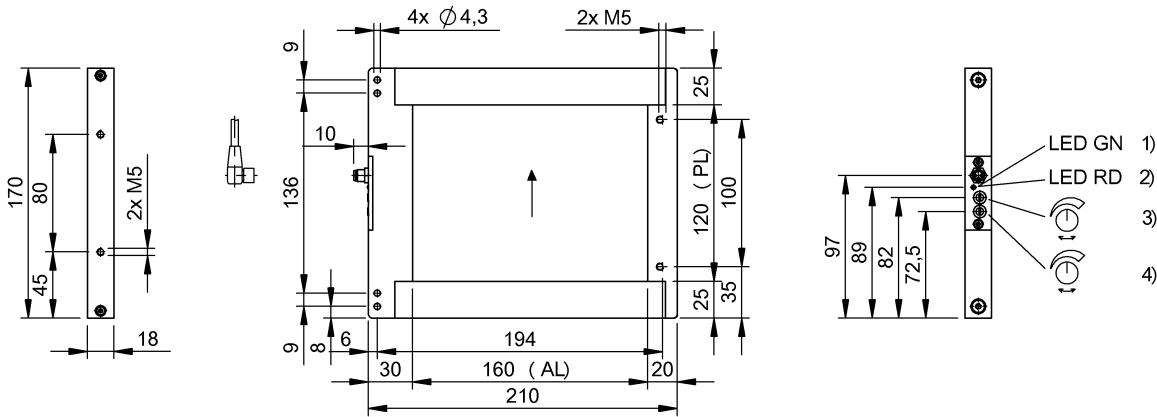

1) Power 2) Output function 3) Delay time 4) Sensitivity



### Display/Operation

Adjuster	Potentiometer 270° (2x)
Setting	Delay time Sensitivity dyn.

### Electrical connection

Connection	M8x1-Connector, 3-pole
Polarity reversal protected	yes
Short-circuit protection	yes

### Electrical data

Load capacitance max. at Ue	0.1 µF
No-load current I <sub>o</sub> max. at Ue	90 mA
Operating voltage U <sub>b</sub>	10...30 VDC
Pollution degree	3
Protected against miswiring	yes
Rated insulation voltage U <sub>i</sub>	75 V DC
Rated operating current I <sub>e</sub> DC	200 mA
Rated operating voltage U <sub>e</sub> DC	24 V
Ready delay t <sub>v</sub> max.	100 ms
Residual current I <sub>r</sub> max.	50 µA
Switching frequency	100 Hz Dynamic
Turn-off delay t <sub>off</sub> max.	0.4 ms dyn.
Turn-on delay t <sub>on</sub> max.	0.4 ms dyn.
Utilization category	DC -13
Voltage drop U <sub>d</sub> max. at I <sub>e</sub>	2.5 V

### Environmental conditions

Ambient temperature	-10...55 °C
Protection type IEC 60529	IP67

### General data

Approval/Conformity	CE
Basic standard	IEC 60947-5-2
Series	A
Style	Frame

### Material

Housing material	Aluminum
Material sensing surface	PMMA
Surface protection	anodized, black

### Mechanical data

Active window (PL x AL)	120 x 160 mm
Dimension	18 x 170 x 220 mm
Fastening detail	Screw M6 Screw M4
Smallest part typ.	1.2 mm dynamic

### Optical data

Ambient light max.	5000 Lux
Beam characteristic	Divergent
Light type	Infrared
Principle of optical operation	Through-beam sensor
Wave length	880 nm

### Output/Interface

Duration of time function	T = 5...300 ms
Switching output	NPN dynamic Normally open (NO)

BOW A-1216-NS-C-S49  
BOW0029

Time function

Turn-off delay dynamic

## Remarks

### Range/Distance

Ripple max. (% of Ue)

15 %

Order accessories separately.

For additional information, refer to user's guide.

Reference object (target): Steel ball, diameter 2.0 mm, lateral approach.

The sensor is functional again after the overload has been eliminated.

### Connector view

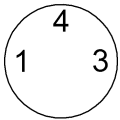

### Wiring Diagram

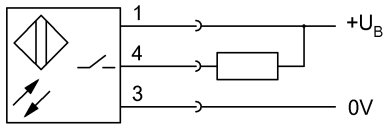

### Symbols for Optoelectronic Sensors

