

BCS R08RR01-PSM80C-EP00,2-GS49 BCS0055

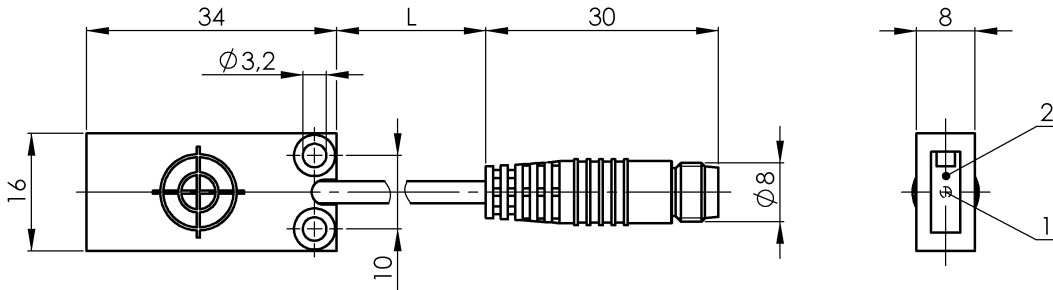

1) Potentiometer 2) LED function indicator



Electrical connection

| | |
|-----------------------------|-----------------------------------|
| Cable length | 0.2 m |
| Connection | M8x1-Connector, 3-pole |
| Connection type | Cable with connector, 0.20 m, PUR |
| Polarity reversal protected | yes |
| Short-circuit protection | yes |

Electrical data

| | |
|----------------------------------|-------------|
| Hysteresis H max. (% of Sr) | 15.0 % |
| MTTF (40 °C) | 680 a |
| Operating voltage U_b | 12...30 VDC |
| Protected against miswiring | yes |
| Rated insulation voltage U_i | 75 V DC |
| Rated operating current I_e DC | 50 mA |
| Ready delay t_v max. | 100 ms |
| Repeat accuracy max. (% of Sr) | 5.0 % |
| Switching frequency | 100 Hz |
| Utilization category | DC -13 |
| Voltage drop static max. | 1.5 V |

Environmental conditions

| | |
|---------------------------|-------------|
| Ambient temperature | -30...70 °C |
| Protection type IEC 60529 | IP67 |

Functional safety

| | |
|---------------------|-----|
| Diagnostic coverage | 0 % |
| Functional safety | no |

General data

| | |
|---------------------|-------------------------------|
| Approval/Conformity | CE cULus |
| Basic standard | IEC 60947-5-2 |
| Sensitivity | Switching distance adjustable |

Material

| | |
|--------------------------|-----|
| Cover material | PP |
| Housing material | PP |
| Material cover | PP |
| Material jacket | PUR |
| Material sensing surface | PP |

Mechanical data

| | |
|--------------|--------------------|
| Dimension | 34 x 16 x 8 mm |
| Installation | for flush mounting |

Output/Interface

| | |
|------------------|------------------------|
| Switching output | PNP Normally open (NO) |
|------------------|------------------------|

Range/Distance

| | |
|----------------------------------|----------|
| Measuring range | 1...8 mm |
| Range | 1...8 mm |
| Rated operating distance S_n | 8 mm |
| Ripple max. (% of U_e) | 10 % |
| Temperature drift max. (% of Sr) | 20 % |

BCS R08RR01-PSM80C-EP00,2-GS49 BCS0055

For further information on MTTF/B10d, please refer to the MTTF / B10d Certificate.

Specification of the MTTF value and the B10d value do not represent any binding quality and/or life expectancy guarantees.

Connector view

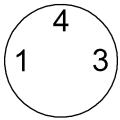

Wiring Diagram

