

CABLE TIE MOUNTS

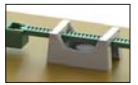

FTH-28RS Rivet / Screw Mount Cable Tie Mount

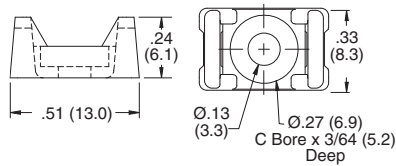

See page 731 for Rivets.

Specifications:

- Material: UL94 V-2 Nylon 6/6
- Color: Natural

Features:

- Mounts with a screw or snap rivet (see rivet chart)
- Cradle design provides stability for the bundle

Mounting Rivets for FTH-28RS		
Panel Thickness		Use Rivet Item No.
In	mm	
Up to 0.034	Up to 0.9	SR-3035
0.034 - 0.073	Up to 0.9	SR-3045
0.073 - 0.113	1.9 - 2.9	SR-3055
0.113 - 0.152	2.9 - 3.9	SR-3065
0.152 - 0.191	3.9 - 4.9	SR-3075
0.172 - 0.211	4.4 - 5.4	SR-3080
0.211 - 0.250	5.4 - 6.4	SR-3090
0.250 - 0.290	6.4 - 7.4	SR-3100

Item No.	Used with Cable Ties	Recommended Mounting Screw	Pack Qty.
FTH-28RS-01	18 & 40 lbs	#4, M3 Screw, SR-30XX (See Table)	1000

FTH-13 / FTH-14 Rivet / Screw Mount Cable Tie Mount

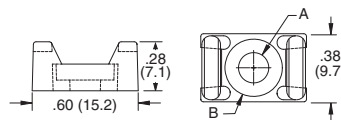

Figure 1

Specifications:

- Material: UL94 V-2 Nylon 6/6
- Color: Natural

Features:

- Mounts with screw or snap rivet (see rivet table)
- Cradle design provides stability for the bundle

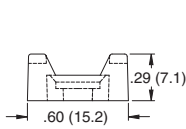

Figure 2

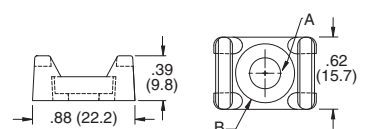

Figure 3

See page 731 for Rivets.

Item No.	1000 / Bag	100 / Bag	Approval	Figure	Used with Cable Ties	A		B		Mounting Method	Pack Qty.
						In	mm	In	mm		
FTH-13R-01-M		FTH-13R-01-C	UL	1	18 - 50 lbs	0.170	4.3	0.320	8.1	#8 or M4 screw or rivet	1000
FTH-13S-01-M		FTH-13S-01-C	UL	2	18 - 50 lbs	0.170	4.3	0.320	8.1	#6 or M3/#8 or M4 screw	1000
FTH-14R-01-M		FTH-14R-01-C	UL	3	18 - 120 lbs	0.210	5.2	0.380	9.5	#10 or M5 screw or rivet	1000
FTH-14S-01-M		FTH-14S-01-C	UL	3	18 - 120 lbs	0.260	6.6	0.490	12.5	1/4 or M6 screw	1000

Mounting Rivets for Figure 1		
Panel Thickness		Use Rivet Part Number
In	mm	
0.018 - 0.058	0.5 - 1.5	SR-4050
0.058 - 0.097	1.5 - 2.5	SR-4060
0.097 - 0.137	2.5 - 3.5	SR-4070
0.137 - 0.176	3.5 - 4.5	SR-4080
0.215 - 0.255	5.5 - 6.5	SR-4100

Mounting Rivets for Figure 3		
Panel Thickness		Use Rivet Part Number
In	mm	
0.020 - 0.048	0.5 - 1.2	SR-5055
0.048 - 0.087	1.2 - 2.2	SR-5065
0.087 - 0.127	2.2 - 3.2	SR-5075
0.127 - 0.166	3.2 - 4.2	SR-5085
0.166 - 0.205	4.2 - 5.2	SR-5095
0.205 - 0.245	5.2 - 6.2	SR-5105

FTH-34 / FTH-35 Screw Mount Cable Tie Mount

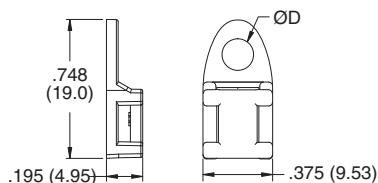

Specifications:

- Material: UL94 V-2 Nylon 6/6
- Color: Natural

Features:

- Cable ties can be inserted from all four sides
- Small size allows for use where space is limited

Item No.	Ø Hole D		Used with Cable Ties	Accepts Screw Size	Bulk Pack Qty.
	In	mm			
FTH-34-01	0.170	4.3	18 thru 50 lbs	#8 or M4	1000
FTH-35-01	0.200	5.1	18 thru 50 lbs	#10 or M5	1000