

INTERVOX Speakers from **International C**

215 McCormick Drive, Bohemia, NY 11716 (631)952-9595 Fax: (631) 952-9597 e-mail: oemsales@icc107.com

| | | | |
|--|--------------------------------------|--|--------------------------------------|
| 1 | MODEL: | S200RL-M-2W | |
| 2 | Dimension & Weight | Outer Diameter | ϕ 50 mm |
| | | Baffle Opening | ϕ 44.8 mm |
| | | Height | Refer to drawing |
| | | Weight | 14.1 Grams |
| 3 | Magnet | Materials | Rare Earth Size ϕ 12.8 x 1.5 mm |
| 4 | DC Resistance | 8 | $\Omega \pm 15\%$, On Ohm Meter |
| 5 | Power Rating | Normal | 2.0 Watts Maxim 2.5 Watts Sine Wave. |
| | | Normal | Watts Maxim Watts Square Wave. |
| 6 | Resonant Frequency | 350 $\pm 20\%$ Hz. | |
| 7 | Output Sound Pressure Level (S.P.L.) | 87 ± 3 db/ 1.0 Watt. 0.5 Meter | |
| | | Average at 800, 1000, 1200, 1500, Hz. | |
| 8 | Frequency Range | FO \sim 13000 Hz. Average SPL - 10 db. | |
| 9 | Distortion | 5 % Maximum At 1000 Hz. 1.0 W. | |
| 10 | Abnormal Sound test | Must be Normal Tested By 4.0 Volts. Sine Wave. | |
| 11 | Load Test | Pink noise with HPF(High Pass Filter 235HZ-3db-11db/Oct)4.0 Volts(RMS.)96hours | |
| 12 | Waterproof Level | IP65 | |
| 13 | Polarity | Diaphragm shall move Forward while Apply a Positive DC Signal to the "+" or "Marked "Terminal. | |
| Above Measuring condition under temperature : 15~35°C R.H. 25 ~75%. According to standard GB/T9396-1996 | | | |
| Mechanical and vibration test | | | |
| 14 | High Temperature | + 60 ± 2 °C Humidity Random for 96 Hours. (GB2423.2-81) | |
| 15 | Low Temperature | - 25 ± 2 °C Humidity Random for 96 Hours. (GB2423.1-81) | |
| 16 | Humidity | + 40 ± 2 °C Relative Humidity (RH) 90 ~ 95 % 96 Hours. (GB5170.18-87) | |
| 17 | Vibration | Frequency 30 ± 15 Hz, Amplitude 1.5 mm for 3 Hours. (GB11606.8-89) | |
| 18 | Drop test | 75 CM free falling on Concrete floor, 10 times. (GB2423. 8-81) | |
| After test leave speakers at room temperature for 1 hour, SPL shall not deviate by ± 3 db from pre-test | | | |
| 19 | Temperature Cycle test | - 25 ~ + 60 °C 4 Cycles Temperature tests. (GB5170.18-87) | |
| After test leave speakers at room temperature for 1 hour, SPL shall not deviate by ± 3 db from pre-test Measurement, and meet above spec. item 6. 7. 8. 9. 10. | | | |
| Please refer to next pages for more detailed testing method. | | | |

MOUNTING NOTICE

AT LEAST
0.8mm
FOR
DIAPHRAGM
MOVING

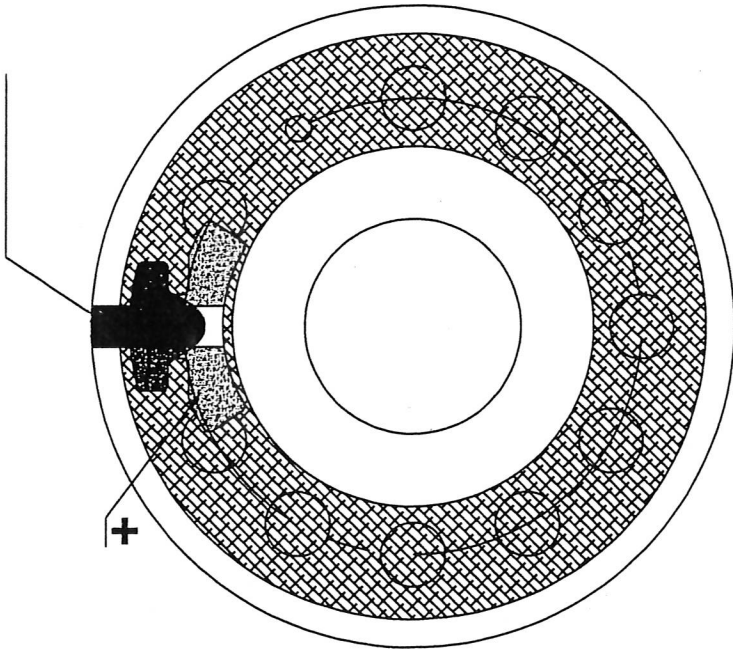
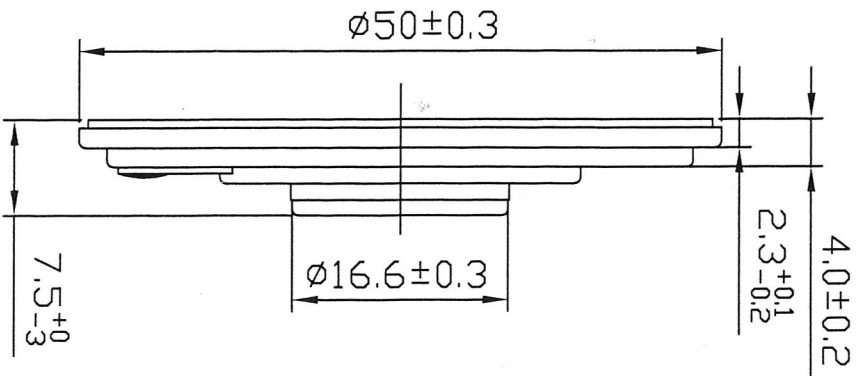
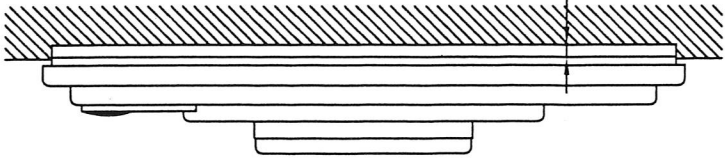

| RANGE | TOL | ✓ | | |
|--------|-------|-------|-------|-------|
| 0-8 | ±0.05 | ±0.10 | ±0.20 | ±0.30 |
| 8-16 | ±0.10 | ±0.15 | ±0.25 | ±0.40 |
| 16-24 | ±0.15 | ±0.20 | ±0.30 | ±0.50 |
| 24-50 | ±0.20 | ±0.25 | ±0.40 | ±1.0 |
| 50-100 | ±0.25 | ±0.30 | ±0.50 | ±2 |
| >100 | ±0.40 | ±0.40 | ±0.80 | ±3 |

INTERNATIONAL COMPONENTS CORPORATION

215 MCCORMICK DRIVE, BOHEMIA, NY 11716
 FAX: 631-952-9595 FAX: 631-952-9597

S200RL-M-2W

| VERSION | DATE | DESCRIPTION |
|---------|----------|-------------|
| V1.0 | 11.07.04 | |
| | | |
| | | |

| | | |
|----------|--------|--------|
| Unit: mm | Scale: | Appr.: |
| Tol.: | CHK.: | Dwg.: |



INTERVOX

Speakers from International C

215 McCormick Drive, Bohemia, NY 11716 (631) 952-9595 Fax: (631) 952-9597 e-mail: oemsales@icc 107.com

S200RL-M-2W

VOL:2.83V[1W] DIS:0.5M

Magn dB re 20.0 uPa.

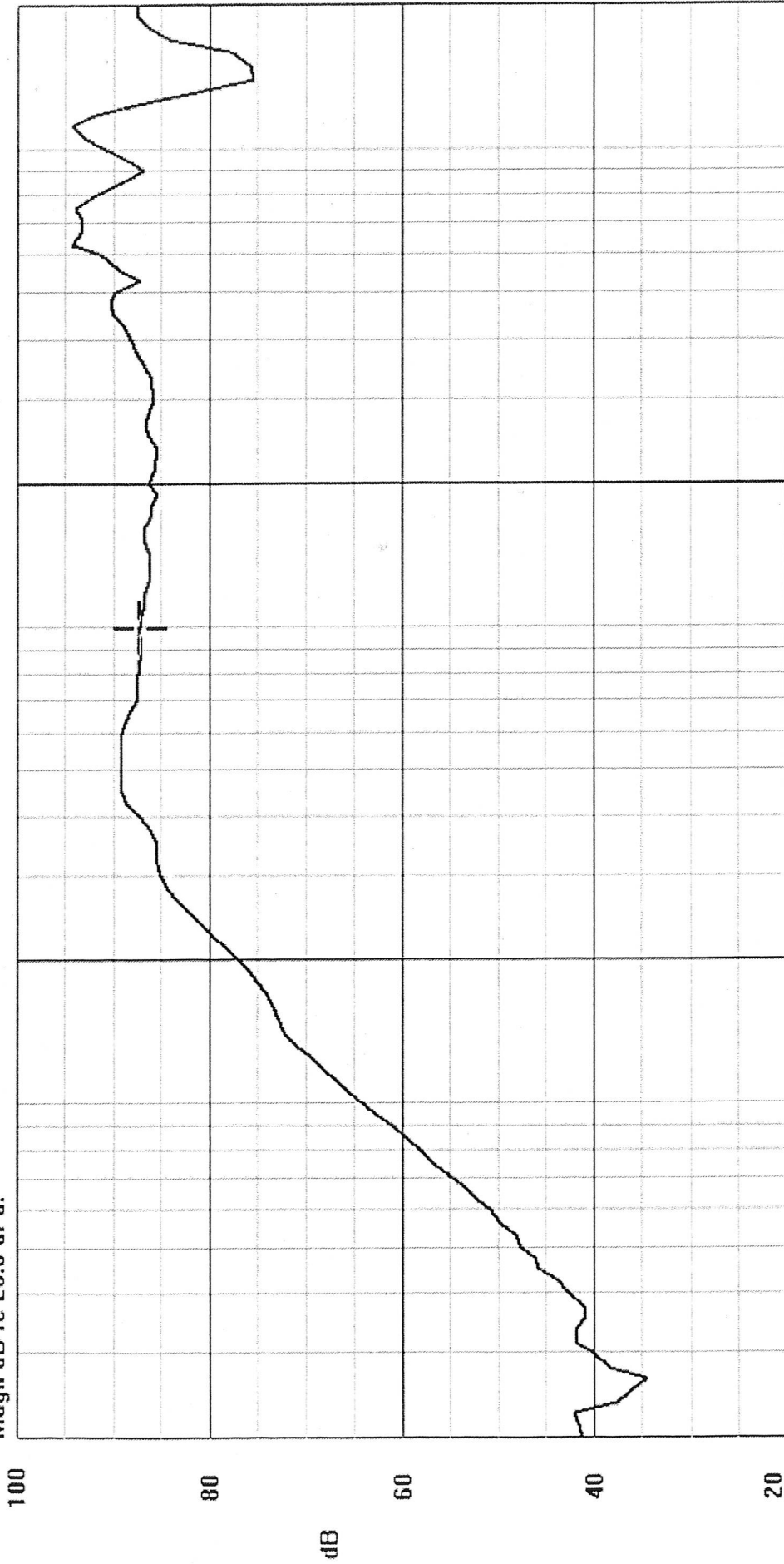

20

200

Hz

2.0K

20.0K

Current Curve: 0 X: 1000 Hz Y: 87.15 dB

Time(Y/M/D H:M:S): 2008/7/5 2:57:4

