

3M™ RIBBON CABLE WIREMOUNT SOCKET ASSEMBLY,
.05" X .05" (1.27mm X 1.27mm) PITCH, 451 SERIES

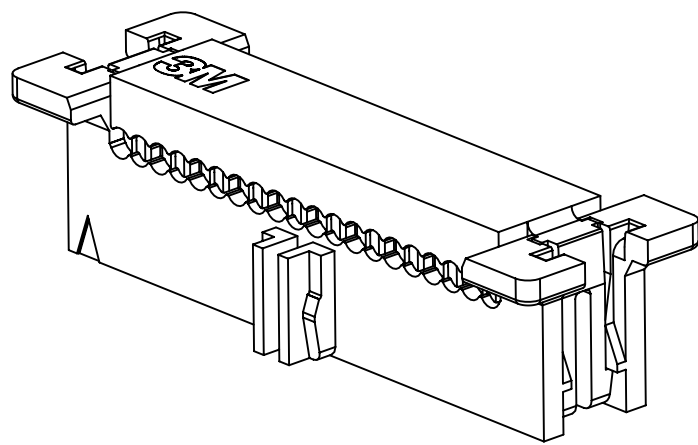

CENTER POLARIZATION
AND FRICTION LATCH

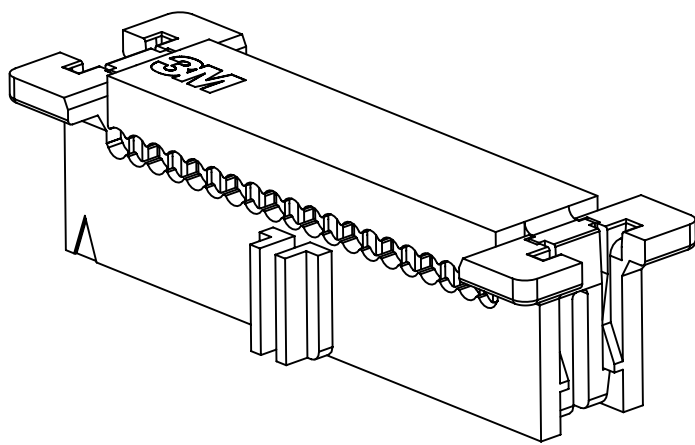

CENTER POLARIZATION
AND NO FRICTION LATCH

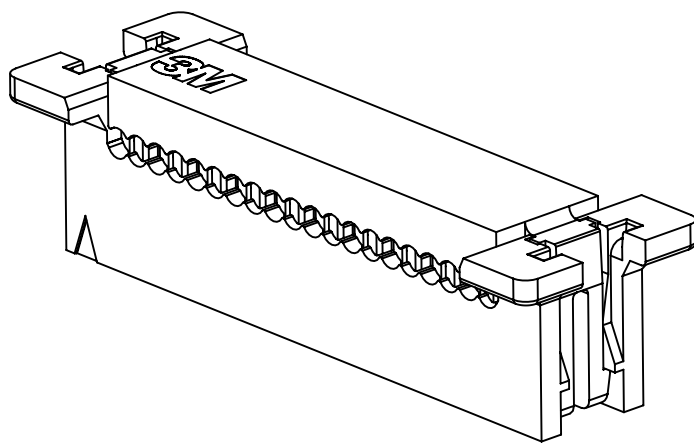

NO CENTER POLARIZATION
AND NO FRICTION LATCH

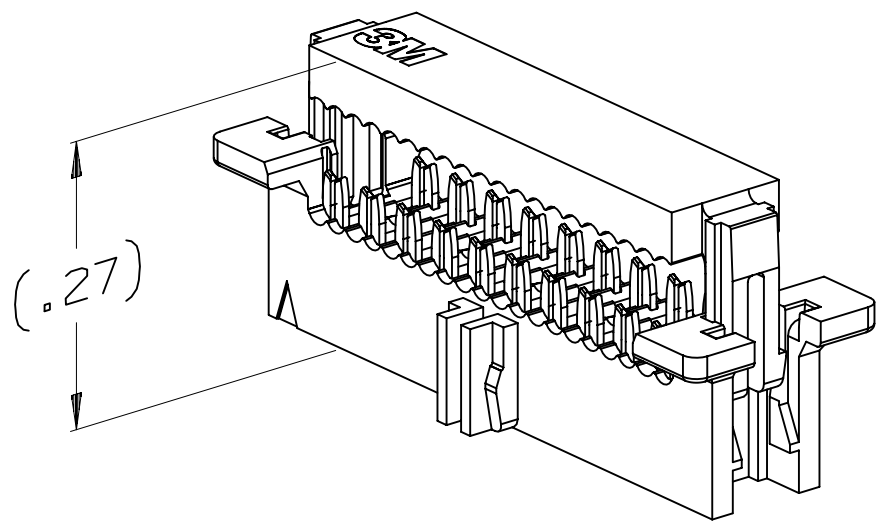
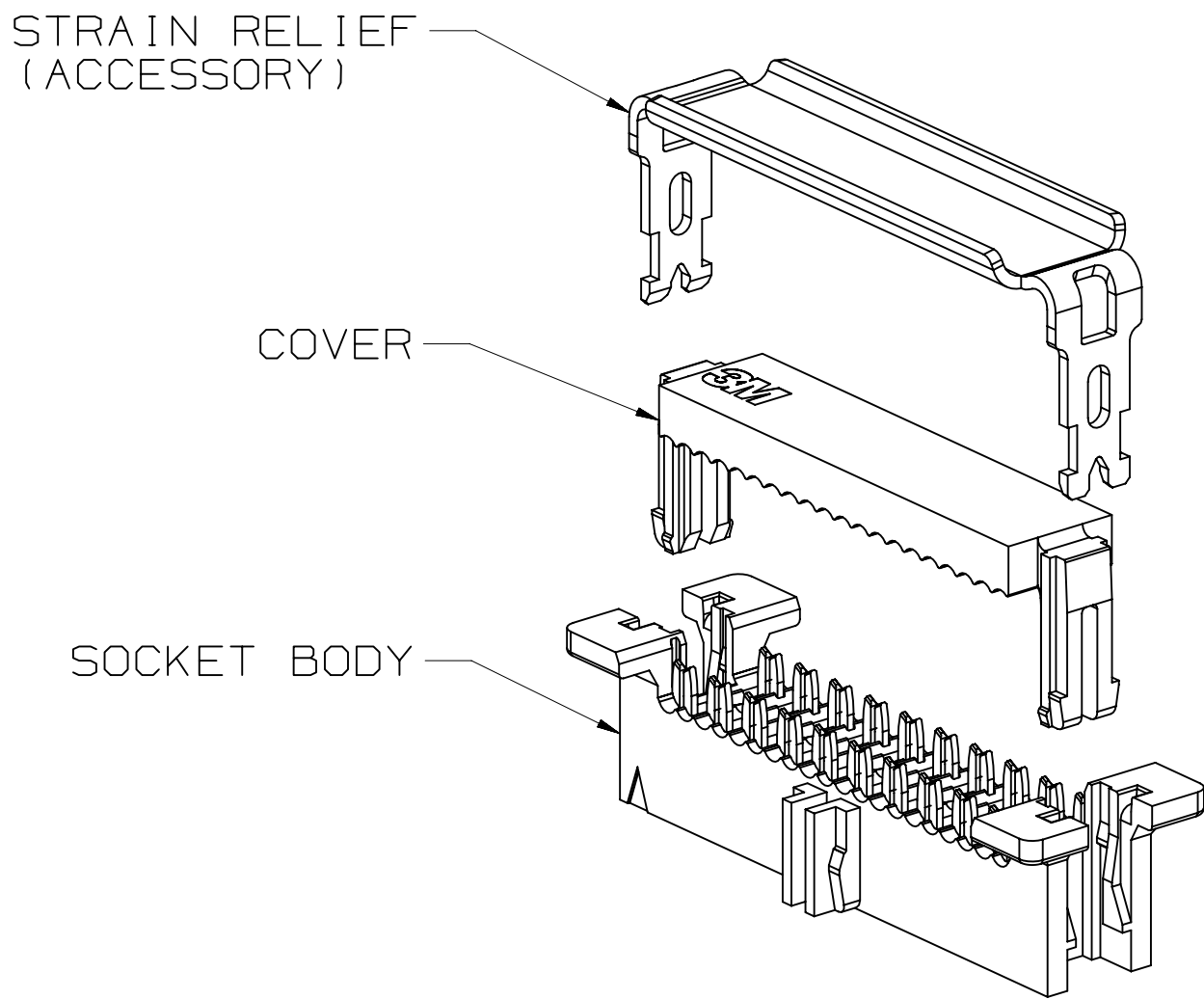

PRE-POSITIONED COVER

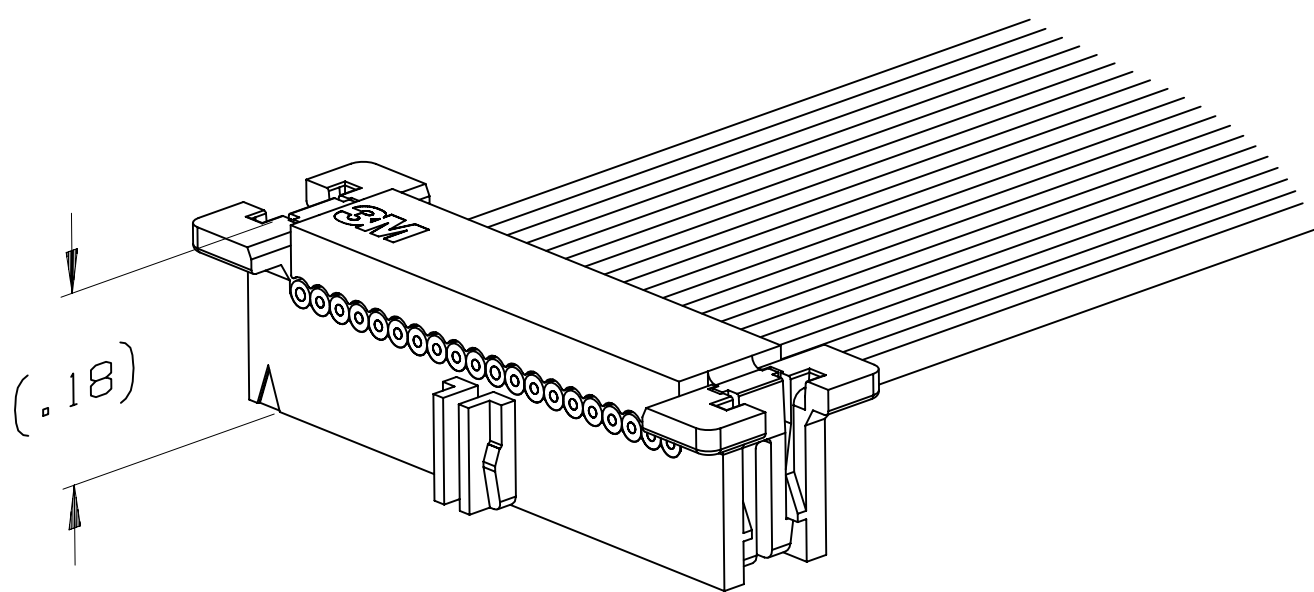

NO STRAIN RELIEF

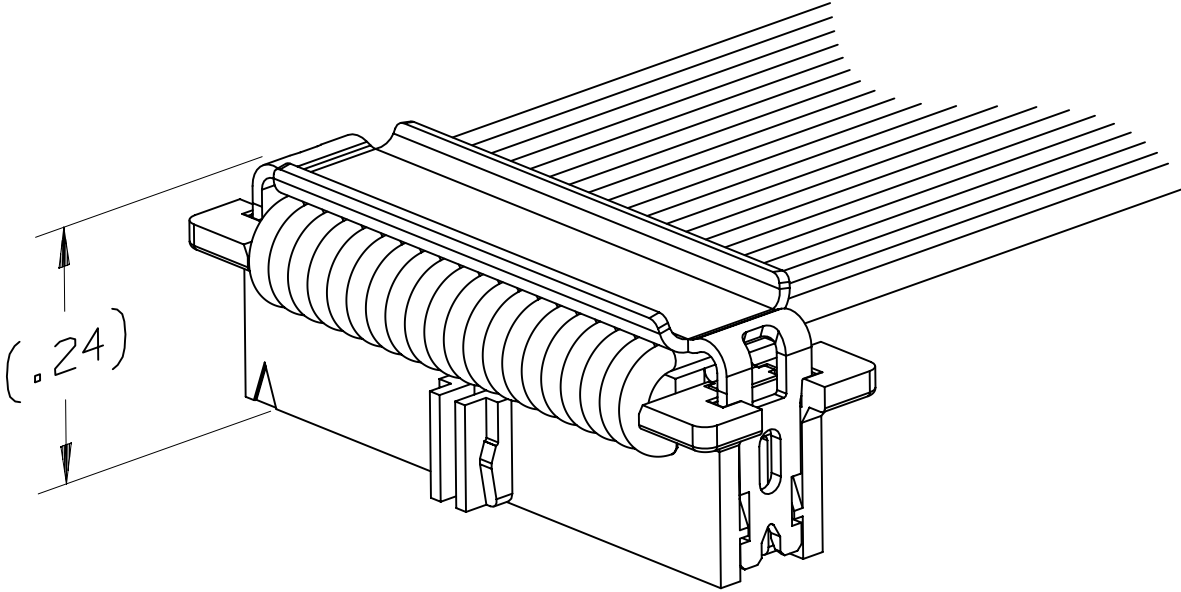

WITH OPTIONAL
STRAIN RELIEF

TERMINATED
CONNECTOR

3M™ ELECTRONIC SOLUTIONS DIVISION
INTERCONNECT SOLUTIONS
<http://www.3mconnectors.com>

3M IS A TRADEMARK OF 3M COMPANY.
FOR TECHNICAL, SALES OR ORDERING
INFORMATION CALL 800-225-5373

Performance:	
Current Rating:	1.0 A, all lines energized, 30C temp rise per EIA 364-70 1.5 A, 6 lines energized, 30C temp rise per EIA 364-70 2.5 A, 1 line energized, 30C temp rise per EIA 364-70
Voltage Rating:	125V
Insulation Resistance:	> 1 × 10 ⁹ Ohms at 500 VDC
Withstanding Voltage:	1250VACrms at sea level
Operating Temperature:	-65°C to +105°C

- NOTES
- MATERIAL:
BODY: PBT, UL94V-0
COVER: PBT, UL94V-0
STRAIN RELIEF: STAINLESS STEEL
CONTACTS: BeCu ALLOY.
 - PLATING:
50-150μ" NICKEL UNDERPLATE
30 = 30μ" MIN. GOLD ON WIPING AREA
00 = FLASH GOLD ON WIPING AREA.
 - RIBBON CABLE COMPATIBILITY:
GENERAL:
0.025" PITCH PVC, 30 AWG, SOLID OR 7 STRAND.
RECOMMENDED:
3M 3447 AND 3754 SERIES CABLE.
 - MATING COMPATIBILITY:
3M .050" X .050" SERIES 452 HEADER WITH LATCH/EJECT OPTION.
 - REGULATORY INFORMATION:
ROHS COMPLIANT. SEE THE REGULATORY INFORMATION APPENDIX (RIA) IN THE "ROHS COMPLIANCE" SECTION OF WWW.3MCONNECTORS.COM FOR COMPLIANCE INFORMATION (RIA E1 & C1 APPLY)
 - IN THE EVENT OF CONFLICT BETWEEN THIS DATA AND THAT CONTAINED IN THE PRODUCT SPECIFICATION, THE PRODUCT SPECIFICATION TAKES PRECEDENT.
 - REFERENCE RELATED DOCUMENTS:
PRODUCT SPECIFICATION:
3M DOC. ID# 78-5102-0091-4.
 - TOOLING AND INSTALLATION INSTRUCTIONS:
3M DOC. ID# 78-9101-8937-8.
 - OTHER PIN COUNTS AVAILABLE UPON REQUEST. CONTACT 3M.
 - PACKAGING:
SOCKET: TRAY
COVER: BAG

ORDERING INFORMATION
FOR RAPID INSTALLATION ON
RIBBON CABLE APPLICATIONS

451 XX - 0 X 0 0 XX
SERIES
POSITION COUNT
04 - 30
SEE TABLE 1
PLATING
00 = AU FLASH
30 = 30μ" GOLD
OPTIONAL FEATURES
0 = NONE SPECIFIED
PACKAGING
0 = STANDARD (TRAYS)

CENTER POLARIZATION / FRICTION LATCH
0 = NO CENTER POLARIZATION (CP) (04-30 POS.)
1 = CP NO FRICTION LATCH (08 - 30 POS.)
2 = CP WITH FRICTION LATCH (08 - 30 POS.)

NOTE:
FRICTION LATCH (OPTION 2) IS NOT SUITABLE
FOR HEADER WITH LATCH EJECT OPTION

ACCESSORY: STRAIN RELIEF
3448-451XX

POSITION COUNT
04 - 30

APPLICATION TOOLING:
ALUMINUM: 3443-82-XX

POSITION COUNT
04 - 30

DESIGN REFERENCE		NEXT ASSEMBLY		REV	ECO	ISSUE DATE AND DESCRIPTION		DRFT	CHKD
ARM	CODES	ARM	CODES	ARM	CODES	DATE	DATE	DATE	DATE
ARM	CODES	ARM	CODES	ARM	CODES	FEB 11, 2011	FEB 11, 2011	FEB 11, 2011	FEB 11, 2011
DIVISION		DIVISION CODE		3M		© 3M COPYRIGHT 2013			
Interconnect Solutions		ISD		3M		This document and the information it contains are 3M property and may not be reproduced or further distributed without 3M permission, or used or disclosed other than for 3M authorized purposes. All rights reserved.			
DO NOT SCALE DRAWING		SCALE 6-1		TOLERANCES EXCEPT AS NOTED		TITLE			
THIRD ANGLE PROJECTION		INCHES .00 ± .02 .000 ± .010 .0000 ± .005		MILLIMETERS 0 ± .00 ± .000 ± .000		RIBBON CABLE SOCKET, .05 X .05 PITCH, 451 SERIES			
INTERPRET PER ASME Y14.5 - 1994		MAX SURFACE ROUGHNESS		CAGE NUMBER		DRAWING NO. 78-5100-2436-3			
MARKED ONLY		ANGLES		MODEL		REV. C			

3M™ RIBBON CABLE WIREMOUNT SOCKET ASSEMBLY,
.05" X .05" (1.27mm X 1.27mm) PITCH, 451 SERIES

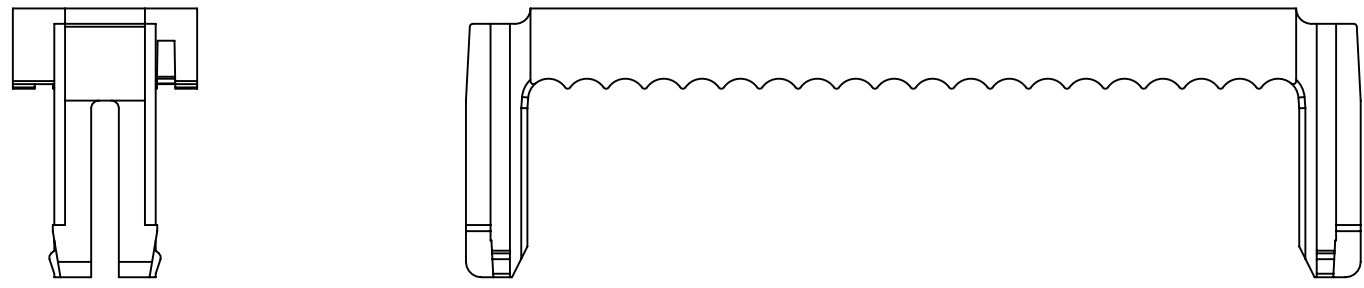

COVER

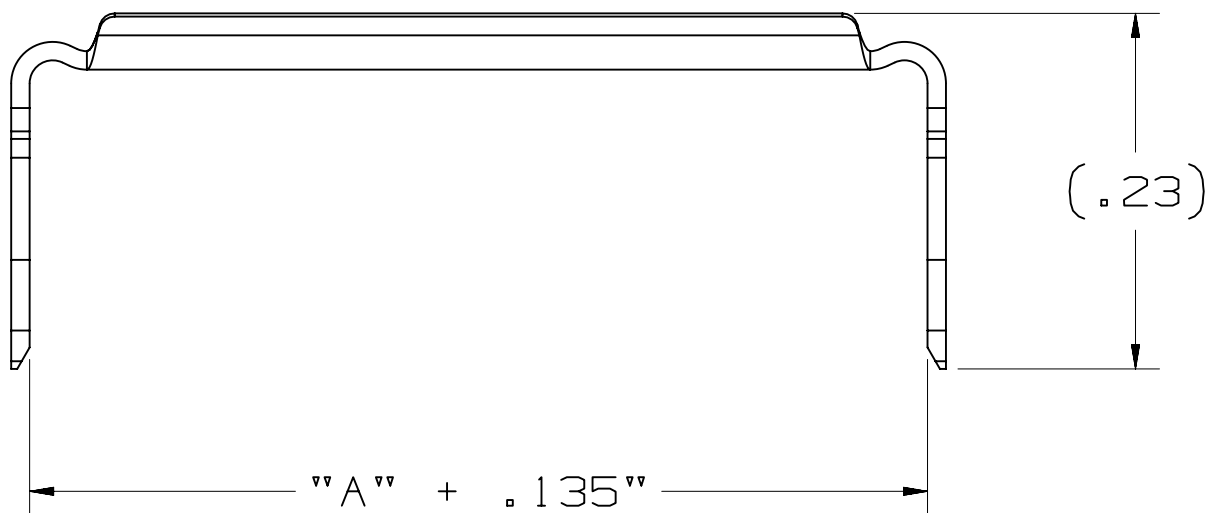
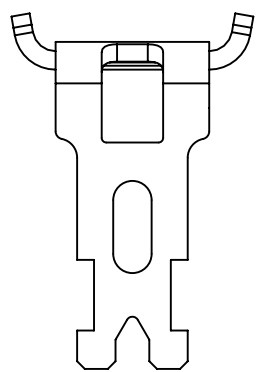
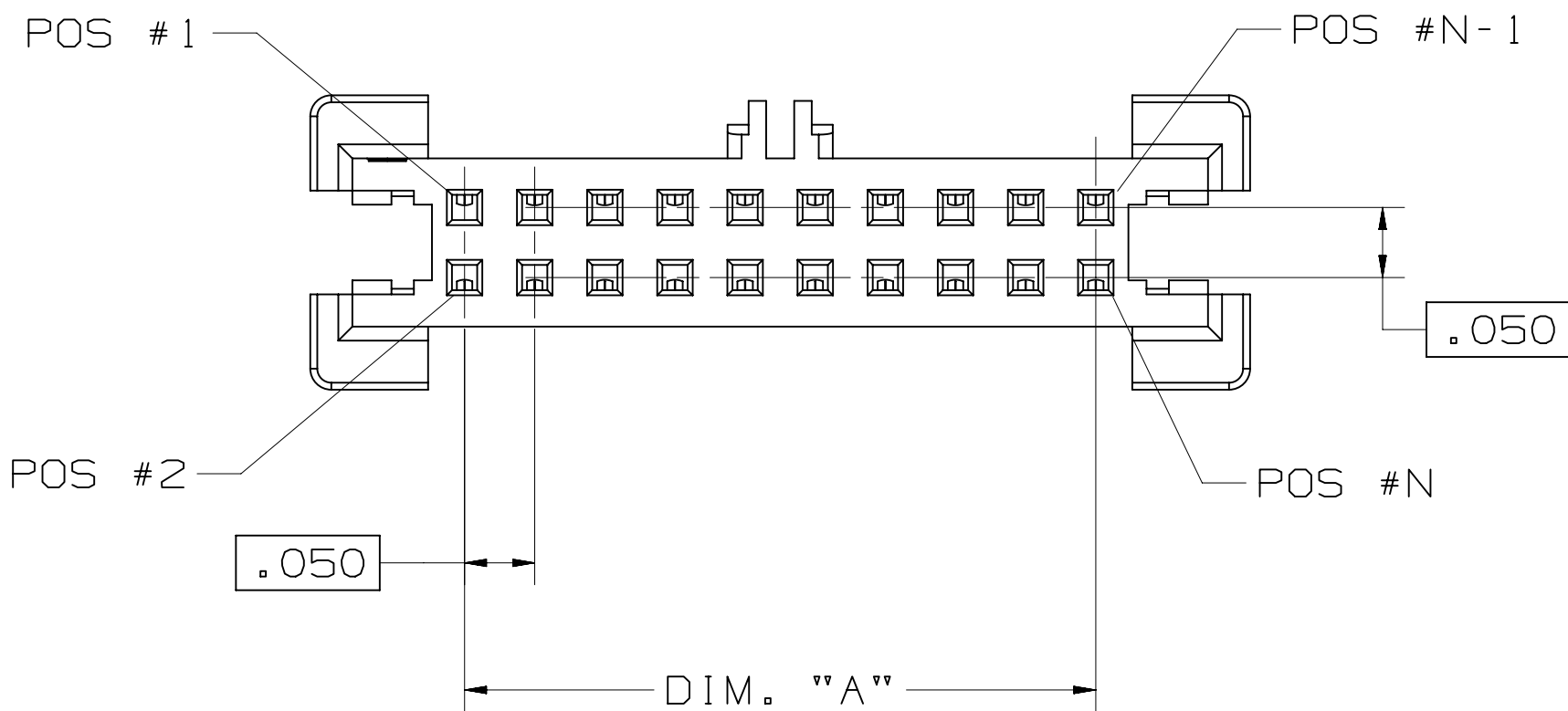
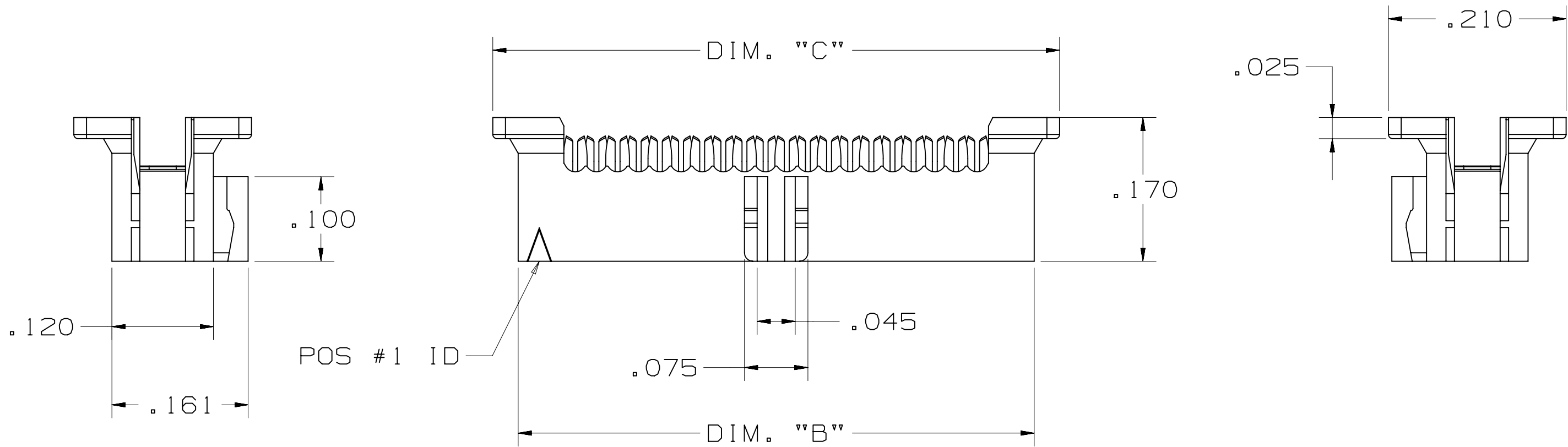

ACCESSORY - STRAIN RELIEF
PART NUMBER 3448-451XX

TABLE 1

No. Positions	Dim "A"	Dim "B"	Dim "C"
4	.050	.210	.270
6	.100	.260	.320
8	.150	.310	.370
10	.200	.360	.420
12	.250	.410	.470
14	.300	.460	.520
16	.350	.510	.570
20	.450	.610	.670
30	.700	.860	.920

DESIGN REFERENCE		NEXT ASSEMBLY		REV	ECO	ISSUE DATE AND DESCRIPTION		DRFT	CHKD
ARM	CODES	ARM	CODES	ARM	CODES	FEB 11,2011	MFG	DATE	DATE
CHKD	CHKD	CHKD	CHKD	CHKD	CHKD	DATE	APRVL	DATE	DATE
CHKD	CHKD	CHKD	CHKD	CHKD	CHKD	DATE	APRVL	DATE	DATE
DIVISION		DIVISION CODE		© 3M COPYRIGHT 2013					
Interconnect Solutions		ISD		This document and the information it contains are 3M property and may not be reproduced or further distributed without 3M permission, or used or disclosed other than for 3M authorized purposes. All rights reserved.					
DO NOT SCALE DRAWING		SCALE 4 1		TOLERANCES EXCEPT AS NOTED					
THIRD ANGLE PROJECTION		INTERPRET PER ASME Y14.5 - 1994		INCHES .00 ± .01 .000 ± .010 .0000 ± .005					
MAX SURFACE ROUGHNESS		SURFACES		MILLIMETERS 0 ± .00 ± .000 ± .005					
MARKED ONLY		ANGLES		CAGE NUMBER D78-5100-2436-3					
				MODEL					
				REV. C					
				SHT 2 OF 2					