

EAO – Your Expert Partner for Human Machine Interfaces

704.079.2 - Mushroom-head pushbutton actuator

704.079.2 - Mushroom-head pushbutton actuator



Attention: The preview is based on a sample product. This can differ from your current configuration.

Mounting

Mounting cut-out Ø 22.5 mm
Design raised

Front

Front ring material Aluminium
Front shape round
Front dimension Ø 60 mm
Front ring colour natural anodized

Other Attributes

Weight 0.060 kg

Operating-/Indication part

Lens material Aluminium
Lens optics opaque
Lens profile Mushroom
Lens colour red

IP-Rating

Front protection IP 65

Actuator

Switching action Momentary

Function

Mushroom-head pushbutton

EAO – Your Expert Partner for Human Machine Interfaces

704.079.2 - Mushroom-head pushbutton actuator

Dimensions

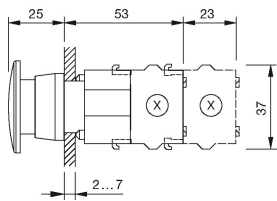

X = Screw terminal

Mounting cut-outs

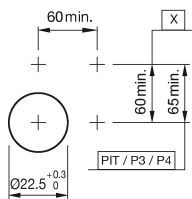

PIT = Push-in terminal

Wiring diagram

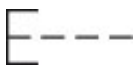

Additional information

Max. 3 switching elements can be clipped on
The colour of anodized aluminium parts can vary due to technical
production reasons

Legend

Switching action: B = Momentary