



SIGNALLING COLUMN SIREN ELEMENT CONTINUOUS
SOUND ,
ALTERNATING, 24V DC

General technical details:

product brand name		SIRIUS
product designation		signaling columns element, acoustic
Type of voltage		
<ul style="list-style-type: none"> • of the supply voltage • of the acoustic signal element 		DC
Consumed current / for rated value of supply voltage	mA	100
Supply voltage / 1 / of the acoustic signal element		
<ul style="list-style-type: none"> • for DC / rated value 	V	24
Design of the acoustic signal type		continuous tone / pulse tone
Loudness level	dB	105
Item designation		
<ul style="list-style-type: none"> • according to DIN 40719 extendable after IEC 204-2 / according to IEC 750 • according to DIN EN 61346-2 		H P

Mechanical design:

Color / of the housing		black
External diameter / of the signal column element	mm	70

Ambient conditions:

Ambient temperature		
• during operating	°C	-20 ... +50
Protection class IP		IP40
Product function / adjustable acoustic signal		No
Depth	mm	70
Height	mm	56
Width	mm	70

Certificates/approvals:

General Product Approval	EMC	Declaration of Conformity	Shipping Approval
 GOST	 UL	 C-TICK	 EG-Konf.
			 DNV

Further information:

Information- and Downloadcenter (Catalogs, Brochures,...)

<http://www.siemens.com/industrial-controls/catalogs>

Industry Mall (Online ordering system)

<http://www.siemens.com/industrial-controls/mall>

Cax online generator:

<http://www.siemens.com/cax>

Service&Support (Manuals, Certificates, Characteristics, FAQs,...)

<http://support.automation.siemens.com/WWW/view/en/8WD4420-0EA/all>

Image database (product images, 2D dimension drawings, 3D models, device circuit diagrams, ...)

http://www.automation.siemens.com/bilddb/cax_en.aspx?mlfb=8WD4420-0EA

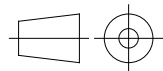
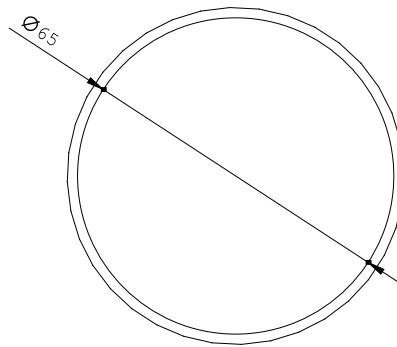
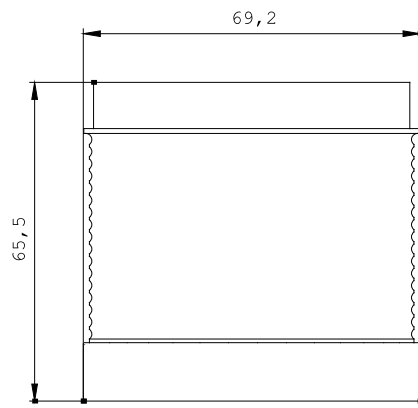

\W9.4444;
\W6.8333; 8WD44...-

last change:

Mar 4, 2013