



SURGE SUPPRESSOR, VARISTOR WITH LED,  
AC 48...127V, DC 24...70V,  
F. CONT. RELAYS A. MOTOR CONT. SZ S00,

**General technical data:**

<b>product brand name</b>		SIRIUS
<b>product designation</b>		surge suppressor
<b>Size of the contactor</b>		S00
<b>Design of the surge suppressor</b>		with varistor
<b>Ambient temperature</b>		
<ul style="list-style-type: none"> <li>• during storage</li> </ul>	°C	-40 ... +80
<ul style="list-style-type: none"> <li>• during operating</li> </ul>	°C	-25 ... +60

**Control circuit:**

<b>Type of voltage / of the controlled supply voltage</b>		AC/DC
<b>Control supply voltage frequency</b>		
<ul style="list-style-type: none"> <li>• 1 / rated value</li> </ul>	Hz	50
<ul style="list-style-type: none"> <li>• 2 / rated value</li> </ul>	Hz	60
<b>Control supply voltage / 1</b>		
<ul style="list-style-type: none"> <li>• for DC                             <ul style="list-style-type: none"> <li>• initial rated value</li> <li>• final rated value</li> </ul> </li> </ul>	V	24
	V	70
<ul style="list-style-type: none"> <li>• at 50 Hz / for AC                             <ul style="list-style-type: none"> <li>• initial rated value</li> <li>• final rated value</li> </ul> </li> </ul>	V	48
	V	127





- at 60 Hz / for AC
- final rated value
- initial rated value

V	127
V	48

### Installation/mounting/dimensions:

<b>mounting position</b>		any
<b>Type of mounting</b>		clip-on
<b>Width</b>	mm	28
<b>Height</b>	mm	46
<b>Depth</b>	mm	9

### Certificates/approvals:

<b>Verification of suitability</b>	CE / UL / CSA / CCC	
<b>General Product Approval</b>	<b>Declaration of Conformity</b>	<b>Test Certificates</b>
 CSA  GOST  UL	 EG-Konf.	<a href="#">Special Test Certificate</a>

### Shipping Approval



### Shipping Approval

**other**

[Confirmation](#)



### Further information:

#### Information- and Downloadcenter (Catalogs, Brochures,...)

<http://www.siemens.com/industrial-controls/catalogs>

#### Industry Mall (Online ordering system)

<http://www.siemens.com/industrial-controls/mall>

#### CAX-Online-Generator

<http://www.siemens.com/cax>

#### Service&Support (Manuals, Certificates, Characteristics, FAQs,...)

<http://support.automation.siemens.com/WWW/view/en/3RT2916-1JK00/all>

#### Image database (product images, 2D dimension drawings, 3D models, device circuit diagrams, ...)

[http://www.automation.siemens.com/bilddb/cax\\_en.aspx?mlfb=3RT2916-1JK00](http://www.automation.siemens.com/bilddb/cax_en.aspx?mlfb=3RT2916-1JK00)

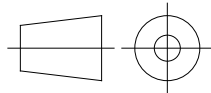
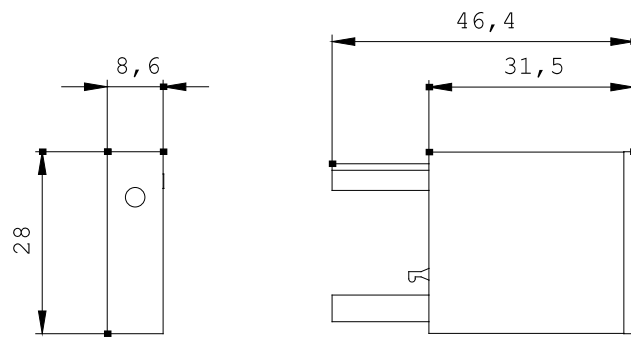

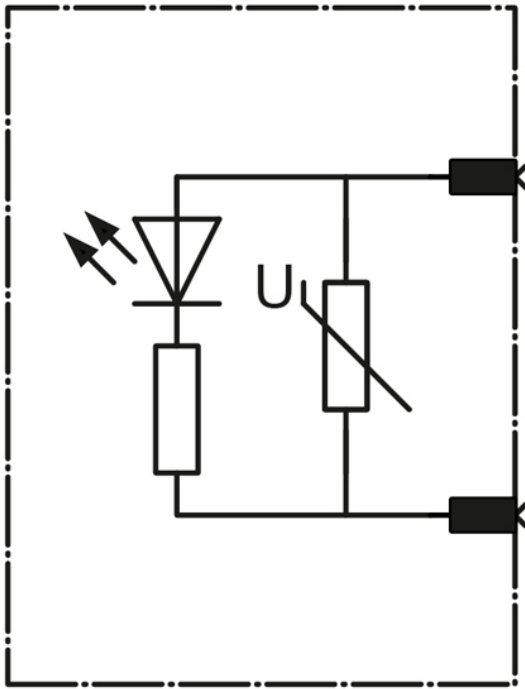

last change:

Jun 22, 2012