

Automation Technology > Power supplies > Power supply SITOP > Expansion modules > Redundancy module

6EP1961-3BA21 SITOP REDUNDANCY MODULE

Technical / CAx data

Technical Data CAx data



SITOP PSE202U REDUNDANCY
MODULE INPUT/OUTPUT: 24 V/40 A
DC CAN BE USED FOR
DECOUPLING OF 2 SITOP POWER
SUPPLIES WITH 20 A MAX. OUTPUT
CURRENT EACH

Technical specifications

Product	SITOP modular
Input	
Input	DC voltage
Supply voltage / at DC	24...24 V
Input voltage / at DC	24...28.8 V
Output	
Output	Controlled, isolated DC voltage
Rated voltage Vout DC	24 V
Output voltage	Vin - approx. 0.5 V
Product feature / output voltage adjustable	No
Status display	Green LED for "both Input voltages > switching threshold"; red LED: for "at least one input voltage < switching threshold"
Signaling	Isolated relay contact (changeover contacts, rating 8 A/240 V AC, 24 V DC): Signals OK if both input voltages > switching threshold, setting range of threshold 20 ... 25 V
Rated current value Iout rated	40 A
Current range	40 A
<ul style="list-style-type: none"> Note 	max. aggregate current 40 A
Efficiency	
Closed-loop control	
Protection and monitoring	

Safety	
Potential separation	yes, SELV acc. to EN 60950-1 (relay contact)
Protection class	Class I
CE mark	Yes
UL/CSA approval	Yes
UL/cUL (CSA) approval	cULus-Listed (UL 508, CSA C22.2 No. 107.1), File E197259
Explosion protection	ATEX (EX) II 3G Ex nAC IIC T4; cCSAus (CSA E60079, UL 60079), Class I, Div. 2, Group ABCD
CB approval	No
Verification of suitability / C-Tick	No
Marine approval	GL, ABS
Degree of protection (EN 60529)	IP20
EMC	
Emitted interference	EN 55022 Class B
Noise immunity	EN 61000-6-2
Operating data	
Ambient temperature / in operation	0...60 °C
• Note	with natural convection
Ambient temperature / on transport	-40...+85 °C
Ambient temperature / in storage	-40...+85 °C
Humidity class according to EN 60721	Climate class 3K3, no condensation
Mechanics	
Connection technology	screw-type terminals
Connections / Supply input	Input, output and ground: 1 screw terminal each for 0.33 ... 10 mm ² single-core/finely stranded
Connections / Auxiliary	Relay contact: 1 screw terminal each for 0.5 ... 2.5 mm ² single-core/finely stranded
Width / of the housing	70 mm
Height / of the housing	125 mm
Depth / of the housing	125 mm
Installation width	70 mm
Mounting height	225 mm
Weight, approx.	0.5 kg
Product feature / of the housing / housing for side-by-side mounting	Yes
Type of mounting / wall mounting	No
Type of fixing / cap rail mounting	Yes
Type of mounting / S7-300 rail mounting	No
Installation	Snaps onto DIN rail EN 60715 35x7.5/15
Other information	Specifications at rated input voltage and ambient temperature +25 °C (unless otherwise specified)

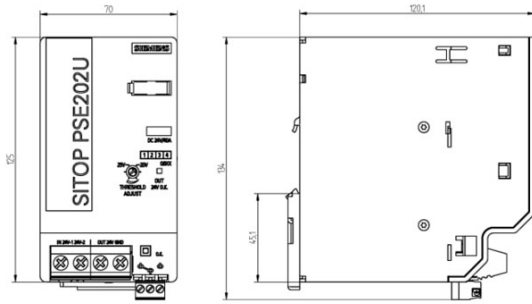

letzte Änderung:

Jun 1, 2012