

Automation Technology > Power supplies > Power supply SITOP > Uninterruptible power supplies 24 V DC > DC UPS with battery modules

## 6EP1935-6MD11 SITOP BATTERY MODULE 24 V/3.2 AH

Technical / CAx data

Technical Data  CAx data



SITOP BATTERY MODULE 24 V/3.2 AH WITH SERVICE-FREE SEALED LEAD-ACID BATTERIES FOR SITOP DC UPS MODULE 6 A AND 15 A

### Technical specifications

Product	SITOP Battery module
Product type	Battery module 3.2 Ah
Type of battery	maintenance-free lead-acid batteries

### Charging current

End of charging voltage / for DC	
<ul style="list-style-type: none"> <li>at 10 °C / recommended</li> <li>at 20 °C / recommended</li> <li>at 30 °C / recommended</li> <li>at 40 °C / recommended</li> <li>at 50 °C / recommended</li> </ul>	27.8 V 27.3 V 26.8 V 26.6 V 26.3 V
charging current / maximum	0.8 A

### Safety

Design of the short-circuit protection	Battery fuse 15 A/32 V (solid-state circuitry blade-type fuse + support)
Design of the overload protection	Valve control

### Safety

Protection class	Class III
CE mark	Yes
UL/cUL (CSA) approval	cURus-Recognized (UL 1778, CSA C22.2 No. 107.1), File E219627
Protection class IP	IP00

### Operating data

- note

For storage, mounting and operation of lead-acid batteries, the relevant DIN/VDE regulations or country-specific regulations (e.g. VDE 0510 Part 2/EN 50272-2) must be observed. You must ensure that the battery site is sufficiently ventilated. Possible sou

Ambient temperature	
<ul style="list-style-type: none"> <li>in operation</li> <li>on transport</li> <li>in storage</li> </ul>	<p>-15...+50 °C</p> <p>-20...+50 °C</p> <p>-20...+50 °C</p>
Relative, temporary capacity loss / at 20 °C / in a month / typical	3 %
<b>Service life</b>	
Service life of lead-acid battery	
<ul style="list-style-type: none"> <li>typical / note</li> <li>at 20 °C / typical</li> <li>at 30 °C / typical</li> <li>at 40 °C / typical</li> <li>at 50 °C / typical</li> </ul>	<p>capacity falls to 50 % of original capacity</p> <p>4 a</p> <p>2 a</p> <p>1 a</p> <p>0.5 a</p>
<b>Mechanics</b>	
Connection technology	spring-loaded terminals
Design of the electrical connection	1 screw terminal each for 0.08 ... 2.5 mm <sup>2</sup> for + BATT and - BATT
Product component / belonging to	Accessories pack with solid-state circuitry fuse 15 A
Width / of the housing	190 mm
Height / of the housing	151 mm
Depth / of the housing	82 mm
Installation width	210 mm
Mounting height	171 mm
Net weight	3.2 kg
Installation	snaps onto DIN rail EN 60715 35x7.5/15 or keyhole mounting for hooking in to M4 screws
Number of cells	12
Other information	Specifications at rated input voltage and ambient temperature +25 °C (unless otherwise specified)

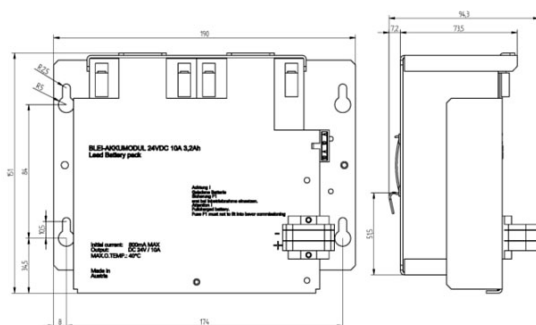

**letzte Änderung:**

May 14, 2012

© Siemens AG 2012 - Corporate Information - Privacy Policy - Terms of Use