

# Ventilation Plugs

## VP Vent Plug Metal

Stainless steel vent plug

Metric & PG  
Thread

Vent plugs are used to balance the pressure in an enclosure to protect electronic connections from condensation. They are UL approved and chemical resistant. The vent plugs are stainless steel AISI 303 and come with different air flow ratings.

Style C

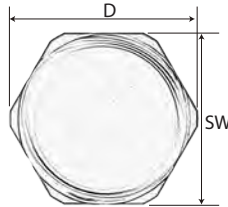
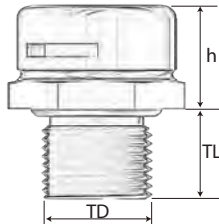

| Technical data:    |  |
|--------------------|--|
| Body:              | Stainless steel AISI 303                           |
| Cap:               | Stainless steel AISI 303                           |
| Vent element:      | Acrylic Co-Polymer on Nylon Support                |
| Seal:              | Chloroprene (CR)                                   |
| Washer:            | Neoprene (NBR)                                     |
| Protection type:   | IP 67/68<br>(for water intrusion pressure oil bar) |
| Temperature range: |  |
| permanent:         | -20°C to +100°C                                    |
| intermittent:      | -30°C to +150°C                                    |
| Approvals:         | cURus  |



Style D

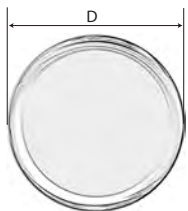

Style G

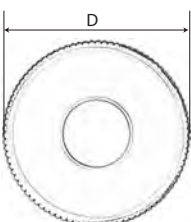

| Part Number | Style | Average Air Flow<br>l/h | Water Intrusion<br>Pressure bar | Thread Size | Thread Length (TL)<br>inches | Thread Diameter (TD)<br>inches | Outer Diameter (D)<br>inches | max. Height (H)<br>inches | UL    |
|-------------|-------|-------------------------|---------------------------------|-------------|------------------------------|--------------------------------|------------------------------|---------------------------|-------|
| VPM-01      | G     | 4                       | 0.9                             | M4x0.7      | 0.118                        | 0.157                          | 0.484                        | 0.106                     | -     |
| VPM-02      | G     | 7                       | 0.5                             | M4x0.7      | 0.118                        | 0.157                          | 0.484                        | 0.106                     | -     |
| VPM-03      | C     | 16                      | 0.9                             | M12x1.5     | 0.236                        | 0.472                          | 0.740                        | 0.433                     | cURus |
| VPM-03L     | C     | 16                      | 0.9                             | M12x1.5     | 0.394                        | 0.472                          | 0.740                        | 0.433                     | cURus |
| VPM-04      | C     | 16                      | 0.9                             | PG 7        | 0.413                        | 0.492                          | 0.740                        | 0.433                     | cURus |
| VPM-05      | C     | 16                      | 0.9                             | M16x1.5     | 0.236                        | 0.630                          | 0.787                        | 0.472                     | -     |
| VPM-05H     | C     | 16                      | 0.9                             | M16x1.5     | 0.236                        | 0.630                          | 0.787                        | 0.630                     | -     |
| VPM-06      | C     | 16                      | 0.9                             | M20x1.5     | 0.236                        | 0.787                          | 0.965                        | 0.512                     | -     |
| VPM-06H     | C     | 16                      | 0.9                             | M20x1.5     | 0.236                        | 0.787                          | 0.965                        | 0.669                     | -     |
| VPM-07      | C     | 25                      | 0.5                             | M12x1.5     | 0.236                        | 0.472                          | 0.740                        | 0.433                     | cURus |
| VPM-07L     | C     | 25                      | 0.5                             | M12x1.5     | 0.394                        | 0.472                          | 0.740                        | 0.433                     | cURus |
| VPM-08      | C     | 25                      | 0.5                             | PG 7        | 0.413                        | 0.492                          | 0.740                        | 0.433                     | cURus |
| VPM-09      | C     | 25                      | 0.5                             | M16x1.5     | 0.236                        | 0.630                          | 0.787                        | 0.472                     | -     |
| VPM-09L     | C     | 25                      | 0.5                             | M16x1.5     | 0.236                        | 0.630                          | 0.787                        | 0.630                     | -     |
| VPM-10      | C     | 25                      | 0.5                             | M20x1.5     | 0.236                        | 0.787                          | 0.965                        | 0.512                     | -     |
| VPM-10H     | C     | 25                      | 0.5                             | M20x1.5     | 0.236                        | 0.787                          | 0.965                        | 0.669                     | -     |
| VPM-11      | G     | 35                      | 0.2                             | M4x0.7      | 0.118                        | 0.157                          | 0.484                        | 0.106                     | -     |
| VPM-12      | G     | 100                     | 0.1                             | M4x0.7      | 0.118                        | 0.157                          | 0.484                        | 0.106                     | -     |
| VPM-13      | C     | 120                     | 0.2                             | M12x1.5     | 0.236                        | 0.472                          | 0.740                        | 0.433                     | cURus |
| VPM-13L     | C     | 120                     | 0.2                             | M12x1.5     | 0.394                        | 0.472                          | 0.740                        | 0.433                     | cURus |
| VPM-14      | C     | 120                     | 0.2                             | PG 7        | 0.413                        | 0.492                          | 0.740                        | 0.433                     | cURus |
| VPM-15      | C     | 120                     | 0.2                             | M16x1.5     | 0.236                        | 0.630                          | 0.787                        | 0.472                     | -     |
| VPM-15H     | C     | 120                     | 0.2                             | M16x1.5     | 0.236                        | 0.630                          | 0.787                        | 0.630                     | -     |
| VPM-16      | C     | 120                     | 0.2                             | M20x1.5     | 0.236                        | 0.787                          | 0.965                        | 0.512                     | -     |
| VPM-16H     | C     | 120                     | 0.2                             | M20x1.5     | 0.236                        | 0.787                          | 0.965                        | 0.669                     | -     |
| VPM-17      | D     | 120                     | 0.9                             | M40x1.5     | 0.394                        | 1.575                          | 2.283                        | 0.807                     | cURus |
| VPM-18      | C     | 300                     | 0.1                             | M12x1.5     | 0.236                        | 0.472                          | 0.740                        | 0.433                     | cURus |
| VPM-18L     | C     | 300                     | 0.1                             | M12x1.5     | 0.394                        | 0.472                          | 0.740                        | 0.433                     | cURus |
| VPM-19      | C     | 300                     | 0.1                             | PG 7        | 0.413                        | 0.492                          | 0.740                        | 0.433                     | cURus |
| VPM-20      | C     | 300                     | 0.1                             | M16x1.5     | 0.236                        | 0.630                          | 0.787                        | 0.472                     | -     |
| VPM-20H     | C     | 300                     | 0.1                             | M16x1.5     | 0.236                        | 0.630                          | 0.787                        | 0.630                     | -     |
| VPM-21      | C     | 300                     | 0.1                             | M20x1.5     | 0.236                        | 0.787                          | 0.965                        | 0.512                     | -     |
| VPM-22      | D     | 375                     | 0.5                             | M40x1.5     | 0.394                        | 1.575                          | 2.283                        | 0.807                     | cURus |
| VPM-23      | D     | 1350                    | 0.2                             | M40x1.5     | 0.394                        | 1.575                          | 2.283                        | 0.807                     | cURus |
| VPM-24      | D     | 2200                    | 0.1                             | M40x1.5     | 0.394                        | 1.575                          | 2.283                        | 0.807                     | cURus |