

**76357-401LF -
DUBOX™, Basics+ : Crimp-to-
Wire Contact**

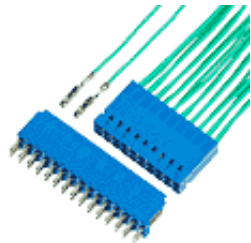

www.fci.com

Specifications

General	
Number of contacts	1
Number of rows	1
Product Type	Crimp-to-Wire Contact
Housing Style (Double row)	65239
Housing Style (Single row)	65240
Mating half	Mates with 0.64 mm (0.025 in.) Square Pin with Length of 5 mm (0.2 in.) min. to 5.96 mm (0.235 in.) max.
Series Number	76357
Dimensional	
Size (Wire)	22 to 30 AWG
Electrical	
Current rating	3A Continuous
Resistance (Contact)	15 M-ohms max.
Voltage rating	1000V rms
Mechanical	
Insertion force	1.3N
Withdrawal Force	0.3N
Physical	
Material (Contact)	Phosphor Bronze
Plating (Contact area)	3.81 µm (150 µin.) Tin
Underplating	1.27 µm (50 µin.) Nickel
Temperature (Operating - range)	-40°C to +125°C
Approvals / Certifications	
UL File Number	E66906
CSA File Number	LR46923
Approvals / Certifications	UL and CSA Approved
Other Features	
Packaging (Type)	Bulk

PRODUCT NUMBER
76357-YXXLF

WHEN NEEDED, SUFFIX LETTER "LF"
INDICATES THE PRODUCT IS RoHS
COMPATIBLE, SEE NOTE 3

01: AWG 22-30
11: AWG 20

PLATING CODE

3= 0.76µm GOLD ON CONTACT AREA.
3.81µm TIN-LEAD ON TAIL.
4= 5µm TIN-LEAD ON CONTACT AREA.
3.81µm TIN-LEAD ON TAIL.

WHEN SUFFIX "LF" IS REQUIRED, 2µm MIN MATTE
TIN OVER 1.27 MIN Ni IS SUPPLIED INSTEAD OF SnPb.

NOTES:

- 1 - TERMINAL MATERIAL: PHOSPHOR BRONZE.
- 2 - PRODUCT PACKED IN PLASTIC BOX (1000/BOX).
- 3 - RoHS COMPATIBLE PRODUCT SPECIFICATIONS

a - PLATING:

- "LF" MEANS THE PRODUCT IS LEAD-FREE,
2µm MINIMUM MATTE TIN OVER 1.27µm
MINIMUM NICKEL UNDERPLATE.

b - LABELING:

- MEETS PACKAGING SPECS AS PER GS-14-920

c - LEGAL STATEMENT: SEE GS-22-008

THE PRODUCT IS NOT INTENDED TO BE EXPOSED TO A

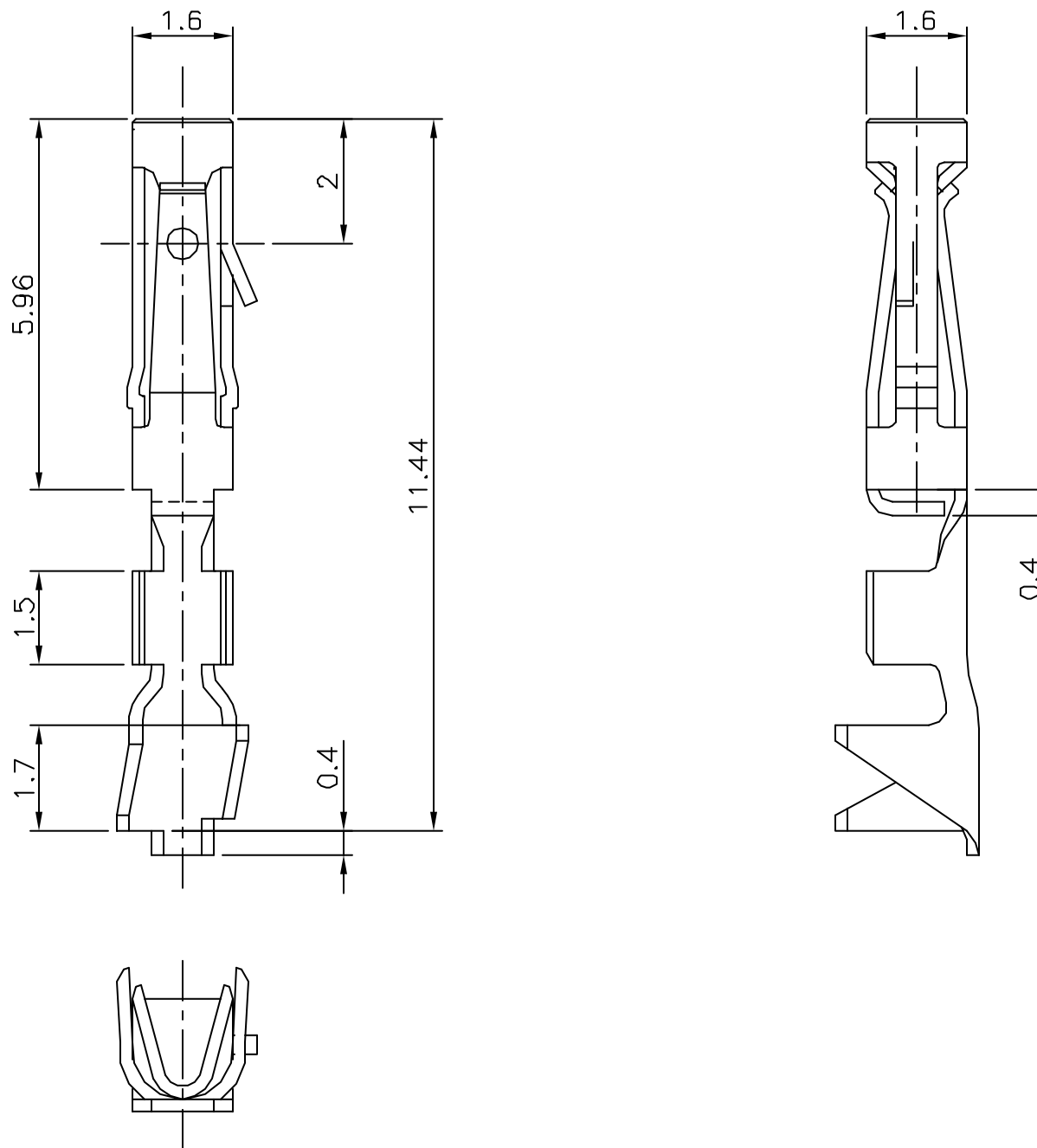

WIRE DIMENSION	
AWG	OUTSIDE INSULATION DIA.
20	1.30-1.65
22-30	0.90-1.50

mat'l. code				surface ISO 1302 ✓	tolerance ISO 406 ISO 1101	projection mm	product family DUBOX
ltr	ecn no	dr	date	tolerances unless otherwise specified		mm	title CtW CONTACT LOOSE PIECE
D	10759	-	88.04.05	angles	linear		
E	F00155	DLE	00.03.16			scale 10:1	dwg no 76357
F	F10103	GCO	01.01.02				
G	F04-0373	DLE	04.11.19	dr	D LEGRAND	00.03.16	sheet 1 of 1
H	F05-0288	DLE	05.11.07	enr	P NIZZI	00.03.16	size A3
J	F06-0215	DLE	06.06.30	chr	JF NOTTEAU	00.03.16	type CUSTOMER Drawing
K	F06-0237	DLE	06.07.13	appd	PNZ	00.03.16	
sheet index	revision sheet						



Copyright FCI