

**71363-102LF - Mini-Jump™ :
2.54 mm (0.1 in.) Centerline,
Single Row, High Body Shunt
0.38 µm (15 µin.) Gold Plating**

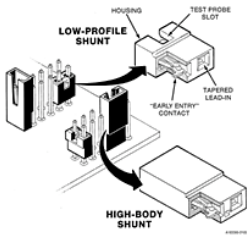

www.fci.com

Specifications

General

Number of contacts (Total)	2
Number of rows	1
Mating half	0.64 Square Pins of 3.68 mm min. Height
Series Number	71363

Dimensional

Dim A (in)	0.198 in.
Dim A (mm)	5.03 mm
Spacing (Center line)	2.54 mm (0.1 in.)
Height (Housing)	9.15 mm (0.36 in.)

Electrical

Current rating	2.5 amps
Resistance (Contact)	15 milli ohms (Initial), 20 milli ohms (After test)
Resistance (Insulation)	50000 M-ohms min.
Voltage rating	800V AC rms (Sea level)

Mechanical

Durability (Mating cycles)	50
Insertion force	450gf (1lbf) max.
Withdrawal Force	30gf (0.06lbf) min.

Physical

Color (Housing)	Black
Material (Contact)	Copper Alloy
Material (Housing)	Glass-Filled Thermoplastic Polyester (UL 94 V-0)
Plating (Contact area)	0.38 µm (15 µin.) Gold
Underplating (Contact)	1.27 µm (50 µin.) Nickel
Temperature (Range)	-55°C to +120°C

Approvals / Certifications

UL File Number	E66906
CSA File Number	LR46923
Approvals / Certifications	UL and CSA Approved

Other Features

Packaging (Type)	Bag
------------------	-----

Bus Bar

No

PART NO SEE NOTE 3	PLATING
71363-102 71363-102LF	0.38µm/15µ" Au CONTACT. Au FLASH ALL OVER 1.27µm/50µ" Ni
71363-202 71363-202LF	0.76µm/30µ" Au CONTACT. Au FLASH ALL OVER 1.27µm/50µ" Ni
71363-302 71363-302LF	2.54µm/100µ" MATTE TIN PLATING

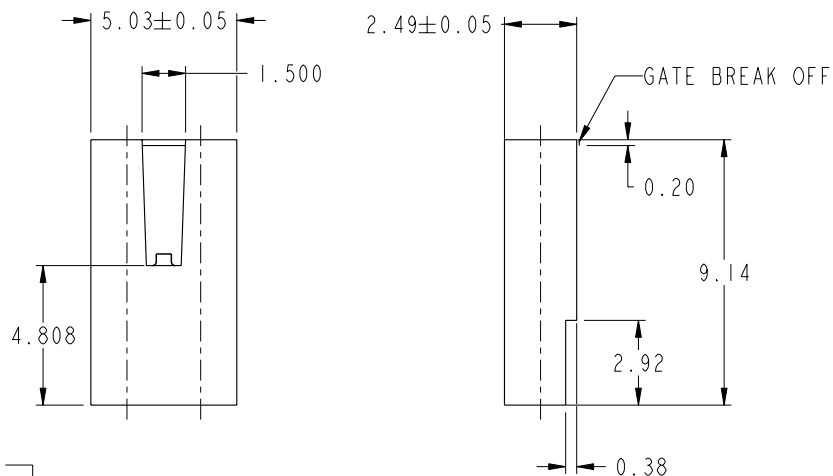
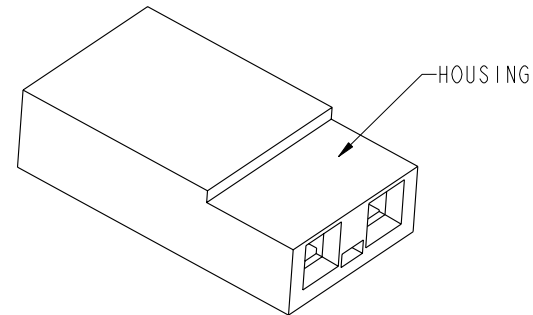

NOTE:

1. MATERIAL

HOUSING : 30% GLASS FILLED POLYESTER
FLAME RETARDANT PER UL 94V-0
COLOR : BLACK

2. TERMINAL : PHOSPHOR BRONZE

PLATING : REFER TO CHART

3. PRODUCT DESCRIPTION CODE:

XXXXX - XXXLF

LEAD FREE (SEE NOTE 4 & 6)
EXTENSION NUMBER
CONTACT AREA PLATING
BASE NUMBER

4. 71363-XXXLF IS THE SAME AS 71363-XXX.
SUFFIX 'LF' IS ADDED FOR EASY LEAD FREE IDENTIFICATION.

5. THE HOUSING WILL WITHSTAND EXPOSURE TO 200°C PEAK TEMPERATURE FOR 10 SECONDS IN A CONVECTION, INFRA-RED OR VAPOR PHASE REFLOW OVEN.

6. THIS PRODUCT MEETS EUROPEAN UNION DIRECTIVES AND OTHER COUNTRY REGULATIONS AS DESCRIBED IN GS-22-008.

7. A SYMBOL WILL BE NEXT TO ANY DIMENSION, VIEW OR NOTE WHICH HAS BEEN MODIFIED WITH THE CURRENT DRAWING REVISION.



Copyright FCI.

CONFIDENTIAL

www.fciconnect.com		surface - ✓ ISO 1302	tolerance std ISO 406 ISO 1101	projection 	MM
		TOLERANCES UNLESS OTHERWISE SPECIFIED			Scale 6:1
Dr	NH LWEE	1987-01-05	ANGULAR	0.X ±0.35	size A3
Eng	KB MAH	2004-10-08	LINEAR	0.XX ±0.25	Scale 6:1
Chr	KH LEE	2009-12-08	0° ±2°	0.XXX ±0.10	ECN S10-0204
Appr	JOEY NG	2009-12-08	Product family	JUMPER	Spec ref -
		title JUMPER		dwg no 71363	Rev. J
		HIGH BODY		CUSTOMER	sheet 1 of 1
		catalog no			

rev	ecn no	dr	date
E	S0160	NHL	1987-02-11
F	S04-0210	KBM	2004-10-08
G	S05-0082	KBM	2005-03-17
H	S06-0143	KHL	2006-04-27
J	S10-0204	SM	2009-12-08
-	-	-	-
-	-	-	-

REV I - 2006-04-17