

## Model 4296 Adapter, SMA Male To Type "N" Male

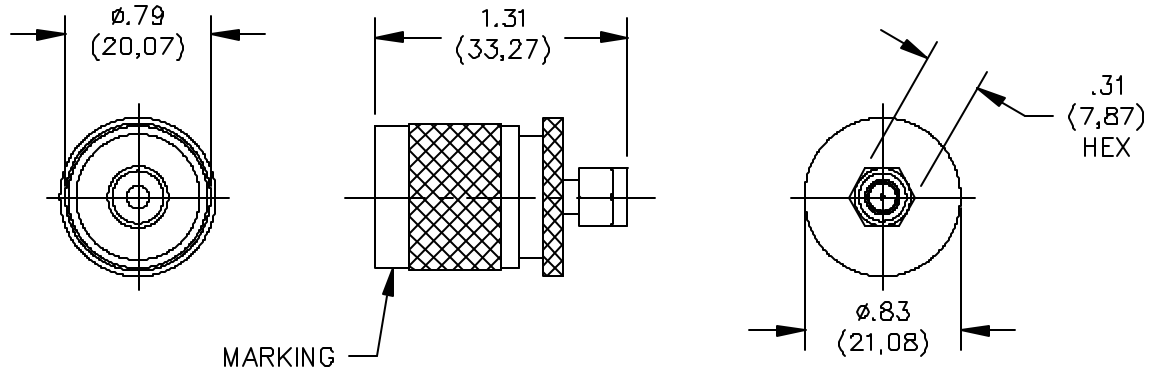

### MATERIALS:

Body – Gold Plated Beryllium Copper, Center Contact - Gold Plated Brass

Dielectric: Teflon

Finish: Body and Contacts – Gold plated

Marking: "Pomona 4296"

### RATINGS:

Voltage: Shield/Earth: 30VAC/60VDC Max.

Inner Conductor/Shield: 335VRMS Max.

Operating Temperature: -65°C (-85°F) to +165°C (+329°F)

Nominal Impedance: 50 Ohms

Frequency Range: 0-12.4 GHz.

### ORDERING INFORMATION: Model 4296

All dimensions are in inches and metric. All specifications are to the latest revisions. Specifications are subject to change without notice.  
Registered trademarks are the property of their respective companies. Made in USA

Sales: 800-490-2361 Fax: 888-403-3360  
Technical Assistance: 800-241-2060

PomonaACCESS 90253 (800) 444-6785 or (425) 446-6010  
More drawings available at [www.pomonaelectronics.com](http://www.pomonaelectronics.com)