

15 Amp - Rack Panel Mount (Rear Mounted Receptacles)

1583 Series



Key Features

- Designed for power distribution from the rear of the unit.
- With lighted on/off switch or red pilot light (see tables below) to indicate power on.
- Available in ASA 61 grey or black powder coat finish.
- Heavy 14 gauge wire cord - 14/3 SJT or SJTW for extreme temperature ranges and integral molded plug.
- Plug types available are NEMA 5-15P straight blade or NEMA L5-15P twist-lock (see table & pictures below).
- Includes 15 Amp, 125 VAC circuit breaker to prevent accidental overload.
- 6 outlet models include 2 outlets with extra spacing for clearance of most plug in transformers.
- Panel dimensions are 1.75" high (1U) and 19" width
- CSA certified, Standards C22.2 (No. 21-95 and No. 42-99)
- UL recognized, Standard UL1363
- Surge Protected models also available - please see the 1583 "S" models on [page 27](#)



Rack Mount Outlet Strips

Part No.	Color	Outlets	On-Off Switch	Cord Length	Plug Type
1583H6A1	ASA 61 Grey	6	Yes	6'	Straight
1583H6B1	ASA 61 Grey	6	Yes	15'	Straight
1583H6C1	ASA 61 Grey	6	Yes	6'	Twist-Lock
1583H6D1	ASA 61 Grey	6	Yes	15'	Twist-Lock
1583H6A1BK	Black	6	Yes	6'	Straight
1583H6B1BK	Black	6	Yes	15'	Straight
1583H6C1BK	Black	6	Yes	6'	Twist-Lock
1583H6D1BK	Black	6	Yes	15'	Twist-Lock
1583H8A1	ASA 61 Grey	8	Yes	6'	Straight
1583H8B1	ASA 61 Grey	8	Yes	15'	Straight
1583H8C1	ASA 61 Grey	8	Yes	6'	Twist-Lock
1583H8D1	ASA 61 Grey	8	Yes	15'	Twist-Lock
1583H8A1BK	Black	8	Yes	6'	Straight
1583H8B1BK	Black	8	Yes	15'	Straight
1583H8C1BK	Black	8	Yes	6'	Twist-Lock
1583H8D1BK	Black	8	Yes	15'	Twist-Lock
1583T6A1	ASA 61 Grey	6	No	6'	Straight
1583T6B1	ASA 61 Grey	6	No	15'	Straight
1583T6C1	ASA 61 Grey	6	No	6'	Twist-Lock
1583T6D1	ASA 61 Grey	6	No	15'	Twist-Lock
1583T6A1BK	Black	6	No	6'	Straight
1583T6B1BK	Black	6	No	15'	Straight
1583T6C1BK	Black	6	No	6'	Twist-Lock
1583T6D1BK	Black	6	No	15'	Twist-Lock
1583T8A1	ASA 61 Grey	8	No	6'	Straight
1583T8B1	ASA 61 Grey	8	No	15'	Straight
1583T8C1	ASA 61 Grey	8	No	6'	Twist-Lock
1583T8D1	ASA 61 Grey	8	No	15'	Twist-Lock
1583T8A1BK	Black	8	No	6'	Straight
1583T8B1BK	Black	8	No	15'	Straight
1583T8C1BK	Black	8	No	6'	Twist-Lock
1583T8D1BK	Black	8	No	15'	Twist-Lock

NOTES

MATERIAL - 20 GAUGE SHEET METAL (BACK)
 - 16 GAUGE SHEET METAL (FRONT)

-LIGHTED ON/OFF SWITCH, 15 AMP CIRCUIT BREAKER
 -6', 14 GAUGE WIRE CORD
 -ASA 61 GREY
 -CSA CERTIFIED
 -UL RECOGNIZED

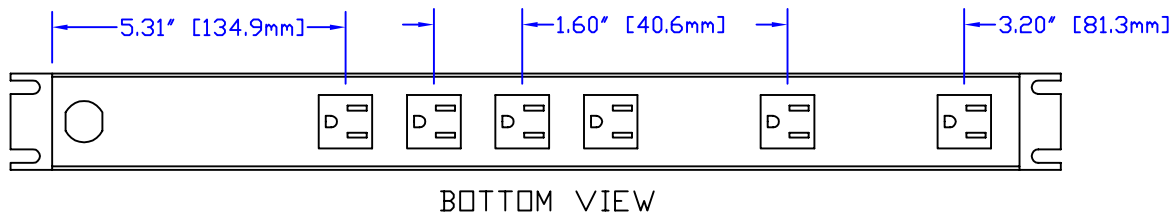
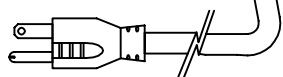
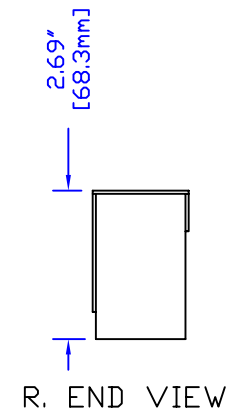
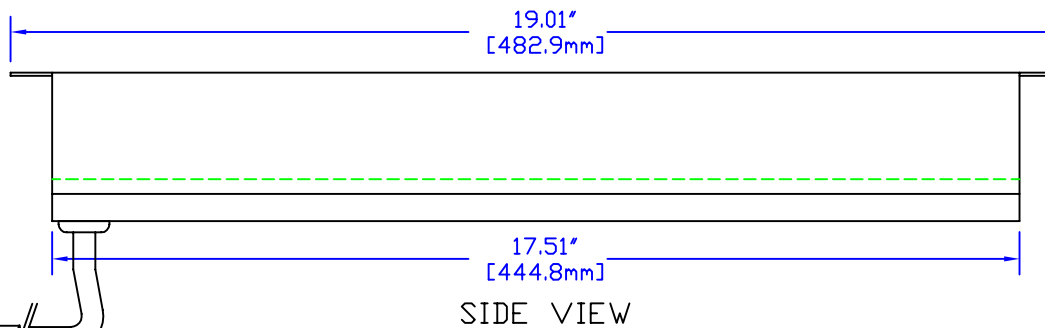
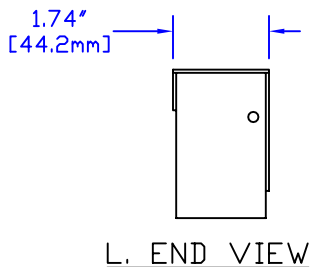
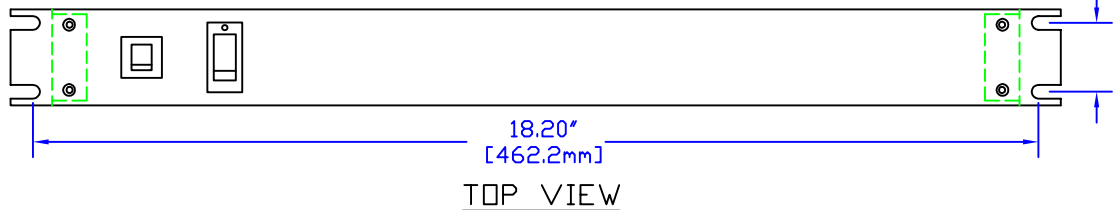
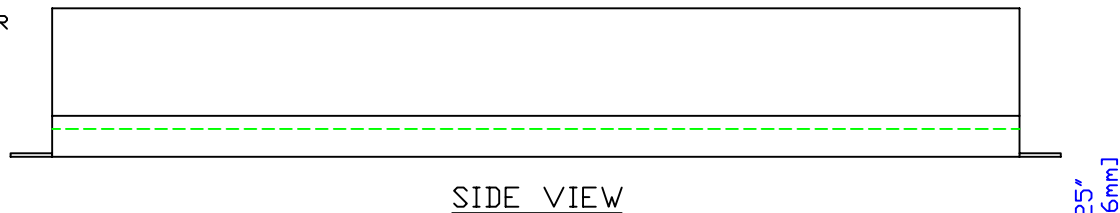

-ALSO AVAILABLE IN SATIN BLACK - #1583H6A1BK
 -ALSO AVAILABLE WITH 15' WIRE CORD - #1583H6B1, #1583H6B1BK
 -ALSO AVAILABLE WITH 6' TWIST LOCK CORD - #1583H6C1, #1583H6C1BK
 -ALSO AVAILABLE WITH 15' TWIST LOCK CORD - #1583H6D1, #1583H6D1BK
 -ALSO AVAILABLE WITH SURGE PROTECTION - #1583H6A1S, #1583H6A1SBK, 1583H6B1S, 1583H6B1SBK

- FOR ANY MODIFICATIONS PLEASE PHONE OR FAX FOR AN IMMEDIATE QUOTATION.



HAMMOND MANUFACTURING

1583H6A1