

Part Number **HSR-069R** Contact Form A Switch Configuration SPST Rev. H

### Extremely Durable Reed Switch

Features	Advantages
<ul style="list-style-type: none"> <li>• Hermetically sealed contacts</li> <li>• Optimal glass size to wire ratio</li> <li>• Center gap construction</li> <li>• Switch materials are Lead free and RoHS compliant</li> </ul>	<ul style="list-style-type: none"> <li>• Extended operations in extreme environments</li> <li>• Not ESD sensitive</li> <li>• Outstanding durability</li> <li>• Highly shock/vibration resistant</li> </ul>

### Electrical Specifications

Power		Watts - maximum	4
Voltage	Switching	VDC - maximum	30
	Breakdown	VDC - minimum	300
Current	Switching	Amp - maximum	0.2
	Carry	Amp - maximum	1.4
Resistance	Initial Contact Resistance	Ohm - maximum	0.20
	Insulation Resistance	Ohm - minimum	1 E10
Capacitance	Contact	pF - typical	0.2
Temperature	Operating	°C	-40 to +125
	Storage	°C	-40 to +200

### Magnetic Specifications

Pull - In Range		Ampere Turns	10-35
Test Coil		NARM RS-421-A	Coil I

### Physical/Operational Specifications

Capsule Volume	Excluding Leads	CC - nominal	0.07
Contact Material			Rhodium
Operate Time	Including Bounce	mSeconds - maximum	0.50
Release Time	Including Bounce	mSeconds - maximum	0.10

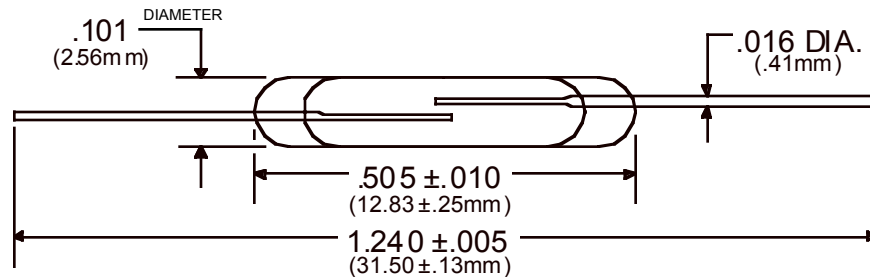
**Notes:**

- (1) Specifications are not constant across entire magnetic range.
- (2) Customer must exercise care in handling, mounting, lead forming, and cutting to prevent damage to glass capsule and/or switch sensitivity.
- (3) For information or custom configurations about performance, mounting options or packaging, contact our Sales department.
- (4) Information contained hereon is for informational purposes only and should not be deemed as accurate for a specific application. Consult factory for specific application information and/or latest revision.