

Panasonic
ideas for life

HIGH ELECTRICAL & MECHANICAL NOISE IMMUNITY RELAY

JQ RELAYS

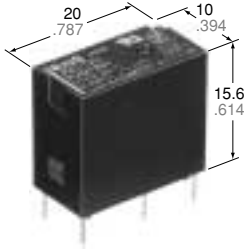

mm inch

FEATURES

- High electrical noise immunity
- High switching capacity in a compact package
- High sensitivity: 200 mW (1a), 400 mW (1c)
- High surge voltage: 8,000 V between contacts and coil
- UL, CSA, VDE, TÜV, SEMKO approved
- Class B coil insulation type available

SPECIFICATIONS

Contact

		Standard type	High capacity type		
Arrangement		1 Form A, 1 Form C			
Initial contact resistance, max. (By voltage drop 6 V DC 1 A)		100 mΩ			
Contact material		Silver alloy			
Rating (resistive)	Nominal switching capacity	1a	5 A 125 V AC 2 A 250 V AC 5 A 30 V DC	10 A 125 V AC 5 A 250 V AC 5 A 30 V DC	
		1c	N.O.	5 A 125 V AC 2 A 250 V AC 3 A 30 V AC	10 A 125 V AC 5 A 250 V AC 5 A 30 V DC
			N.C.	2 A 125 V AC 1 A 250 V AC 1 A 30 V DC	3 A 125 V AC 2 A 250 V AC 1 A 30 V DC
			1a	625 VA, 150 W	1,250 VA, 150 W
		Max. switching power	1c	N.O.: 625 VA, 90 W N.C.: 250 VA, 30 W	1,250 V AC, 150 W 500 V AC, 30 W
			Max. switching voltage		250 V AC, 110 V DC (0.3A)
	Max. switching current		N.O.: 5 A N.C.: 2 A N.O.: 10 A N.C.: 3 A		
	Min. switching capacity#1		100 mA, 5 V DC		
	Expected mechanical life (at 180 cpm)(min. operations)		10 ⁷		

Expected electrical life (min. operations)

Type		Switching capacity	No. of operations	
Standard type	1a	5 A 125 V AC	5×10 ⁴	
		3 A 125 V AC	2×10 ⁵	
		2 A 250 V AC	2×10 ⁵	
		5 A 30 V DC	10 ⁵	
	1c	N.O.	5 A 125 V AC 2 A 250 V AC 3 A 30 V DC	5×10 ⁴ 2×10 ⁵ 10 ⁵
		N.C.	2 A 125 V AC 1 A 250 V AC 1 A 30 V DC	2×10 ⁵ 2×10 ⁵ 10 ⁵
High capacity type	1a	10 A 125 V AC	5×10 ⁴	
		5 A 250 V AC	5×10 ⁴	
		5 A 30 V DC	10 ⁵	
	1c	N.O.	10 A 125 V AC 5 A 250 V AC 5 A 30 V DC	5×10 ⁴ 5×10 ⁴ 10 ⁵
		N.C.	3 A 125 V AC	2×10 ⁵
			2 A 250 V AC 1 A 30 V DC	2×10 ⁵ 10 ⁵

Coil (at 20°C 68°F)

Nominal operating power	1a: 200 mW	1c: 400 mW
-------------------------	------------	------------

Characteristics

Max. operating speed		20 cpm
Initial insulation resistance*1		Min. 1,000 MΩ at 500 V DC
Initial breakdown voltage*2	Between open contacts	1a: 1,000 Vrms for 1 min. 1c: 750 Vrms for 1 min.
	Between contacts and coil	4,000 Vrms for 1 min.
Surge voltage between contact and coil*3		8,000 V
Operate time*4 (at nominal voltage)		Approx. 5 ms
Release time*4 (at nominal voltage)(without diode)		Approx. 2 ms
Temperature rise*5		Max. 45°C
Shock resistance	Functional*6	Min. 294 m/s ² {30 G}
	Destructive*7	Min. 980 m/s ² {100 G}
Vibration resistance	Functional*8	98 m/s ² {10 G}, 10 to 55 Hz at double amplitude of 1.6 mm
	Destructive	117.6 m/s ² {12 G}, 10 to 55 Hz at double amplitude of 2.0 mm
Conditions for operation, transport and storage*9 (Not freezing and condensing at low temperature)		Ambient temp.*10
		Humidity
Unit weight		Approx. 7 g .25 oz

#1 This value can change due to the switching frequency, environmental conditions, and desired reliability level, therefore it is recommended to check this with the actual load.

Remarks

- * Specifications will vary with foreign standards certification ratings.
- *1 Measurement at same location as "Initial breakdown voltage" section
- *2 Detection current: 10 mA
- *3 Wave is standard shock voltage of ±1.2 × 50μs according to JEC-212-1981
- *4 Excluding contact bounce time
- *5 Measured conditions

Standard type	Resistive, nominal voltage applied to the coil. Contact carrying current: 5 A, at 70°C 158°F
High capacity type	Resistive, nominal voltage applied to the coil. Contact carrying current: 10 A, at 70°C 158°F

- *6 Half-wave pulse of sine wave: 11ms; detection time: 10μs
- *7 Half-wave pulse of sine wave: 6ms
- *8 Detection time: 10μs
- *9 Refer to 6. Conditions for operation, transport and storage mentioned in AMBIENT ENVIRONMENT
- *10 When using relays in a high ambient temperature, consider the pick-up voltage rise due to the high temperature (a rise of approx. 0.4% V for each 1°C 33.8°F with 20°C 68°F as a reference) and use a coil impressed voltage that is within the maximum allowable voltage range.

TYPICAL APPLICATIONS

- Air conditioners
- Refrigerators
- Microwave ovens
- Heaters

ORDERING INFORMATION

Ex. JQ 1a P — B — 12 V — F

Contact arrangement	Contact capacity	Coil insulation class	Coil voltage (DC)	Environmental support
1a: 1 Form A 1: 1 Form C	Nil: Standard P: High capacity	Nil: Class E coil insulation B: Class B coil insulation	5, 6, 9, 12, 18, 24, 48* V	F: RoHS Directive conforming type (AgSnO ₂ type) Nil: RoHS Directive non-conforming type (AgCdO type)

UL/CSA, VDE, SEMKO approved type is standard.

* Available only for 1 Form C type

TYPES AND COIL DATA at 20°C 68°F

	Part No.	Nominal voltage, V DC	Pick-up voltage, V DC (min.)	Drop-out voltage, V DC (min.)	Nominal operating current, mA	Nominal operating power, mW	Coil resistance, Ω (±10%)	Max. allowable voltage, V DC	
1 Form A	Standard type	JQ1a-5V (-F)	5	3.75	0.25	40	200	180% of nominal voltage (at 20°C 68°F)	
		JQ1a-6V (-F)	6	4.5	0.3				125
		JQ1a-9V (-F)	9	6.75	0.45				180
		JQ1a-12V (-F)	12	9	0.6				405
		JQ1a-18V (-F)	18	13.5	0.9				720
		JQ1a-24V (-F)	24	18	1.2				1,620
	High capacity type	JQ1aP-5V (-F)	5	4	0.25	40	200	130% of nominal voltage (at 85°C 185°F)	
		JQ1aP-6V (-F)	6	4.8	0.3				125
		JQ1aP-9V (-F)	9	7.2	0.45				180
		JQ1aP-12V (-F)	12	9.6	0.6				405
		JQ1aP-18V (-F)	18	14.4	0.9				720
		JQ1aP-24V (-F)	24	19.2	1.2				1,620
1 Form C	Standard type	JQ1-5V (-F)	5	3.75	0.25	80	400	150% of nominal voltage (at 20°C 68°F)	
		JQ1-6V (-F)	6	4.5	0.3				62.5
		JQ1-9V (-F)	9	6.75	0.45				90
		JQ1-12V (-F)	12	9	0.6				202.5
		JQ1-18V (-F)	18	13.5	0.9				360
		JQ1-24V (-F)	24	18	1.2				810
		JQ1-48V (-F)	48	36	2.4				1,440
	High capacity type	JQ1P-5V (-F)	5	4	0.25	80	400	110% of nominal voltage (at 85°C 185°F)	
		JQ1P-6V (-F)	6	4.8	0.3				62.5
		JQ1P-9V (-F)	9	7.2	0.45				90
		JQ1P-12V (-F)	12	9.6	0.6				202.5
		JQ1P-18V (-F)	18	14.4	0.9				360
		JQ1P-24V (-F)	24	19.2	1.2				810
		JQ1P-48V (-F)	48	38.4	2.4				1,440

DIMENSIONS

mm inch



1 Form A

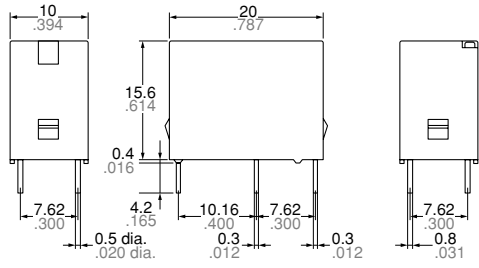

1 Form A



Schematic (Bottom view)

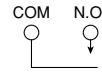

1 Form C

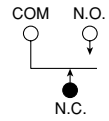

1 Form C

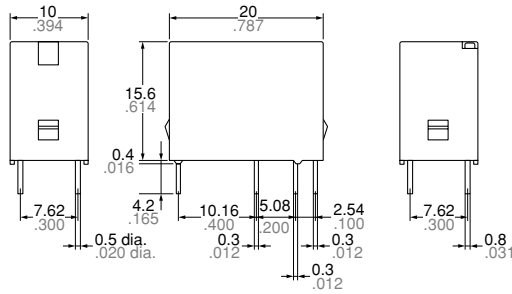

1 Form A

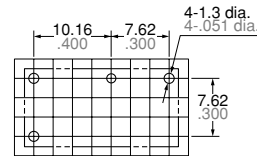

1 Form C

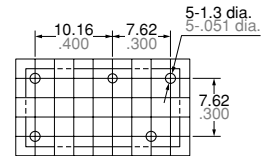

Tolerance: $\pm 0.1 \pm 0.04$

Dimension :	General tolerance
Max. 1mm .039 inch	$\pm 0.2 \pm 0.08$
1 to 5mm .039 to .118 inch	$\pm 0.3 \pm 0.12$
Min. 5mm .118 inch	$\pm 0.4 \pm 0.16$

REFERENCE DATA

Max. switching capacity (1 Form A type)

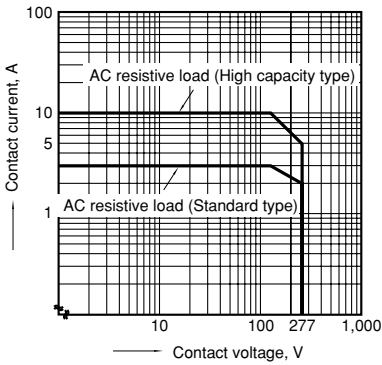

Max. switching capacity (1 Form C type)

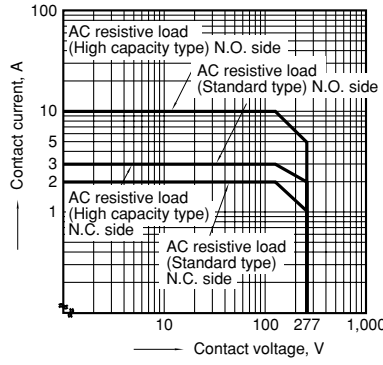

Standard type

1-(1). Operate & release time (1 Form A type)
Tested sample: JQ1a-12V, 25 pcs.

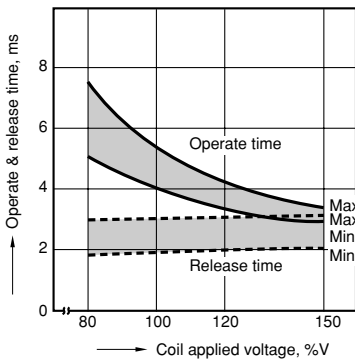

1-(2). Operate & release time (1 Form C type)
Tested sample: JQ1-24V, 25 pcs.

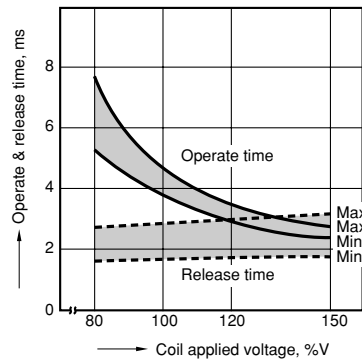

2. Life curve
Ambient temperature: room temperature

